

◎ Pro

- Stand
- Protec
- Ratec
- Very I
- Indica
- RoHS

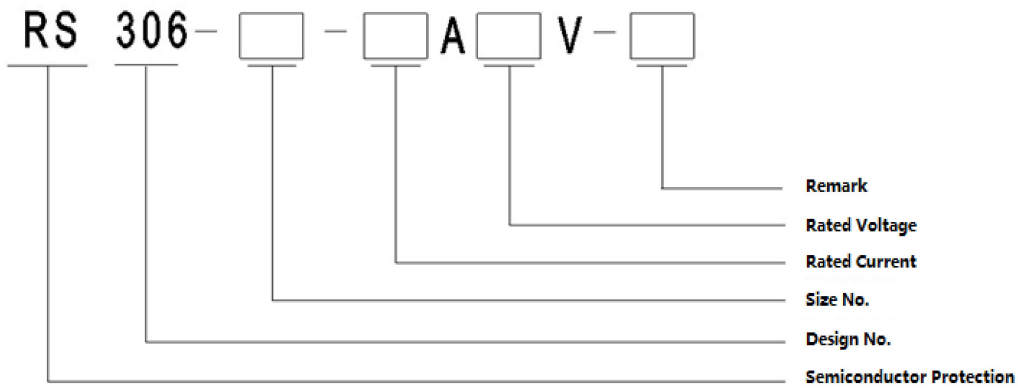

©



Example: RS306-1-S2P-800A690V-N---Size 1-S2P, Current 800A, Voltage 690V, No indication



# RS306 High Speed Fuse for Semiconductor Protection

中熔电气  
ZHONGYUAN ELECTRIC

at End - Catalogue

Size No	Dimension (mm)						Voltage (VAC)	Interrupt (kA)	Rated Current (A)		
	B	C	D	E	F	H					
01-S1P	51±1.5	43	59	Φ17	M8	6	250 500 690	≥200	20,25,32,40,50,63,80,100,125,160,200,250,315,350,400,450,500,550,630		
1-S1P	51±1.5	51	69	Φ20	M8	9			200,250,315,350,400,450,500,550,630,700,800		
2-S1P	51±1.5	60	77	Φ24.5	M10	10			400,450,500,550,630,700,800,900,1000,1100,1250		
3-S1P	52±1.5	74	92	Φ30	M12	11			500,550,630,700,800,900,1000,1100,1250,1400,1600		
4-S1P	60±1.5	85	102	Φ53.5	M12	11			1100,1250,1400,1600,1800,2000,2200		
5-S1P	60±1.5	105	122	Φ70	M16	14			1250,1400,1600,1800,2000,2200,2500,2800,3000		
1-M1P	56±1.5	51	69	Φ20	M8	9	250 500 690		200,250,315,350,400,450,500,550,630,700,800		
2-M1P	56±1.5	60	77	Φ24.5	M10	10			400,450,500,550,630,700,800,900,1000,1100,1250		
3-M1P	57±1.5	74	92	Φ30	M10	11			500,550,630,700,800,900,1000,1100,1250,1400,1600		
2-Y1P	65	60	77	Φ24.5	M10	10	690		400,450,500,550,630,700,800,900,1000,1100,1250		
3-Y1P	65	74	92	Φ30	M12	11			500,550,630,700,800,900,1000,1100,1250,1400,1600		
74.5 <sup>+1.5</sup> <sub>-0.5</sub>	01-S2P		43	59	Φ17	M8	6		690	20,25,32,40,50,63,80,100,125,160,200,250,315,350,400,450,500,550,630	
									1000	≥100	20,25,32,40,50,63,80,100,125,160,200,250,315,350,400
									1250	≥80	20,25,32,40,50,63,80,100,125,160,200,250,315,350,400
74.5 <sup>+1.5</sup> <sub>-0.5</sub>	1-S2P		51	69	Φ20	M8	9		690	≥200	200,250,315,350,400,450,500,550,630,700,800
									1000	≥100	160,200,250,315,350,400,450,500,550,630
									1250	≥80	125,160,200,250,315,350,400,450,500,550,630
75.5 <sup>+1.5</sup> <sub>-0.5</sub>	2-S2P		60	77	Φ24.5	M10	10		690	≥200	315,350,400,450,500,550,630,700,800,900,1000,1100,1250
									1000	≥100	250,315,350,400,450,500,550,630,700,800,900,1000
									1250	≥80	250,315,350,400,450,500,550,630,700,800,900
	3-S2P		74	92	Φ30	M12	11		690	≥200	500,550,630,700,800,900,1000,1100,1250,1400,1500,1600
									1000	≥100	315,350,400,450,500,550,630,700,800,900,1000,1100,1250
									1250	≥80	315,350,400,450,500,550,630,700,800,900,1000



at End - Catalogue

Size No	Dimension (mm)						Voltage (VAC)	Interrupt (kA)	Rated Current (A)
	B	C	D	E	F	H			
4-S4P	80±1.5	85	102	Φ53.5	M12	11	800	1100,1250,1400,1600,1800,2000,2200	
							1000	1000,1100,1250,1400,1600,1800,2000	
5-S4P	80±1.5	105	122	Φ70	M16	14	800	1250,1400,1600,1800,2000,2200,2500,2800	
							1000	1100,1250,1400,1600,1800,2000,2200,2500	
01-S5P	81±1.5	43	59	Φ17	M8	6	1250	20,25,32,40,50,63,80,100,125,160,200,250,315,350,400	
1-S5P	81±1.5	51	69	Φ20	M8	9	1250	125,160,200,250,315, 350,400,450,500,550	
2-S5P	81±1.5	60	77	Φ24.5	M10	10	1250	250,315,350,400,450,500,550,630,700,800	
3-S5P	82±1.5	74	92	Φ30	M12	11	1250	315,350,400,450,500,550,630,700,800,900,1000,1100	
4-S5P	90±1.5	85	102	Φ53.5	M12	11	1250	800,900,1000,1100,1250,1400,1600	
5-S5P	90±1.5	105	122	Φ70	M16	14	1250	1100,1250,1400,1600,1800,2000,2200	
1-M5P	86±1.5	51	69	Φ20	M8	9	1250	125,160,200,250,315, 350,400,450,500,550	
2-M5P	86±1.5	60	77	Φ24.5	M10	10	1250	250,315,350,400,450,500,550,630,700,800	
3-M5P	87±1.5	74	92	Φ30	M10	11	1250	315,350,400,450,500,550,630,700,800,900,1000,1100	
2-J5P	91±1.5	60	77	Φ24.5	M10	10	1250	250,315,350,400,450,500,550,630,700,800	
3-J5P	91±1.5	74	92	Φ30	M12	11	1250	315,350,400,450,500,550,630,700,800,900,1000,1100	
3-S6P	90±1.5	74	90	Φ30	M12	11	1250	315,350,400,450,500,550,630,700,800,900,1000,1100,1250	
4-S6P	100±1.5	85	102	Φ53.5	M12	11	1250	800,900,1000,1100,1250,1400,1600	
5-S6P	100±1.5	105	122	Φ70	M16	14	1250	1100,1250,1400,1600,1800,2000,2200	
6-S6P	100±1.5	120	137	Φ84	M16	15	1250	1400,1600,1800,2000,2200,2500,2800	
3-S7P	102±2	74	92	Φ30	M12	11	1500	315,350,400,450,500,550,630,700,800,900	
5-S7P	110±2	105	122	Φ70	M16	14	1500	1000,1100,1250,1400,1600,1800,2000	





## RS306 High Speed Fuse for Semiconductor Protection

### Single Socket Flat End Structure - Catalogue

**中熔电气**  
ZHONGRONG DIANJI

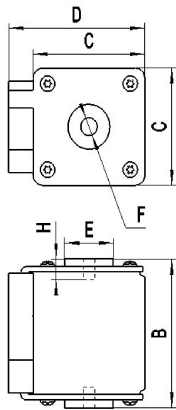

Size No	Dimension (mm)						Voltage (VAC)	Interrupt (kA)	Rated Current (A)
	B	C	D	E	F	H			
1-M9P	128±2	51	69	Φ20	M8	9	1500	≥50	20,25,32,40,50,63,80,100,110,125,160,200,250,315,350,400
							2000		20,25,32,40,50,63,80,100,110,125,160,200,250,315,350
2-M9P	128±2	60	77	Φ24.5	M10	10	1500	≥50	160,200,250,315,350,400,450,500,550,630
							2000		160,200,250,315,350,400,450,500
3-M9P	129±2	74	92	Φ30	M10	11	1500	≥50	200,250,315,350,400,450,500,550,630,700,800,900
							2000		315,350,400,450,500,550,630,700,800
4-S8P	130±2	85	102	Φ53.5	M12	11	1500	≥50	400,450,500,550,630,700,800,900,1000,1100,1250
							2000		500,550,630,700,800,900,1000
5-S8P	130±2	105	122	Φ70	M16	14	1500	≥50	1000,1100,1250,1400,1600,1800,2000
							2000		800,900,1000,1100,1250,1400,1600
1-S9P	123±2	51	69	Φ20	M8	9	1500	≥50	20,25,32,40,50,63,80,100,110,125,160,200,250,315,350
							2000		20,25,32,40,50,63,80,100,110,125,160,200,250,315
2-S9P	123±2	60	77	Φ24.5	M10	10	1500	≥50	200,250,315,350,400,450,500,550,630
							2000		200,250,315,350,400,450,500
3-S9P	124±2	74	92	Φ30	M12	11	1500	≥50	315,350,400,450,500,550,630,700,800,900
							2000		315,350,400,450,500,550,630,700,800
3-SAP	142±2	74	92	Φ30	M12	11	2000	≥50	160,200,250,315,350,400,450,500,550,630,700,800
							2500		100,125,160,200,250,315,350,400,450,500,550,630

**Remark:** N-no indication; Default base indication

K-with additional switch





## RS306 High Speed Fuse for Semiconductor Protection

### Double-Socket Flat End - 1st Type Indication Catalogue

Scheme	Size No	Dimension (mm)						Voltage (VAC)	Interrupt (kA)	Rated Current (A)	
		B	C	D	E	F	H				
	3-D1P	57±1.5	74	92	30	M10	10	250	≥200	500,550,630,700,800,900,1000,1100,1250,1400,1600	
	4-D1P	60±1.5	85	102	30	M10	10	500	≥100	1100,1250,1400,1600,1800,2000,2200	
	5-D1P	60±1.5	105	122	40	M12	12	690		1250,1400,1600,1800,2000,2200,2500,2800,3000	
	3-D4P	77±1.5	74	92	30	M10	10	800	≥100	630,700,800,900,1000,1100,1250,1400	
								1000		500,630,700,800,900,1000,1100	
	4-D4P	80±1.5	85	102	30	M10	10	800		1100,1250,1400,1600,1800,2000	
								1000		1000,1100,1250,1400,1600,1800	
	5-D4P	80±1.5	105	122	40	M12	12	800		1250,1400,1600,1800,2000,2200,2500,2800	
								1000		1100,1250,1400,1600,1800,2000,2200,2500	
	3-D5P	87±1.5	74	92	30	M10	10	1000		≥100	400,450,500,550,630,700,800,900,1000
								1250		≥80	315,350,400,450,500,550,630,700,800,900
	4-D5P	90±1.5	85	102	30	M10	10	1000		≥100	800,900,1000,1100,1250,1400,1600,1800
								1250		≥80	800,900,1000,1100,1250,1400,1600
	5-D5P	90±1.5	105	122	40	M12	12	1000	≥100	1100,1250,1400,1600,1800,2000,2200,2400,2500,2800	
								1250	≥80	1100,1250,1400,1600,1800,2000,2200	
	3-D6P	95±1.5	74	92	30	M10	10	1250	≥100	315,350,400,450,500,550,630,700,800,900	
								1500		315,350,400,450,500,550,630	
	5-D6P	100±1.5	105	122	40	M12	12	1250		≥80	1100,1250,1400,1600,1800,2000,2200
	3-D7P	107±2	74	92	30	M10	10	1500		≥70	250,315,350,400,450,500,550,630
	5-D7P	110±2	105	122	40	M12	12	1500			800,900,1000,1100,1250,1400,1600,1800
3-D9P	129±2	74	92	30	M10	10	1500	≥70		200,250,315,350,400,450,500	
							2000	≥50		100,125,160,200,250,315,350,400	
4-D8P	130±2	85	102	30	M10	10	1500	≥70		630,800,900,1000,1100,1250,1400	
							2000	≥50		200,250,315,350,400,450,500,550,630	
5-D8P	130±2	105	122	40	M12	12	1500	≥70		1000,1100,1250,1400,1600,1800,2000	
							2000	≥50	800,900,1000,1100,1250,1400,1600		

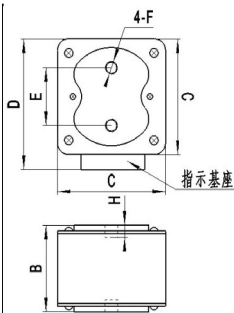



# RS306 High Speed Fuse for Semiconductor Protection

## Double-Socket Flat End - 1st Type Indication Catalogue

Scheme	Size No	Dimension (mm)						Voltage (VAC)	Interrupt (kA)	Rated Current (A)
		B	C	D	E	F	H			
See Below	3-DAP	147±2	74	92	30	M10	10	2000	≥50	315,350,400,450,500,550,630,700
								2500	≥50	200,250,315,350,400,450,500,550,630
	3-DBP	167±2	74	92	30	M10	10	2500	≥50	160,200,250,315,350,400,450,500,550,630
	3-DCP	187±2	74	92	30	M10	10	2500	≥50	100,125,160,200,250,315,350,400,450,500,550
								3000	≥50	125,160,200,250,315,350,400,450,500
	3-DHP	222±2	74	92	30	M10	10	3000	≥50	160,200,250,315,350,400,450,500,630
								3500	≥50	100,125,160,200,250,315,350,400,450,500
								4000	≥50	100,125,160,200,250,315,350,400

Remark: N-no indication; Defa   
 K-with additional switch  
 Note: indication is in two dire

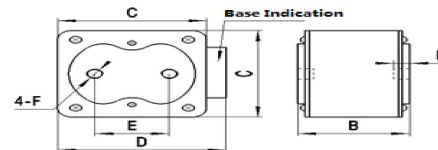



## RS306 High Speed Fuse for Semiconductor Protection

### Double-Socket Flat End - 2nd Type Indication Catalogue

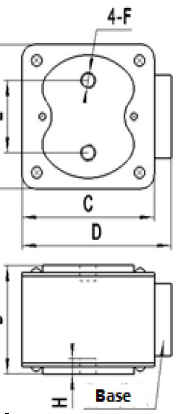
Scheme	Size No	Dimension (mm)						Voltage (VAC)	Interrupt (kA)	Rated Current (A)
		B	C	D	E	F	H			
 <p style="text-align: center;"><b>中熔电气</b> ZHONGRONG DIANJI</p>	3-D1V	57±1.5	74	92	30	M10	10	250	≥200	500,550,630,700,800,900,1000,1100,1250,1400,1600
	4-D1V	60±1.5	85	102	40	M10	10	500	≥100	1100,1250,1400,1600,1800,2000,2200
	5-D1V	60±1.5	105	122	40	M12	12	690	≥100	1250,1400,1600,1800,2000,2200,2500,2800,3000
	3-D4V	77±1.5	74	92	30	M10	10	800	≥100	630,700,800,900,1000,1100,1250,1400
								1000		500,630,700,800,900,1000,1100
	4-D4V	80±1.5	85	102	30	M10	10	800	≥100	1100,1250,1400,1600,1800,2000
								1000		1000,1100,1250,1400,1600,1800
	5-D4V	80±1.5	105	122	40	M12	12	800	≥100	1250,1400,1600,1800,2000,2200,2500,2800
								1000		1100,1250,1400,1600,1800,2000,2200,2500
	3-D5V	87±1.5	74	92	30	M10	10	1000	≥100	400,450,500,550,630,700,800,900,1000
								1250	≥80	315,350,400,450,500,550,630,700,800,900
	4-D5V	90±1.5	85	102	30	M10	10	1000	≥100	800,900,1000,1100,1250,1400,1600,1800
								1250	≥80	800,900,1000,1100,1250,1400,1600
	5-D5V	90±1.5	105	122	40	M12	12	1000	≥100	1100,1250,1400,1600,1800,2000,2200,2400,2500,2800
								1250	≥80	1100,1250,1400,1600,1800,2000,2200
	3-D6V	95±1.5	74	92	30	M10	10	1250	≥100	315,350,400,450,500,550,630,700,800,900
								1500		315,350,400,450,500,550,630
	5-D6V	100±1.5	105	122	40	M12	12	1250	≥80	1100,1250,1400,1600,1800,2000,2200
	3-D7V	107±2	74	92	30	M10	10	1500	≥70	250,315,350,400,450,500,550,630
	5-D7V	110±2	105	122	40	M12	12	1500		800,900,1000,1100,1250,1400,1600,1800
3-D9V	129±2	74	92	30	M10	10	1500	≥70	200,250,315,350,400,450,500	
							2000	≥50	100,125,160,200,250,315,350,400	
4-D8V	130±2	85	102	30	M10	10	1500	≥70	630,800,900,1000,1100,1250,1400	
							2000	≥50	200,250,315,350,400,450,500,550,630	
5-D8V	130±2	105	122	40	M12	12	1500	≥70	1000,1100,1250,1400,1600,1800,2000	
							2000	≥50	800,900,1000,1100,1250,1400,1600	





# RS306 High Speed Fuse for Semiconductor Protection

## Quadruple Socket Flat End - Catalogue

中熔电气  
ZHONGRONG DIANDI

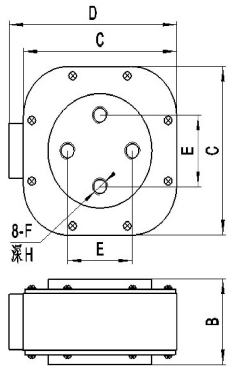

Size No	Dimension (mm)						Voltage (VAC)	Interrupt (kA)	Rated Current (A)
	B	C	D	E	F	H			
5-X1P	60±1.5	105	122	33	M10	12	250	≥100	1800,2000,2200,2500,2800,3000,3200,3400,3600,3800
							500		1600,1800,2000,2200,2500,2800,3000,3200,3400
							690		1400,1600,1800,2000,2200,2500,2800,3000
6-X1P	60±1.5	120	137	50	M12	12	250	≥100	2200,2500,2800,3000,3200,3400,3600,3800,4000,4200,4400
							500		2000,2200,2500,2800,3000,3200,3400,3600,3800,4000,4200
							690		1800,2000,2200,2500,2800,3000,3200,3400,3600,3800,4000
5-E1P	67±1.5	105	122	33	M10	10	690	≥100	1400,1600,1800,2000,2200,2500,2800,3000
XKP	60±1.5	135	152	60	M12	10	690	≥100	2200,2500,2800,3000,3200,3400,3600,3800,4000,4200,4400,4500
5-X4P	80±1.5	105	122	33	M10	12	800	≥100	1250,1400,1600,1800,2000,2200,2500,2800
							1000		1100,1250,1400,1600,1800,2000,2200,2500
6-X4P	80±1.5	120	137	50	M12	12	800	≥100	1600,1800,2000,2200,2500,2800,3000,3200,3400,3600
							1000		1400,1600,1800,2000,2200,2500,2800,3000,3200,3400
5-X5P	90±1.5	105	122	33	M10	12	1000	≥100	1100,1250,1400,1600,1800,2000,2200,2500,2800
							1250	≥80	1000,1100,1250,1400,1600,1800,2000,2200
6-X5P	90±1.5	120	137	50	M12	12	1000	≥100	1600,1800,2000,2200,2500,2800,3000,3200,3400
							1250	≥80	1250,1400,1600,1800,2000,2200,2500,2800,3000
5-X6P	100±1.5	105	122	33	M10	12	1250	≥80	1100,1250,1400,1600,1800,2000,2200
6-X6P	100±1.5	120	137	50	M12	12	1250	≥80	1250,1400,1600,1800,2000,2200,2500,2800,3000,3200
5-W7P	106.6±2	105	122	33	M10	12	1250	≥80	1000,1100,1250,1400,1600,1800,2000,2200
							1500	≥70	1000,1100,1250,1400,1600,1800,2000
5-X7P	110±2	105	122	33	M10	12	1500	≥70	1000,1100,1250,1400,1600,1800
6-X7P	110±2	120	137	50	M12	12	1500		1250,1400,1600,1800,2000,2200,2500,2800
5-X8P	130±2	105	122	33	M10	12	1500	≥70	1000,1100,1250,1400,1600,1800,2000
							2000	≥50	700,800,900,1000,1100,1250,1400,1600
6-X8P	130±2	120	137	50	M12	12	1500	≥70	1250,1400,1600,1800,2000,2200,2500,2800,3000
							2000	≥50	1100,1250,1400,1600,1800,2000,2200,2500
5-XAP	150±2	105	122	33	M10	12	2500	≥50	630,700,800,900,1000,1100,1250

Remark: N-no indication; Default base indication

K-with additional switch



# RS306 High Speed Fuse for Semiconductor Protection

## Quintuple Socket Flat End - Catalogue

Scheme	Size No	Dimension (mm)						Voltage (VAC)	Interrupt (kA)	Rated Current (A)
		B	C	D	E	F	H			
	7-U1P	60±1.5	150	167	62.5	M12	12	250	≥200	4000,4200,4500,4800,5000,5500,6000,6500,6800,7200,7500,8000
								380		4000,4200,4500,4800,5000,5500,6000,6500,6800,7200
								500		3600,4000,4200,4500,4800,5000,5500,6000,6300
								690		3200,3600,3800,4000,4200,4500,4800,5000
	7-U4P	80±1.5	150	167	62.5	M12	12	690	≥200	3200,3600,3800,4000,4200,4500,4800,5000,5200,5500,6000
								800		3000,3200,3400,3600,3800,4000,4200,4500,4800,5000,5500
	7-U5P	90±1.5	150	167	62.5	M12	12	690	≥200	4000,4200,4500,4800,5000,5500,6000,6300
								800		3600,4000,4200,4500,4800,5000,5500,6000
								1000		3200,3600,4000,4200,4500,4800
	7-U6P	100±1.5	150	167	62.5	M12	12	1000	≥200	3000,3200,3400,3600,3800,4000,4200,4500,5000
								1250		2500,2800,3000,3200,3400,3600,3800,4000

Remark: N-no indication; Default base indication

K-with additional switch

中熔电气  
ZHONGLU ELECTRIC

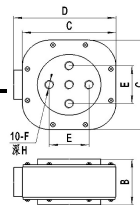

## Double Socket Single Plate Structure - 2nd Type Indication

Scheme	Size No	Dimension (mm)						Voltage (VAC)	Interrupt (kA)	Rated Current (A)
		A	B	C	D	E	H			
See Below	3-H1V	62±1.5	30	74	92	M10	11	690	≥100	800,900,1000,1100,1250,1400,1600
	3-HKV	74±1.5	30	74	92	M10	11	800	≥100	800,900,1000,1100,1250,1400
	3-H3V	87±1.5	30	74	92	M10	11	1000	≥100	700,800,900,1000,1100,1250
	3-H5V	94±1.5	30	74	92	M10	11	1250	≥80	500,550,630,700,800,900,1000
	3-H8V	132±1.5	30	74	92	M10	11	1500	≥70	200,250,315,350,400,450,500
2000								≥50	160,200,250,315,350,400	

**Remark:** N-no indication; Default base indication

K-with additional switch

**中熔电气**  
ZHONGRONG DIANJI

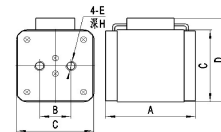

### Double Socket Single Plate Structure - Catalogue

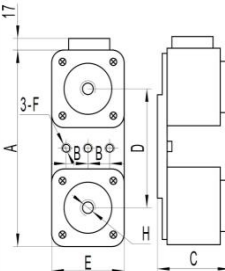
Scheme	Size No	Dimension (mm)							Voltage (VAC)	Interrupt (kA)	Rated Current (A)
		A	B	C	D	E	F	H			
	5-H1P1	245	31	60±1.5	140±0.5	105	Φ14	M16	690	≥200	3200,3400,3600,3800,4000,4400,4800,5000,5500,5800
	6-H1P1	292	40	60±1.5	169±0.5	120	Φ17	M16			3600,4000,4500,5000,5500,6000,6400,6800,7200
	5-H4P1	245	31	80±1.5	140±0.5	105	Φ14	M16	800	≥200	3000,3200,3400,3600,3800,4000,4500,4800,5000,5500
	6-H4P1	292	40	80±1.5	169±0.5	120	Φ17	M16	1000		3000,3200,3400,3600,3800,4000,4400,4800
									800		3800,4000,4400,4800,5000,5600,5800,6000,6400,6800,7200
									1000		3600,3800,4000,4400,4800,5000,5600,5800,6000,6400
	5-H5P1	245	31	90±1.5	140±0.5	105	Φ14	M16	1250	≥100	3000,3200,3400,3600,3800,4000,4400
	6-H5P1	292	40	90±1.5	169±0.5	120	Φ17	M16	1250		3200,3400,3600,3800,4000,4400,4800,5000,5600,5800
	5-H6P1	245	31	100±1.5	140±0.5	105	Φ14	M16	1250	≥100	2200,2500,2800,3000,3200,3400,3600,3800,4000,4200
	6-H6P1	292	40	100±1.5	169±0.5	120	Φ17	M16	1250		3200,3400,3600,3800,4000,4400,4800,5000,5500,5800,6000
	5-H8P1	245	31	130±1.5	140±0.5	105	Φ14	M16	1500	≥100	1600,1800,2000,2500,2800,3000,3200
									2000	≥100	1600,1800,2000,2200,2500,2800,3000
	6-H8P1	292	40	130±1.5	169±0.5	120	Φ17	M16	1500	≥100	3000,3200,3600,3800,4000,4200,4800,5000
									2000	≥100	2800,3000,3200,3600,3800,4000,4200

**Remark:** N-no indication; Default base indication  
 K-with additional switch

### Parallel Plate Structure

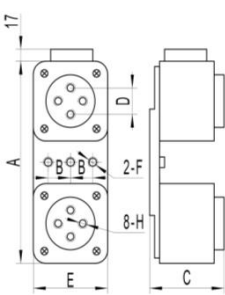
Scheme	Size No	Dimension (mm)							Voltage (VAC)	Interrupt (kA)	Rated Current (A)
		A	B	C	D	E	F	H			
	5-X1P1	245	31	60±1.5	140±0.5	105	M12	M10	690	≥200	3200,3400,3600,3800,4000,4400,4800,5000,5500,5800
	6-X1P1	292	40	60±1.5	169±0.5	120	M12	M12			3600,4000,4500,5000,5500,6000,6400,6800,7200
	5-X4P1	245	31	80±1.5	140±0.5	105	M12	M10	800	≥200	3000,3200,3400,3600,3800,4000,4500,4800,5000,5500
									1000		3000,3200,3400,3600,3800,4000,4400,4800
	6-X4P1	292	40	80±1.5	169±0.5	120	M12	M12	800		3800,4000,4400,4800,5000,5600,5800,6000,6400,6800,7200
									1000		3600,3800,4000,4400,4800,5000,5600,5800,6000,6400
	5-X5P1	245	31	90±1.5	140±0.5	105	M12	M10	1250	≥100	3000,3200,3400,3600,3800,4000,4400
	6-X5P1	292	40	90±1.5	169±0.5	120	M12	M12	1250		3200,3400,3600,3800,4000,4400,4800,5000,5600,5800
	5-X6P1	245	31	100±1.5	140±0.5	105	M12	M10	1250	≥100	2200,2500,2800,3000,3200,3400,3600,3800,4000,4200
	6-X6P1	292	40	100±1.5	169±0.5	120	M12	M12	1250		3200,3400,3600,3800,4000,4400,4800,5000,5500,5800,6000
	5-X8P1	245	31	130±1.5	140±0.5	105	M12	M10	1500	≥100	1600,1800,2000,2500,2800,3000,3200
									2000	≥100	1600,1800,2000,2200,2500,2800,3000
	6-X8P1	292	40	130±1.5	169±0.5	120	M12	M12	1500	≥100	3000,3200,3600,3800,4000,4200,4800,5000
									2000	≥100	2800,3000,3200,3600,3800,4000,4200

**Remark:** N-no indication; Default base indication  
 K-with additional switch





## RS306 High Speed Fuse for Semiconductor Protection

### Parallel Double Plate Structure - Catalogue

Scheme	Size No	Dimension (mm)							Voltage (VAC)	Interrupt (kA)	Rated Current (A)
		A	B	C	D	E	F	H			
See Below	3-HAP2	170	40±0.5	148±1.5	—	74	M10	17	2000	≥100	800,900,1000,1100,1250,1400
									2500		500,550,630,700,800,900,1000
	3-HBP2	170	40±0.5	168±1.5	—	74	M10	17	2500	≥100	630,700,800,900,1000,1100
	3-HCP2	170	40±0.5	188±1.5	—	74	M10	17	2500	≥100	400,500,700,800,900,1000,1100,1250
									3000		400,500,700,800,900,1000
	3-HHP2	170	40±0.5	223±1.5	—	74	M10	17	3000	≥100	400,500,550,630,700,800,900,1000,1100,1250
									3500		200,250,315,400,450,500,550,630,800,900,1000
									4000		400,450,500,550,630,700,800

**Remark:** N-no indication; Default base indication

K-with additional switch

中熔电气  
ZHONGNUO ELECTRIC

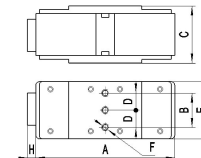

### DIN 43-653 Structure - Catalogue

Scheme	Size No	Dimension (mm)								Voltage (VAC)	Interrupt (kA)	Rated Current (A)
		A	B	C	D	F	H	M	N			
	01-T1Z	50	77	108±2	43	20	9	14	12.5	690	≥ 100	40,50,63,80,100,110,125,160,200,250,315,350,400,450,500,550,630
	1-T1Z	50	77±1.5	109±2	51	25	11	12.5	16	690		200,250,315,350,400,450,500,550,630,700,800
	2-T1Z	50	77±1.5	109±2	60	32	11	12.5	16	690		400,450,500,550,630,700,800,900,1000,1100,1250
	3-T1Z	51	77±1.5	109±2	74	32	11	12.5	16	690		500,550,630,700
	01-T2Z	71	100	131±2	43	20	9	14	12.5	690	≥ 100	40,50,63,80,100,110,125,160,200,250,315,350,400,450,500,550,630
										1000	≥ 100	160,200,250,315,350,400,450,500,550,630,700,800
										1250	≥ 80	50,63,80,100,110,125,160,200,250,315,350,400,450,500,550,630,700,800
	1-T2Z	71	100±1.5	132±2	51	25	11	12.5	16	690	≥ 100	100,125,160,200,250,315,350,400,450,500,550,630,700,800
										1000	≥ 100	160,200,250,315,350,400,450,500,550,630,700,800
	2-T2Z	71	100±1.5	132±2	60	32	11	12.5	16	690	≥ 100	315,350,400,450,500,550,630,700,800,900,1000,1100,1250
										1000	≥ 100	250,315,350,400,450,500,550,630,700,800,900,1000,1100,1250
	3-T2Z	72	100±1.5	132±2	74	32	11	12.5	16	690	≥ 100	500,550,630,700
1000										≥ 100	315,350,400,450,500,550,630,700,800,900,1000,1100,1250	
01-T5Z	80	107	138±2	43	20	9	14	12.5	1000	≥ 100	40,50,63,80,100,110,125,160,200,250,315,350,400,450,500,550,630,700,800,900,1000,1100,1250,1400	
									1250	≥ 80	50,63,80,100,110,125,160,200,250,315,350,400,450,500,550,630,700,800,900,1000,1100,1250,1400	
1-T5Z	80	107±1.5	139±2	51	25	11	12.5	16	1000	≥ 100	160,200,250,315,350,400,450,500,550,630,700,800,900,1000,1100,1250,1400	
2-T5Z	80	107±1.5	139±2	60	32	11	12.5	16	1000	≥ 100	250,315,350,400,450,500,550,630,700,800,900,1000,1100,1250,1400	
									1250	≥ 80	250,315,350,400,450,500,550,630,700,800,900,1000,1100,1250,1400	
3-T5Z	81	107±1.5	139±2	74	32	11	12.5	16	1000	≥ 100	315,350,400,450,500,550,630,700,800,900,1000,1100,1250,1400	
									1250	≥ 80	315,350,400,450,500,550,630,700,800,900,1000,1100	

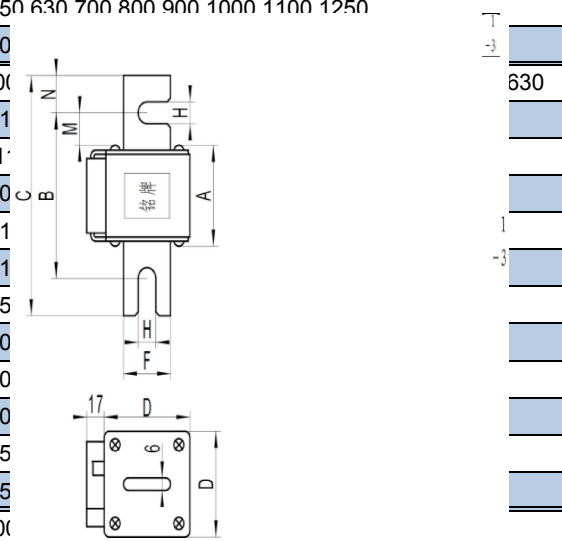

**Remark:** T-Visual Indication; N-no indication; Default base indication

K-with additional switch

### DIN 43-653 Structure - Catalogue

Scheme	Size No	Dimension (mm)								Voltage (VAC)	Interrupt (kA)	Rated Current (A)
		A	B	C	D	F	H	M	N			
See Below	1-R4Z	72	110±1.5	140±2	51	25	11	19	15	690	≥ 100	200,250,315,350,400,450,500,550,630,700,800
		1000	≥ 100	160,200,250,315,350,400,450,500,550,630								
	2-R4Z	72	110±1.5	140±2	60	32	11	19	15	690	≥ 100	400,450,500,550,630,700,800,900,1000,1100,1250
		1000	≥ 100	250,315,350,400,450,500,550,630,700,800								
	3-R4Z	73	110±1.5	140±2	74	32	11	19	15	690	≥ 100	500,550,630,700,800,900,1000,1100,1250,1400,1600
		1000	≥ 100	315,350,400,450,500,550,630,700,800,900,1000,1100,1250								
	1-R9Z	123	162±2	192±2.5	51	25	11	19	15	1500	≥ 80	40,50,63,80,100,125,160,200,250,315
		2000	≥ 50	40,50,63,80,100,125,160,200,250,315								

**Remark:** T-Visual Indication; N-no indication; Default base indication

K-with additional switch

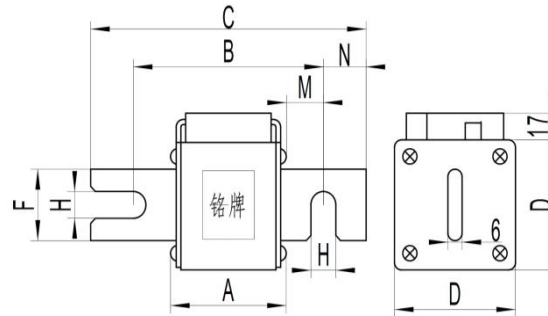

## DIN 43-653 Structure - Catalogue

Scheme	Size No	Dimension (mm)								Voltage (VAC)	Interrupt (kA)	Rated Current (A)
		A	B	C	D	F	H	M	N			
See Below	1-W1Z	50	107±1.5	139±2	51	25	11	27.5	16	690	≥ 100	200,250,315,350,400,450,500,550,630,700,800
	2-W1Z	50	107±1.5	139±2	60	32	11	27.5	16	690		400,450,500,550,630,700,800,900,1000,1100,1250
	3-W1Z	51	107±1.5	139±2	74	32	11	27.5	16	690		500,550,630,700,800,900,1000,1100,1250,1400,1600

**Remark:** T-Visual Indication; N-no indication; Default base indication

K-with additional switch

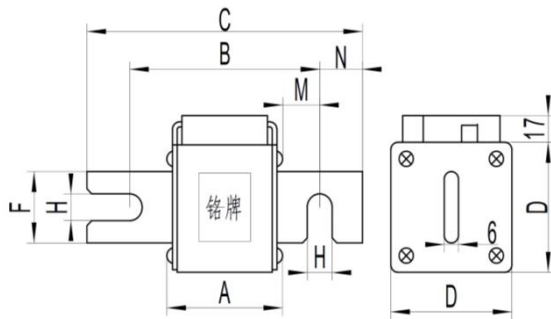

### Stud-Mounted (Short) Structure - Catalogue

Scheme	Size No	Dimension (mm)							Voltage (VAC)	Interrupt (kA)	Rated Current (A)
		A	B	B1	C	D	F	H			
See Below	1-Q1Z	50	77±1.5	107±1.5	135±2	51	14	25	690	≥ 100	200,250,315,350,400,450,500,630,700,800
	2-Q1Z	50	77±1.5	107±1.5	135±2	60	14	32	690		400,450,500,630,700,800,900,1000,1100,1250
	3-Q1Z	51	77±1.5	107±1.5	135±2	74	16	38	690		500,630,700,800,900,1000,1100,1250,1400,1600
	1-Q2Z	70	100±1.5	130±1.5	159±2	51	14	25	690	≥ 100	200,250,315,350,400,450,500,630,700,800
									1000	≥ 100	160,200,250,315,350,400,450,500,550,630
									1250	≥ 80	160,200,250,315,350,400,450
	2-Q2Z	70	100±1.5	130±1.5	159±2	60	14	32	690	≥ 100	400,450,500,630,700,800,900,1000,1100,1250
									1000	≥ 100	250,315,350,400,450,500,550,630,700,800
									1250	≥ 80	250,315,350,400,450,500,630
	3-Q2Z	71	100±1.5	130±1.5	159±2	74	16	38	690	≥ 100	500,630,700,800,900,1000,1100,1250,1400,1600
									1000	≥ 100	315,350,400,450,500,550,630,700,800,900,1000,1100,1250
									1250	≥ 80	315,350,400,450,500,550,630,700,800

**Remark:** T-Visual Indication; N-no indication; Default base indication

K-with additional switch

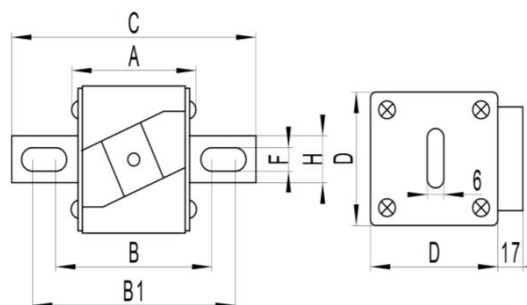

### Stud-Mounted (Long) Structure - Catalogue

Scheme	Size No	Dimension (mm)							Voltage (VAC)	Interrupt (kA)	Rated Current (A)
		A	B	B1	C	D	F	H			
See Below	1-B1Z	50	99±1.5	125±1.5	155±2	51	14	25	690	≥ 100	200,250,315,350,400,450,500,630,700,800
	2-B1Z	50	99±1.5	125±1.5	155±2	60	14	32	690	≥ 100	400,450,500,630,700,800,900,1000,1100,1250
	3-B1Z	51	99±1.5	125±1.5	155±2	74	16	38	690	≥ 100	500,630,700,800,900,1000,1100,1250,1400,1600

**Remark:** T-Visual Indication; N-no indication; Default base indication

K-with additional switch

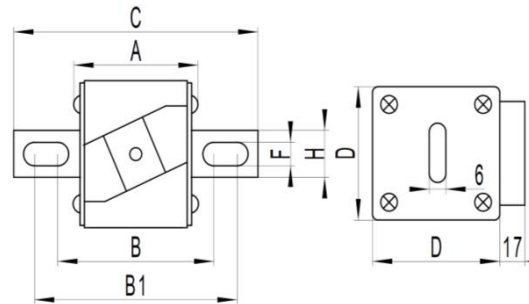

### French Style Structure - Catalogue

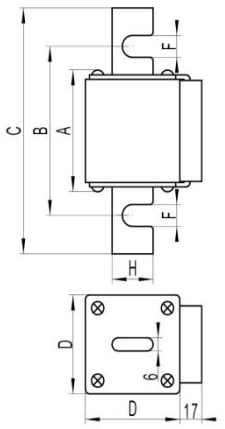
Dimension	Size No	Dimension (mm)						Voltage (VAC)	Interrupt (kA)	Rated Current (A)
		A	B	C	D	F	H			
	01-E1Z	50	78±1.5	103±2	43	9	20	690	≥100	40,50,63,80,100,110,125,160,200,250,315,350,400,450,500
	1-E1Z	50	86±1.5	110±2	51	11	25	690	≥100	200,250,315,350,400,450,500,630,700,800
	2-E1Z	50	90±1.5	120±2	60	13	32	690	≥100	400,450,500,630,700,800,900,1000
	3-E1Z	51	90±1.5	120±2	74	13	38	690	≥100	500,630,700,800,900,1000,1100,1250,1400,1500
	01-E2Z	70	101±1.5	126±2	43	9	20	690	≥100	40,50,63,80,100,110,125,160,200,250,315,350,400,450,500
								1000	≥100	50,63,80,100,110,125,160,200,250,315,350,400
								1250	≥80	50,63,80,100,110,125,160,200,250,315,350
	1-E2Z	70	110±1.5	134±2	51	11	25	690	≥100	200,250,315,350,400,450,500,630,700,800
								1000	≥100	160,200,250,315,350,400,450,500,550,630
	2-E2Z	70	114±1.5	144±2	60	13	32	690	≥100	400,450,500,630,700,800,900,1000
								1000	≥100	250,315,350,400,450,500,550,630,700,800
	3-E2Z	71	114±1.5	144±2	74	13	38	690	≥100	500,630,700,800,900,1000,1100,1250
								1000	≥100	315,350,400,450,500,550,630,700,800,900
								1250	≥80	315,350,400,450,500,550,630

**Remark:**T-Visual Indication; N-no indication; Default base indication

K-with additional switch



### Blade Type Structure - Catalogue

Scheme	Size No	Dimension (mm)							Voltage (VAC)	Interrupt (kA)	Rated Current (A)
		A	B	C	D	E	F	H			
See Below	00-C1Z	49	78.5±1.5	29	45	57	12	15	690	≥ 100	10, 16, 20, 25, 32, 35, 40, 50, 63, 80, 100, 125, 160, 200, 250
									1000		20, 25, 32, 35, 40, 50, 63, 80, 100, 125, 160, 200, 225
	1-C4Z	68	135±2.5	48	48	62	12	20	690	≥ 100	50, 63, 80, 100, 125, 160, 200, 250, 315, 350, 400
									1000		50, 63, 80, 100, 125, 160, 200, 250, 315, 350, 400
	2-C4Z	68	150±2.5	58	58	72	14	25	690	≥ 100	200, 250, 315, 350, 450, 500, 550, 630
									1000		200, 250, 315, 350, 450, 500, 550, 630
	3-C4Z	68	150±2.5	74	74	88	18	32	690	≥ 100	350, 450, 500, 550, 630, 700, 800, 1000
									1000		350, 450, 500, 550, 630, 700, 800
	1-NGC	68	135±2.5	48	48	62	12	20	690	≥ 100	50, 63, 80, 100, 125, 160, 200, 250, 315, 350, 400
									1000		50, 63, 80, 100, 125, 160, 200, 250, 315, 350, 400
	2-NGC	68	150±2.5	58	58	72	14	25	690	≥ 100	200, 250, 315, 350, 450, 500, 550, 630
									1000		200, 250, 315, 350, 450, 500, 550, 630
	3-NGC	68	150±2.5	68	68	87	17	32	690	≥ 100	350, 450, 500, 550, 630, 700, 800
									1000		350, 450, 500, 550, 630, 700, 800

**Remark:** N-No Indication; Default Visual Indication  
 NGC Fuses in Yellow Color; C1Z/C4Z in White Color  
**Note:** Please specify if switch is required.

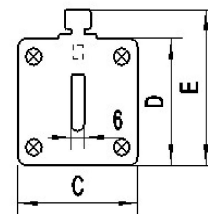
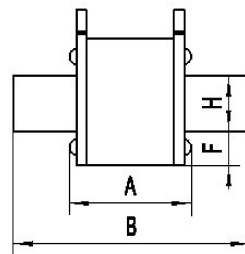

## DIN 43-653 Structure - Catalogue

Scheme	Size No	Dimension (mm)					Voltage (VAC)	Interrupt (kA)	Rated Current (A)
		A	B	C	D	E			
Figure 1	000-L	40	21	20	8.5	52	690	≥ 100	10,16,20,25,32,40,50,63,80,100,110,125,160,200,250,315
							800		6,10,16,20,25,32,40,50,63,80,100,110,125,160,200,225
	00-L	49	29	28	10	62	690	≥ 100	20,25,32,40,50,63,80,100,110,125,160,200,250,315,350,400
							1000		20,25,32,40,50,63,80,100,110,125,160,200,250,*315
Figure 2	000-LO	40	21	20	8.5	—	690	≥ 100	10,16,20,25,32,40,50,63,80,100,110,125,160,200,250,315
							800		6,10,16,20,25,32,40,50,63,80,100,110,125,160,200,225
	00-LO	49	29	28	10	—	690	≥ 100	20,25,32,40,50,63,80,100,110,125,160,200,250,315,350,400
							1000		20,25,32,40,50,63,80,100,110,125,160,200,250,*315
Figure 3	000-LN	40	21	20	8.5	—	690	≥ 100	10,16,20,25,32,40,50,63,80,100,110,125,160,200,250,315
							800		6,10,16,20,25,32,40,50,63,80,100,110,125,160,200,225
	00-LN	49	29	28	10	—	690	≥ 100	20,25,32,40,50,63,80,100,110,125,160,200,250,315,350,400
							1000		20,25,32,40,50,63,80,100,110,125,160,200,250,*315

**Remark:** 1.L Visual Indication, with switch; LO: Visual Indication; LN: No indication; K-with switch

2.\* Rated Voltage 900V

**Note:** Please specify if switch is required.

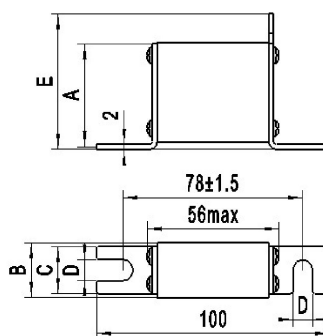

Figure 1

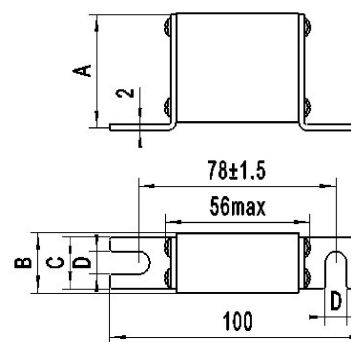

Figure 2



## Offset Stud Mounted Structure - Catalogue

Scheme	Size No	Dimension (mm)								Voltage (VAC)	Interrupt (kA)	Rated Current (A)
		A	B	C	D	E	F	G	H			
Figure 1	00-LQ	78±1.5	98±2	28	29	49	9	65	11	690	≥ 100	25,32,40,50,63,80,100,110,125,160,200,250,315,350,400
Figure 2	1-Q1L	92±1.5	122±2	30	51	56	9	3	13	250	≥ 100	50,63,80,100,110,125,160,200,250,315,355,400,450,500,630
										500 690	≥ 100	50,63,80,100,110,125,160,200,225,315,355,400,450,500
	3-Q1L	102±1.5	142±2	50	74	81	13	5	20	250	≥ 100	500,550,630,700,800,900,1000
										500 690	≥ 100	400,450,500,550,630,700,800
										1000	≥ 100	50,63,80,100,110,125,160,200,225,315,355,400,450,500
										1000	≥ 100	400,450,500,550,630,700,800
										1250	≥ 80	50,63,80,100,110,125,160,200,225,315,355,400,450,500
										1250	≥ 80	400,450,500,550,630,700,800
										1500	≥ 70	50,63,80,100,110,125,160,200,225,315,355,400
										2000	≥ 50	50,63,80,100,110,125,160,200,225,315
1500	≥ 70	400,450,500,550,630,700										
2000	≥ 50	250,315,350,400,450,500,550,630										
3000	≥ 50	160,200,250,315,350,400										



Rema  
K-1  
Note:  
Pleas

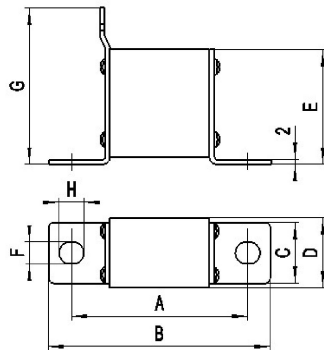

图一

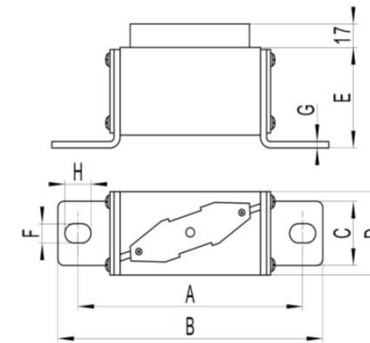

Figure 2

**Offset**

S <sub>t</sub>
S <sub>e</sub>

Remark:  
K-with

Rated Current (A)
200,100,250,315,350,400
200,100,250,315,350,400
200,100,250,315,350,400

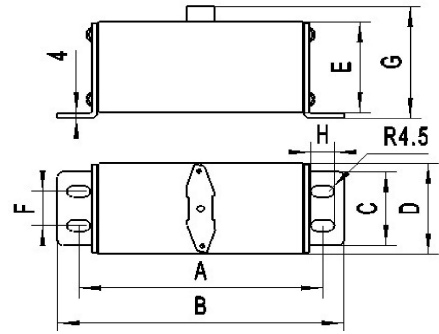

- ⊙ Pr
- Stand
- Protec
- Ratec
- Very l
- Indica
- RoHS

⊙ Mod  
RS



Example: RS306-1-S2P-800A690V-K--- Size No 1, Dimension S2P, Current 800A, Voltage 690V, with switch indication

End - Catalogue

Size No	Dimension (mm)							Voltage (V AC)	Interrupt (kA)	Rated Voltage (A)
	A	B	C	D	E	F	H			
			43	55	Φ17	M8	6	250 500 690	≥100	20,25,32,40,50,63,80,100,125,160,200,250,315,350,400,450,500,550,630
			51	63	Φ20	M8	9			200,250,315,350,400,450,500,550,630,700,800
			60	72	Φ24.5	M10	10			400,450, 500,550,630,700,800,900,1000,1100,1250
			74	86	Φ30	M12	11			500,550,630,700,800,900,1000,1100,1250,1400,1600
			85	97	Φ53.5	M12	11			1100,1250,1400,1600,1800,2000,2200
			105	117	Φ70	M16	14			1250,1400,1600,1800,2000,2200,2500,2800,3000
			51	63	Φ20	M8	9	250	≥100	200,250,315,350,400,450,500,550,630,700,800
			60	72	Φ24.5	M10	10	500		400,450, 500,550,630,700,800,900,1000,1100,1250
			74	86	Φ30	M12	11	690		500,550,630,700,800,900,1000,1100,1250,1400,1600
74.5 <sup>+1.5</sup> <sub>+0.5</sub>			43	55	Φ17	M8	6	690	≥100	20,25,32,40,50,63,80,100,125,160,200,250,315,350,400,450,500,550,630
								1000		20,25,32,40,50,63,80,100,125,160,200,250,315,350,400
								1250		20,25,32,40,50,63,80,100,125,160,200,250,315,350,400
74.5 <sup>+1.5</sup> <sub>+0.5</sub>			51	63	Φ20	M8	9	690	≥100	200,250,315,350,400,450,500,550,630,700,800
								1000		160,200,250,315, 350,400,450,500,550,630
								1250		125,160,200,250,315, 350,400,450,500,550,630
74.5 <sup>+1.5</sup> <sub>+0.5</sub>			60	72	Φ24.5	M10	10	690	≥100	315,350,400,450,500,550,630,700,800,900,1000,1100,1250
								1000		250,315,350,400,450,500,550,630,700,800,900,1000
								1250		250,315,350,400,450,500,550,630,700,800,900
75.5 <sup>+1.5</sup> <sub>+0.5</sub>			74	86	Φ30	M12	11	1000	≥100	315,350,400,450,500,550,630,700,800,900,1000,1100,1250
								1250		315,350,400,450,500,550,630,700,800,900,1000



End - Catalogue

Size No	Dimension (mm)							Voltage (V AC)	Interrupt (kA)	Rated Voltage (A)
	A	B	C	D	E	F	H			
-S4P	74	80±1.5	85	97	Φ54	M12	11	800	≥120	1100, 1250, 1400, 1600, 1800, 2000, 2200
								1000		1000, 1100, 1250, 1400, 1600, 1800, 2000
-S4P	74	80±1.5	105	117	Φ56	M16	14	800		1250, 1400, 1600, 1800, 2000, 2200, 2500, 2800
								1000		1100, 1250, 1400, 1600, 1800, 2000, 2200, 2500
-S5P	80	81±1.5	43	55	Φ17	M8	6	1250	≥100	20, 25, 32, 40, 50, 63, 80, 100, 125, 160, 200, 250, 315, 350, 400
-S5P	80	81±1.5	51	63	Φ20	M8	9	1250		125, 160, 200, 250, 315, 350, 400, 450, 500, 550
-S5P	80	81±1.5	60	72	Φ24.5	M10	10	1250		250, 315, 350, 400, 450, 500, 550, 630, 700, 800
-S5P	80	82±1.5	74	86	Φ30	M12	11	1250		315, 350, 400, 450, 500, 550, 630, 700, 800, 900, 1000, 1100
-S5P	84	90±1.5	85	97	Φ53.5	M12	11	1250		800, 900, 1000, 1100, 1250, 1400, 1600
-S5P	84	90±1.5	105	117	Φ70	M16	14	1250		1100, 1250, 1400, 1600, 1800, 2000, 2200
-S6P	88	90±1.5	74	86	Φ30	M12	11	1250	≥100	315, 350, 400, 450, 500, 550, 630, 700, 800, 900, 1000, 1100, 1250
-S7P	100	108±2	74	86	Φ30	M12	10	1500	≥50	315, 350, 400, 450, 500, 550, 630, 700, 800, 900
-M9P	123	128±2.5	51	63	Φ20	M8	9	1500	≥50	20, 25, 32, 40, 50, 63, 80, 100, 110, 125, 160, 200, 250, 315, 350, 400
								2000		20, 25, 32, 40, 50, 63, 80, 100, 110, 125, 160, 200, 250, 315, 350
-M9P	123	128±2.5	60	72	Φ24.5	M10	10	1500		160, 200, 250, 315, 350, 400, 450, 500, 550, 630
								2000		160, 200, 250, 315, 350, 400, 450, 500
-M9P	123	129±2.5	74	86	Φ30	M12	10	1500		200, 250, 315, 350, 400, 450, 500, 550, 630, 700, 800, 900
								2000		200, 250, 315, 350, 400, 450, 500, 550, 630, 700, 800
-S8P	124	130±2.5	85	97	Φ54	M12	11	1500		400, 450, 500, 550, 630, 700, 800, 900, 1000, 1100, 1250
								2000		500, 550, 630, 700, 800, 900, 1000
5-S8P	124	130±2.5	105	117	Φ56	M16	14	1500		1000, 1100, 1250, 1400, 1600, 1800, 2000
								2000		800, 900, 1000, 1100, 1250, 1400, 1600



## Single Socket Flat End - Catalogue

Scheme	Size No	Dimension (mm)							Voltage (V AC)	Interrupt (kA)	Rated Voltage (A)	
		A	B	C	D	E	F	H				
See Below	1-S9P	123	124±2.5	51	63	Φ20	M8	9	1500	≥50	20, 25, 32, 40, 50, 63, 80, 100, 110, 125, 160, 200, 250, 315, 350	
									2000		20, 25, 32, 40, 50, 63, 80, 100, 110, 125, 160, 200, 250, 315	
	2-S9P	123	124±2.5	60	72	Φ24.5	M10	10	1500		200, 250, 315, 350, 400, 450, 500, 550, 630	
									2000		200, 250, 315, 350, 400, 450, 500	
	3-S9P	123	125±2.5	74	86	Φ30	M12	11	1500		315, 350, 400, 450, 500, 550, 630, 700, 800, 900	
									2000		315, 350, 400, 450, 500, 550, 630, 700, 800	
	3-SAP	141	142±2.5	74	86	Φ30	M12	10	2000		≥50	160, 200, 250, 315, 350, 400, 450, 500, 550, 630, 700, 800
									2500			100, 125, 160, 200, 250, 315, 350, 400, 450, 500, 550, 630

**Remark:** K-with switch; N-No indication; Default visual indication

2500

