



泽诺动力



PRODUCT MANUALS
风扇及过滤器



PRODUCT MANUALS
加热器及温控器



PRODUCT MANUALS
LED机柜灯



PRODUCT MANUALS

散热风机选型手册

📍 苏州市吴中区胥口镇合丰路558号

☎ 159 6222 3467 / 180 1307 1198 (销售经理)

🌐 <http://www.jszndlkj.com/>



了解更多产品详情 请联系我们

了解更多产品详情 请查阅

COMPANY PROFILE

公司介绍

苏州泽诺动力科技有限公司，是集研发、生产、销售、服务为一体的科技型企业。

公司以"高起点、高标准、高质量"为质量宗旨，致力于打造拥有专业的研发、成熟的工艺、先进的生产严格的检测的现代化企业。

公司主要以机柜环境为主导，生产销售散热风扇、防护网及通风过滤器系列、加热器及温控器系列、控制柜除湿器系列、机柜灯系列以及电控配套件等系列产品。

SUZHOU ZENO POWER TECHNOLOGY CO.,LTD IS A TECHNOLOGY-BASED ENTERPRISE THAT INTEGRATES RESEARCH AND DEVELOPMENT, PRODUCTION, SALES, AND SERVICE. THE COMPANY ATTACHES TO THE EXCELLENCE OF HIGH STARTING POINT, HIGH STANDARDS, AND HIGH QUALITY, AND IS COMMITTED TO BUILDING A MODERN ENTERPRISE WITH PROFESSIONAL RESEARCH AND DEVELOPMENT, MATURE PROCESSES, AND ADVANCED PRODUCTION AND STRICT TESTING. THE COMPANY MAINLY FOCUSES ON CABINET ENVIRONMENT, PRODUCTION AND SELLING COOLING FANS, PROTECTIVE SCREENS AND VENTILATION, HEATING AND TEMPERATURE CONTROL, HUMIDITY CONTROL, CABINET LIGHT SERIES, ELECTRIC CONTROL ACCESSORIES, AND OTHER SERIES OF PRODUCTS.

公司成立至今，一直奉行"坦诚、沟通、信任、合作、互惠、共赢"的经营宗旨，以良好的信誉和优质的产品赢得了广大客户的信赖和支持。面对问题我们将以积极的态度、严谨的分析、有效的改善，与新老客户起共同努力，为广大客户的兴旺发达作出新贡献，也使广大客户选用本公司的产品始终充满信心！

SINCE ITS ESTABLISHMENT, THE COMPANY HAS ALWAYS ADHERED TO THE BUSINESS PHILOSOPHY OF HONESTY, COMMUNICATION, TRUST, COOPERATION, MUTUAL BENEFIT, AND WIN-WIN, AND HAS WON THE TRUST AND SUPPORT OF CUSTOMERS WITH GOOD REPUTATION AND HIGH-QUALITY PRODUCTS. IN THE FACE OF PROBLEMS, WE WILL WORK TOGETHER WITH NEW AND OLD CUSTOMERS WITH A POSITIVE ATTITUDE, RIGOROUS ANALYSIS, AND EFFECTIVE IMPROVEMENT, MAKING NEW CONTRIBUTIONS TO THE PROSPERITY AND DEVELOPMENT OF OUR CUSTOMERS, AND ALSO MAKING THEM ALWAYS CONFIDENT IN CHOOSING OUR COMPANY'S PRODUCTS.



■ 卓越的企业文化

企业文化是保持企业基业长青的根本。泽诺动力的企业文化源于现实的努力，以及对未来的追求。企业成功探索了创新技术与自我发展相结合的模式，把“创新”带进了企业的历史进程。随着市场环境的变化，追求品质创新已变成泽诺动力坚定的信念和前进的动力。

■ 精湛的的生产工艺

泽诺动力坚持使用精湛的的生产设备和工艺，极大的提高了生产效率，保证了产品的优良性能和品质的一致性保护了员工作业安全。泽诺动力密切关注行业最新发展动态，不断地进行技术升级，保持产品、工艺技术和加工、检测设备的先进性。

■ 质量为先的产品管理

泽诺动力一直以来对产品质量采取严谨态度和精益求精的精神，“质量为先”的理念和原则贯穿于产品开发、生产、销售及售后服务的整个业务链。泽诺动力目前通过了ISO9001:2015国际质量体系认证，并通过了国际权威机构质量安全认证及CQC的产品质量认证。

■ 雄厚的开发能力

泽诺动力在开发领域建立了功能完善、水平领先的技术开发部，已具备多系列产品开发能力，并且能够针对客户需求进行深入的研究和开发。泽诺动力也一直着重挑选和培养技术人才，是公司未来开发能力建设中重要的一环，也正因为这一系列举措，公司在产品开发实力方面正一步一步迈上更高的台阶。

■ 可持续发展的企业

从建厂开始，企业就将环保确定为基本方针，并遵循国家环保要求，结合自身产品和生产流程特点，摸索和总结出了适合自己的、行之有效的环境保护管理措施。也实现了众多产品符合 ROHS 环保要求和实现无卤阻燃！泽诺动力目标就是实现企业环境管理、产品环境性能及市场环境需求，三者能达到可持续发展，更好的服务于社会。

愿成长中的泽诺动力成为您最佳合作伙伴！

诚挚的欢迎国内外朋友莅临指导！



COMPANY PHILOSOPHY

经营理念

研发创新

研发理念：自主研发、勇于创新、可靠实用

精益求精

制造理念：精益生产、质量至上

持续发展

指导思想：优质的人才、专业的研发、先进的生产、严格的检测

服务至上

服务理念：坦诚、信任、合作、共赢

REFORMATION
RESEARCH AND DEVELOPMENT PHILOSOPHY: INDEPENDENT RESEARCH AND DEVELOPMENT, COURAGE TO INNOVATE, RELIABLE AND PRACTICAL.

STRIVING FOR EXCELLENCE
MANUFACTURING PHILOSOPHY: LEAN MANUFACTURING, QUALITY FIRST.

SUSTAINED DEVELOPMENT
GUIDING THOUGHT: HIGH QUALITY TALENTS, PROFESSIONAL RESEARCH AND DEVELOPMENT, ADVANCED PRODUCTION, AND STRICT TESTING.

SERVICE FIRST
SERVICE PHILOSOPHY: HONESTY, TRUST, COOPERATION, AND WIN-WIN SITUATION.

企业愿景：快乐工作，心中有梦，齐心协力，创造辉煌

企业使命：为员工提供机会、为客户创造价值、为社会承担责任

企业目标：创知名品牌，建优质企业

企业精神：诚信互勉共创鸿图

CORPORATE VISION: WORK HAPPILY, HAVE DREAMS IN YOUR HEART, WORK TOGETHER TO CREATE BRILLIANCE.
CORPORATE MISSION: PROVIDING OPPORTUNITIES FOR EMPLOYEES, CREATING VALUE FOR CUSTOMERS, AND TAKING RESPONSIBILITY FOR SOCIETY.
CORPORATE GOAL: TO CREATE A WELL-KNOWN BRAND AND BUILD A HIGH-QUALITY ENTERPRISE.
CORPORATE SPIRIT: INTEGRITY, MUTUAL ENCOURAGEMENT, AND CREATING A GREAT FUTURE TOGETHER.

QUALIFICATION CERTIFICATION

资质认证

专注于机柜控制环境的安全与节能问题

专业 · 专注 · 品质 · 高效



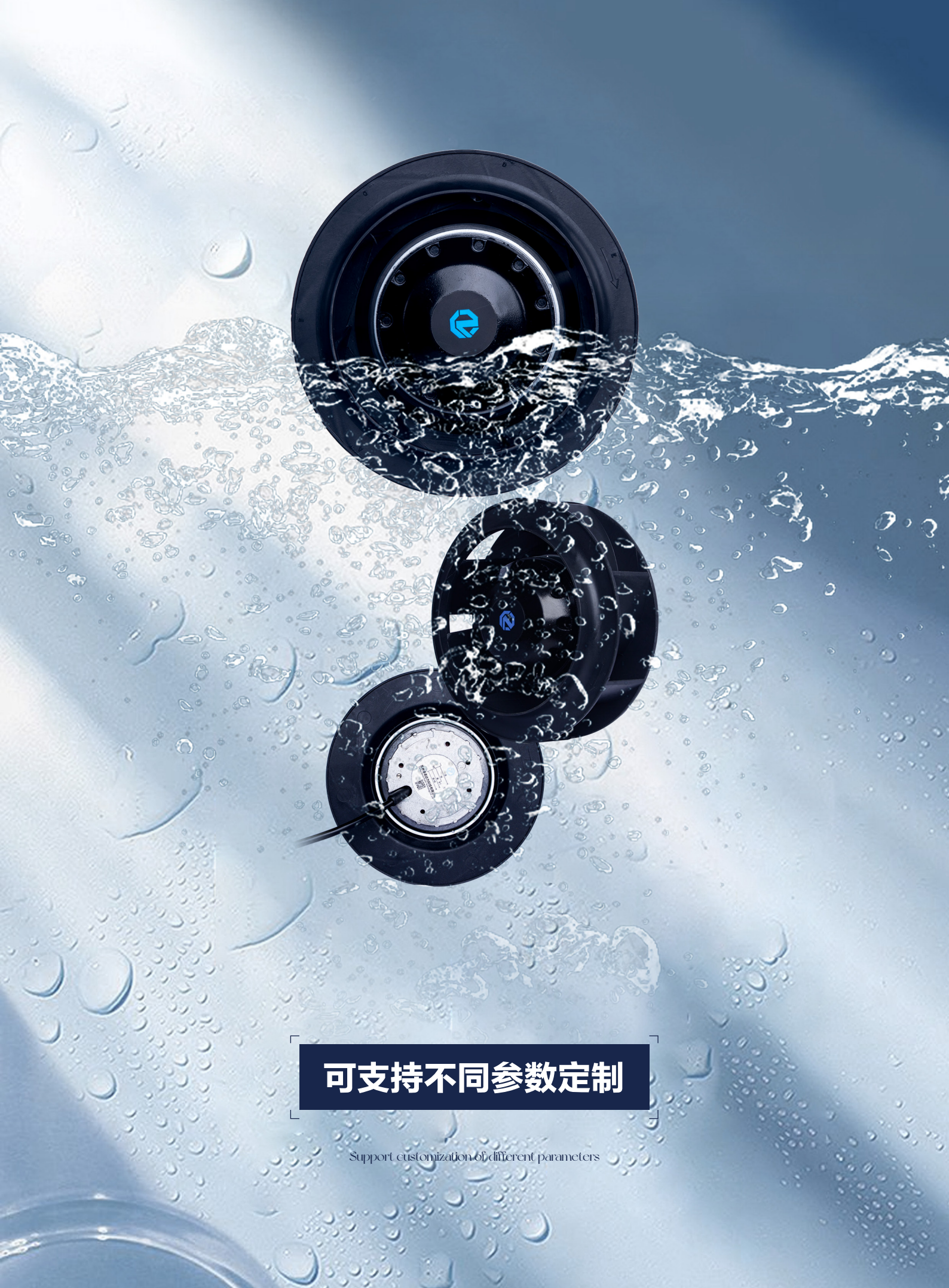

可支持不同参数定制

Support customization of different parameters

PRODUCT CATALOG

产品目录

AC后倾离心风机

GENERAL SPECIFICATIONS

001 / 010

01

AC前倾离心风机

GENERAL SPECIFICATIONS

011 / 016

02

AC金属轴流风机

GENERAL SPECIFICATIONS

017 / 022

03

AC轴流风机

GENERAL SPECIFICATIONS

023 / 037

04

DC轴流风机

GENERAL SPECIFICATIONS

038 / 052

05

PRODUCT INTRODUCTION

离心风机

后倾离心风机命名定义

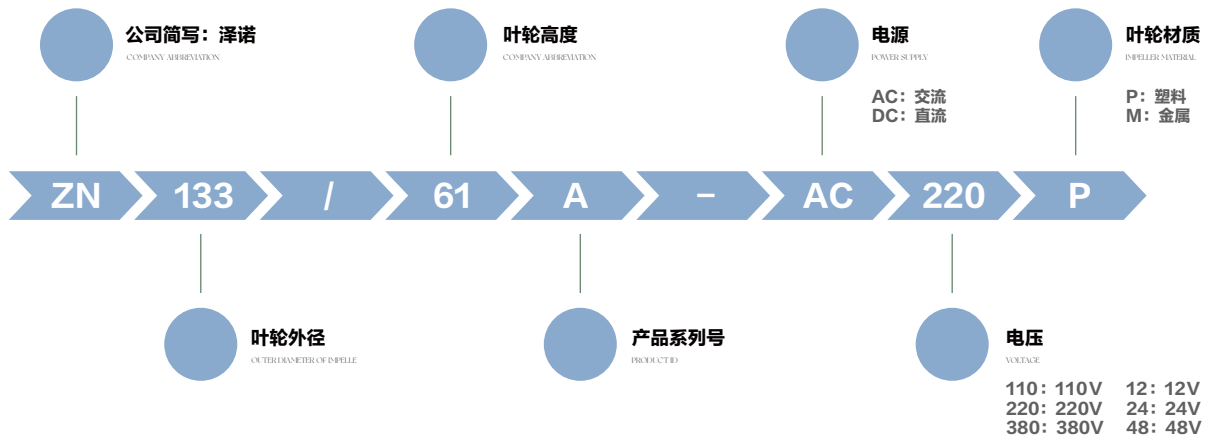

通用规范 / GENERAL SPECIFICATIONS

- 绝缘等级:** Class B
(Insulation)
- 材质:** Impeller: Plastic; Frame: Aluminum Alloy
(Material)
- 线材:** UL Type
(Lead Wire)
- 工作模式:** S1
(Mode of operation)
- 工作环境:** -40℃~+65℃, 0%~95% RH
(Operation Temperature)
- 储存环境:** -40℃~+65℃, 0%~95% RH
(Storage Temperature)
- 功能选择:** Impedance Protected / Thermal control
(Available Features)
- 振动:** 风机振动速度有效值按照JB/T8689标准规定
(Vibration of the fan)
- 防护等级:** 电机的防护等级为IP44
(Type of protection)



技术参数 / TECHNICAL DATA

型号 Model	Freq 频率	Bearing System 轴承		Rated Voltage 额定电压	Rated Current 额定电流	Input Power 功率	Rated Speed 额定速度	Air Flow 风量	Air Pressure 风压	Noise Level 噪音	Weight 重量
	Hz	Ball	Sleeve	VAC	A	W	RPM	m³/H	Pa	dBA	g
ZN133/61A-AC220P	50	•		230	0.21	42	2700	290	185	56	820

(注: 以上数据仅供参考, 其他参数支持定制)

外观尺寸 / DIMENSIONS DRAWING

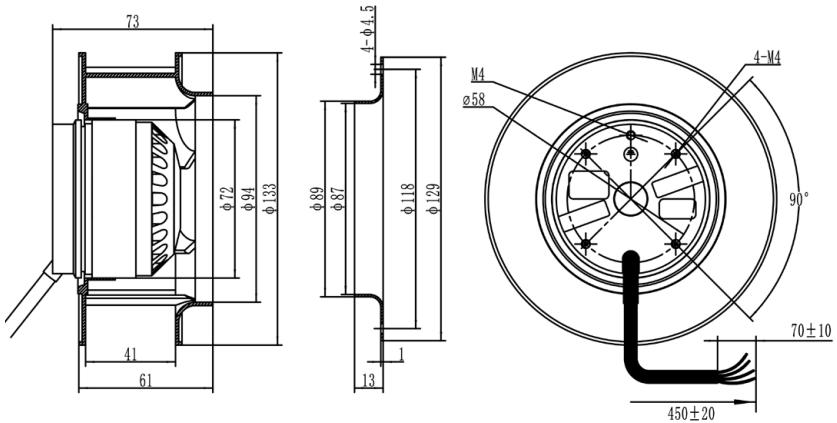

曲线 / P&Q CURVE (AT RATED VOLTAGE)

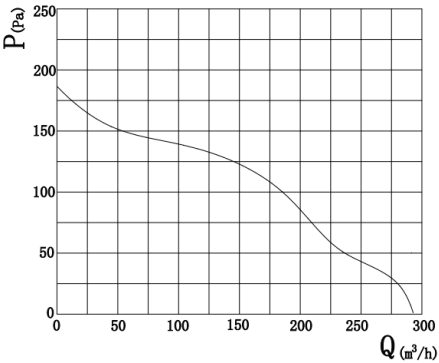

通用规范 / GENERAL SPECIFICATIONS

- 绝缘等级:

Class B

(Insuation)
- 材质:

Impeller: Plastic; Frame:Aluminum Alloy

(Material)
- 线材:

UL Type

(Lead Wire)
- 工作模式:

S1

(Mode ofoperation)
- 工作环境:

-40℃~+65℃,0%~95% RH

(Operation Temperature)
- 储存环境:

-40℃~+65℃,0%~95% RH

(Storage Temperature)
- 功能选择:

Impedance Protected / Thermal control

(Available Features)
- 振动:

风机振动速度有效值按照JB/T8689标准规定

(Vibration of the fan)
- 防护等级:

电机的防护等级为IP44

(Type of protection)



技术参数 / TECHNICAL DATA

型号 Model	Freq 频率	Bearing System 轴承		Rated Voltage 额定电压	Rated Current 额定电流	Input Power 功率	Rated Speed 额定速度	Air Flow 风量	Air Pressure 风压	Noise Level 噪音	Weight 重量
	Hz	Ball	Sleeve	VAC	A	W	RPM	m³/H	Pa	dBA	g
ZN175/62A-AC220P	50	•		230	0.2	43	2550	490	255	62	880

(注：以上数据仅供参考，其他参数支持定制)

外观尺寸 / DIMENSIONS DRAWING

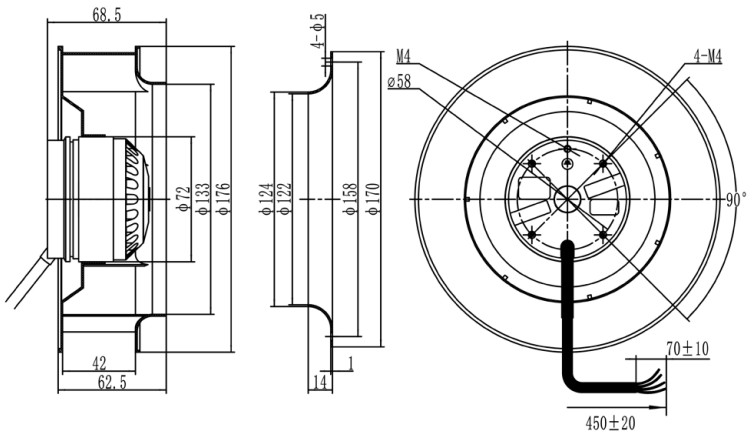

曲线 / P&Q CURVE(AT RATED VOLTAGE)

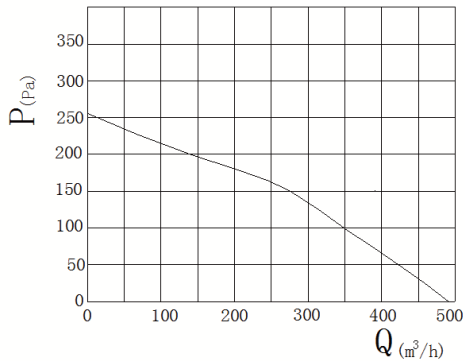

通用规范 / GENERAL SPECIFICATIONS

- 绝缘等级:

Class B

(Insuation)
- 材质:

Impeller: Plastic; Frame:Aluminum Alloy

(Material)
- 线材:

UL Type

(Lead Wire)
- 工作模式:

S1

(Mode ofoperation)
- 工作环境:

-40℃~+65℃,0%~95% RH

(Operation Temperature)
- 储存环境:

-40℃~+65℃,0%~95% RH

(Storage Temperature)
- 功能选择:

Impedance Protected / Thermal control

(Available Features)
- 振动:

风机振动速度有效值按照JB/T8689标准规定

(Vibration of the fan)
- 防护等级:

电机的防护等级为IP44

(Type of protection)



技术参数 / TECHNICAL DATA

型号 Model	Freq 频率	Bearing System 轴承		Rated Voltage 额定电压	Rated Current 额定电流	Input Power 功率	Rated Speed 额定速度	Air Flow 风量	Air Pressure 风压	Noise Level 噪音	Weight 重量
	Hz	Ball	Sleeve	VAC	A	W	RPM	m³/H	Pa	dBA	g
ZN190/63A-AC220P	50	•		230	0.35	75	2550	540	340	65	1350

(注：以上数据仅供参考，其他参数支持定制)

外观尺寸 / DIMENSIONS DRAWING

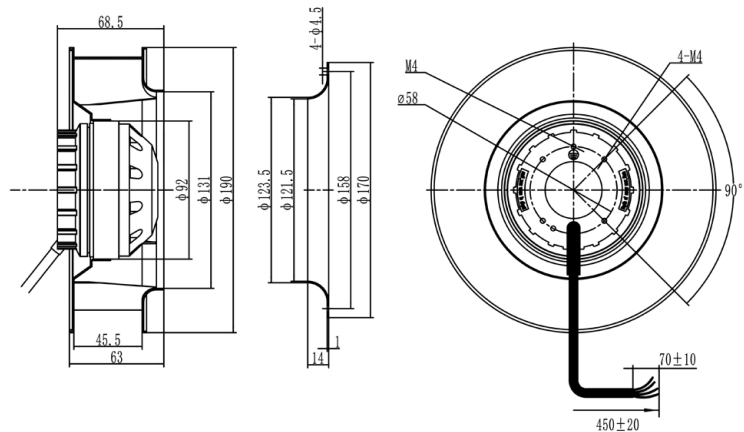

曲线 / P&Q CURVE(AT RATED VOLTAGE)

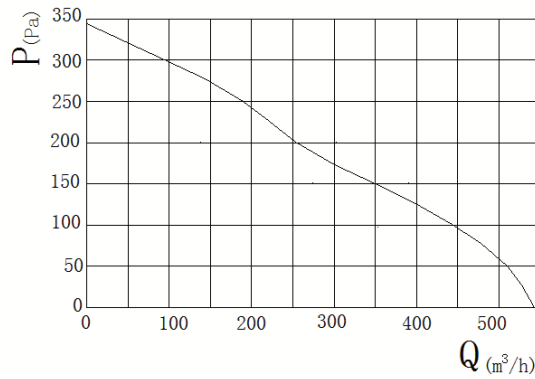

通用规范 / GENERAL SPECIFICATIONS

- 绝缘等级:

Class B

(Insuation)
- 材质:

Impeller: Steel; Frame:Aluminum Alloy

(Material)
- 线材:

UL Type

(Lead Wire)
- 工作模式:

S1

(Mode ofoperation)
- 工作环境:

-40℃~+65℃,0%~95% RH

(Operation Temperature)
- 储存环境:

-40℃~+65℃,0%~95% RH

(Storage Temperature)
- 功能选择:

Impedance Protected / Thermal control

(Available Features)
- 振动:

风机振动速度有效值按照JB/T8689标准规定

(Vibration of the fan)
- 防护等级:

电机的防护等级为IP44

(Type of protection)



技术参数 / TECHNICAL DATA

型号 Model	Freq 频率	Bearing System 轴承		Rated Voltage 额定电压	Rated Current 额定电流	Input Power 功率	Rated Speed 额定速度	Air Flow 风量	Air Pressure 风压	Noise Level 噪音	Weight 重量
	Hz	Ball	Sleeve	VAC	A	W	RPM	m³/H	Pa	dBA	g
ZN190/60A-AC220M	50	•		230	0.35	75	2500	600	400	65	1670

(注：以上数据仅供参考，其他参数支持定制)

外观尺寸 / DIMENSIONS DRAWING

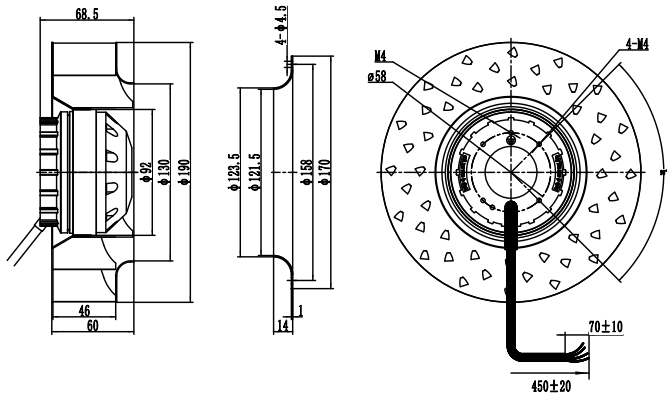

曲线 / P&Q CURVE(AT RATED VOLTAGE)

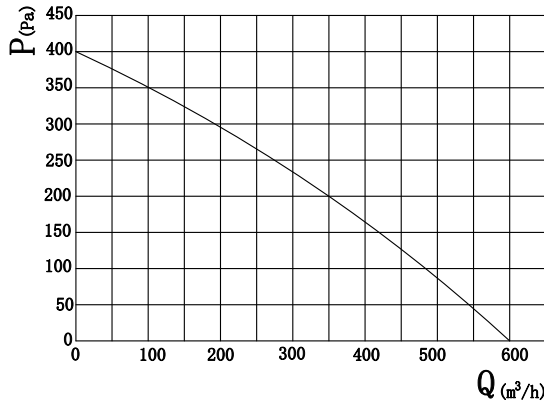

通用规范 / GENERAL SPECIFICATIONS

- 绝缘等级:

Class B

(Insuation)
- 材质:

Impeller: Plastic; Frame:Aluminum Alloy

(Material)
- 线材:

UL Type

(Lead Wire)
- 工作模式:

S1

(Mode ofoperation)
- 工作环境:

-40℃~+65℃,0%~95% RH

(Operation Temperature)
- 储存环境:

-40℃~+65℃,0%~95% RH

(Storage Temperature)
- 功能选择:

Impedance Protected / Thermal control

(Available Features)
- 振动:

风机振动速度有效值按照JB/T8689标准规定

(Vibration of the fan)
- 防护等级:

电机的防护等级为IP44

(Type of protection)



技术参数 / TECHNICAL DATA

型号 Model	Freq 频率	Bearing System 轴承		Rated Voltage 额定电压	Rated Current 额定电流	Input Power 功率	Rated Speed 额定速度	Air Flow 风量	Air Pressure 风压	Noise Level 噪音	Weight 重量
	Hz	Ball	Sleeve	VAC	A	W	RPM	m³/H	Pa	dBA	g
ZN220/64A-AC220P	50	•		230	0.55	110	2600	910	490	69	1800

(注：以上数据仅供参考，其他参数支持定制)

外观尺寸 / DIMENSIONS DRAWING

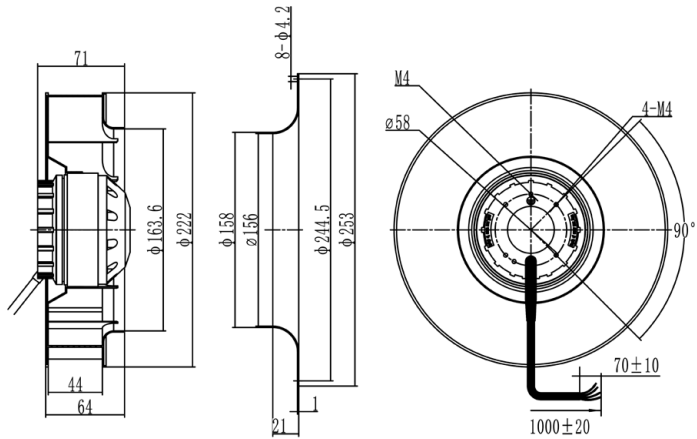

曲线 / P&Q CURVE(AT RATED VOLTAGE)

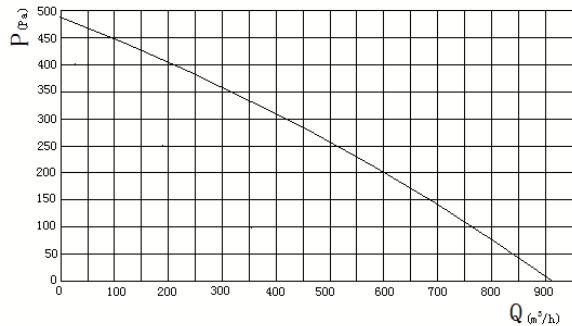

通用规范 / GENERAL SPECIFICATIONS

- 绝缘等级:

Class B

(Insuation)
- 材质:

Impeller: Plastic; Frame:Aluminum Alloy

(Material)
- 线材:

UL Type

(Lead Wire)
- 工作模式:

S1

(Mode ofoperation)
- 工作环境:

-40℃~+65℃,0%~95% RH

(Operation Temperature)
- 储存环境:

-40℃~+65℃,0%~95% RH

(Storage Temperature)
- 功能选择:

Impedance Protected / Thermal control

(Available Features)
- 振动:

风机振动速度有效值按照JB/T8689标准规定

(Vibration of the fan)
- 防护等级:

电机的防护等级为IP44

(Type of protection)



技术参数 / TECHNICAL DATA

型号 Model	Freq 频率	Bearing System 轴承		Rated Voltage 额定电压	Rated Current 额定电流	Input Power 功率	Rated Speed 额定速度	Air Flow 风量	Air Pressure 风压	Noise Level 噪音	Weight 重量
	Hz	Ball	Sleeve	VAC	A	W	RPM	m³/H	Pa	dBA	g
ZN225/88B-AC220P	50	•		230	0.60	135	2650	1200	575	71	2360

(注：以上数据仅供参考，其他参数支持定制)

外观尺寸 / DIMENSIONS DRAWING

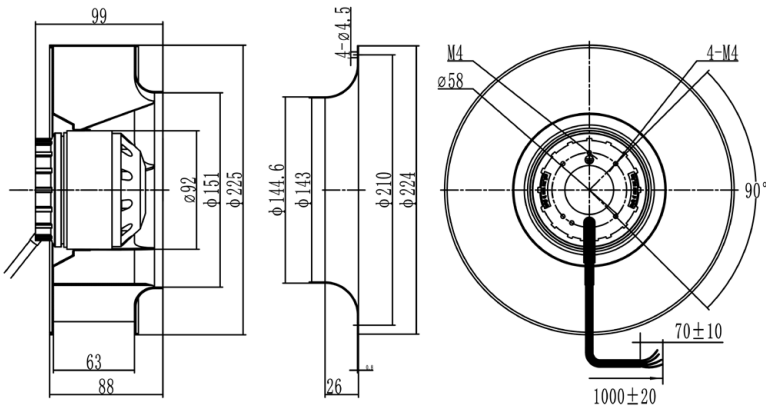

曲线 / P&Q CURVE(AT RATED VOLTAGE)

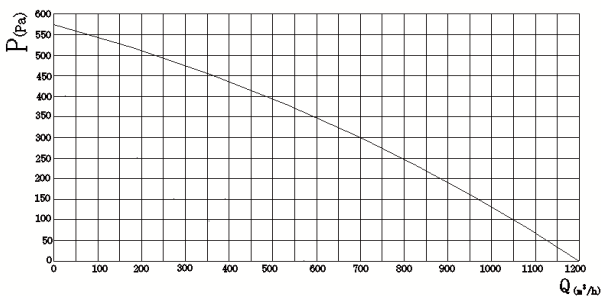

通用规范 / GENERAL SPECIFICATIONS

- 绝缘等级:

Class B

(Insuation)
- 材质:

Impeller: Steel; Frame:Aluminum Alloy

(Material)
- 线材:

UL Type

(Lead Wire)
- 工作模式:

S1

(Mode ofoperation)
- 工作环境:

-40℃~+65℃,0%~95% RH

(Operation Temperature)
- 储存环境:

-40℃~+65℃,0%~95% RH

(Storage Temperature)
- 功能选择:

Impedance Protected / Thermal control

(Available Features)
- 振动:

风机振动速度有效值按照JB/T8689标准规定

(Vibration of the fan)
- 防护等级:

电机的防护等级为IP44

(Type of protection)



技术参数 / TECHNICAL DATA

型号 Model	Freq 频率	Bearing System 轴承		Rated Voltage 额定电压	Rated Current 额定电流	Input Power 功率	Rated Speed 额定速度	Air Flow 风量	Air Pressure 风压	Noise Level 噪音	Weight 重量
	Hz	Ball	Sleeve	VAC	A	W	RPM	m³/H	Pa	dBA	g
ZN225/76A-AC220M	50	•		230	0.60	135	2700	1300	650	73	2630

(注：以上数据仅供参考，其他参数支持定制)

外观尺寸 / DIMENSIONS DRAWING

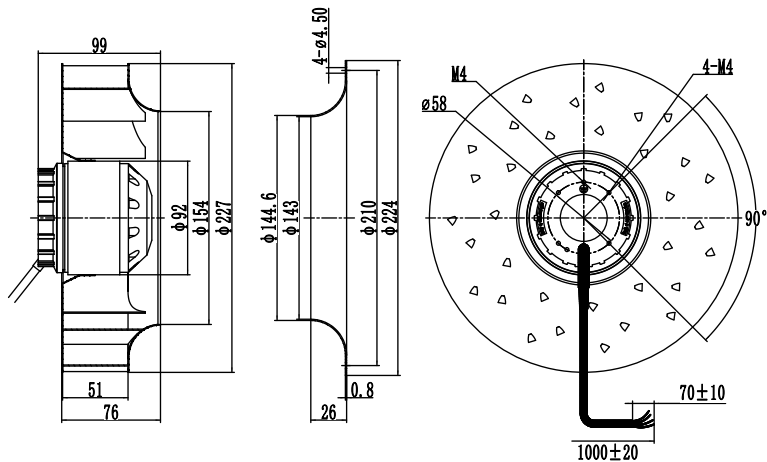

曲线 / P&Q CURVE(AT RATED VOLTAGE)

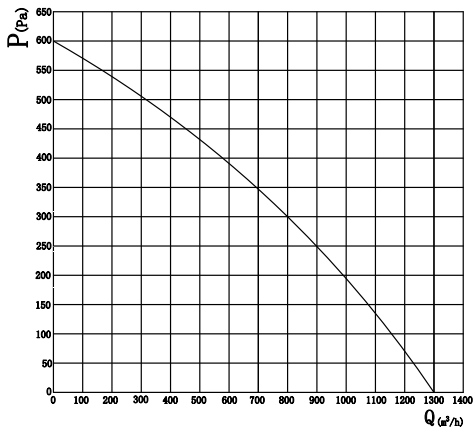

通用规范 / GENERAL SPECIFICATIONS

- 绝缘等级:

Class B

(Insuation)
- 材质:

Impeller: Steel; Frame:Aluminum Alloy

(Material)
- 线材:

UL Type

(Lead Wire)
- 工作模式:

S1

(Mode ofoperation)
- 工作环境:

-40℃~+65℃,0%~95% RH

(Operation Temperature)
- 储存环境:

-40℃~+65℃,0%~95% RH

(Storage Temperature)
- 功能选择:

Impedance Protected / Thermal control

(Available Features)
- 振动:

风机振动速度有效值按照JB/T8689标准规定

(Vibration of the fan)
- 防护等级:

电机的防护等级为IP44

(Type of protection)



技术参数 / TECHNICAL DATA

型号 Model	Freq 频率	Bearing System 轴承		Rated Voltage 额定电压	Rated Current 额定电流	Input Power 功率	Rated Speed 额定速度	Air Flow 风量	Air Pressure 风压	Noise Level 噪音	Weight 重量
	Hz	Ball	Sleeve	VAC	A	W	RPM	m³/H	Pa	dBA	g
ZN250/80B-AC220M	50	•		230	0.78	175	2690	1680	675	73	3040

(注：以上数据仅供参考，其他参数支持定制)

外观尺寸 / DIMENSIONS DRAWING

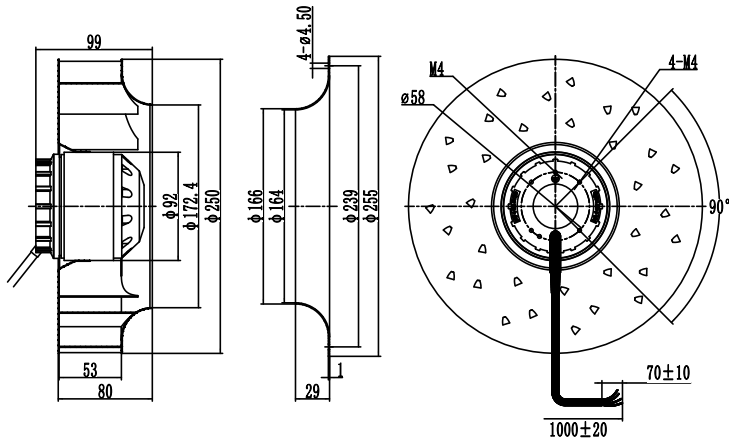

曲线 / P&Q CURVE(AT RATED VOLTAGE)

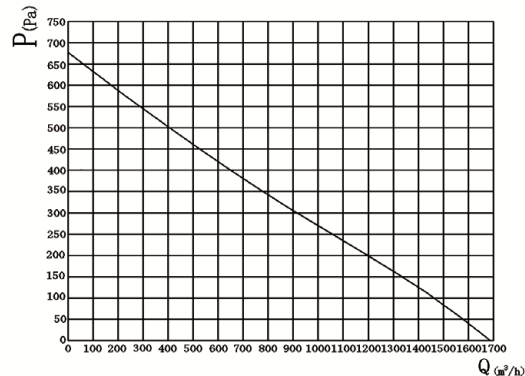

通用规范 / GENERAL SPECIFICATIONS

- 绝缘等级:

Class B

(Insuation)
- 材质:

Impeller: Steel; Frame:Aluminum Alloy

(Material)
- 线材:

UL Type

(Lead Wire)
- 工作模式:

S1

(Mode ofoperation)
- 工作环境:

-40℃~+65℃,0%~95% RH

(Operation Temperature)
- 储存环境:

-40℃~+65℃,0%~95% RH

(Storage Temperature)
- 功能选择:

Impedance Protected / Thermal control

(Available Features)
- 振动:

风机振动速度有效值按照JB/T8689标准规定

(Vibration of the fan)
- 防护等级:

电机的防护等级为IP44

(Type of protection)



技术参数 / TECHNICAL DATA

型号 Model	Freq 频率	Bearing System 轴承		Rated Voltage 额定电压	Rated Current 额定电流	Input Power 功率	Rated Speed 额定速度	Air Flow 风量	Air Pressure 风压	Noise Level 噪音	Weight 重量
	Hz	Ball	Sleeve	VAC	A	W	RPM	m³/H	Pa	dBA	g
ZN280/80A-AC220M	50	•		230	1.0	240	2480	1640	640	80	3190

(注：以上数据仅供参考，其他参数支持定制)

外观尺寸 / DIMENSIONS DRAWING

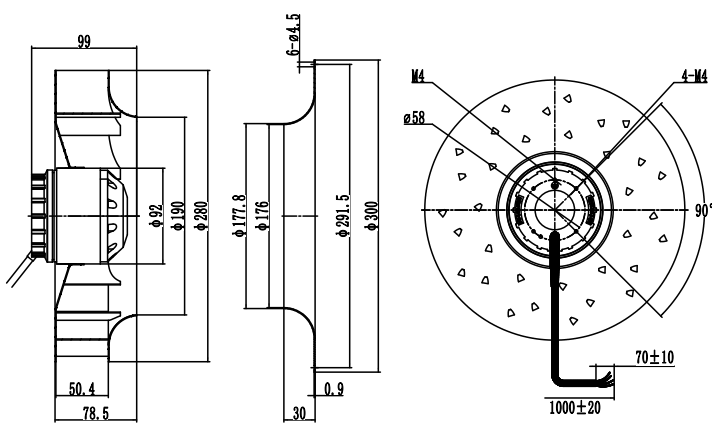

曲线 / P&Q CURVE(AT RATED VOLTAGE)

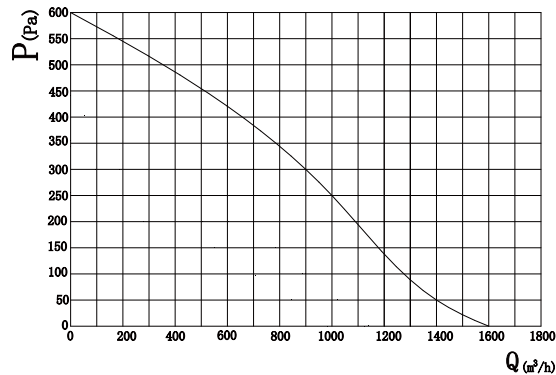

PRODUCT INTRODUCTION

离心风机

前倾离心风机命名定义

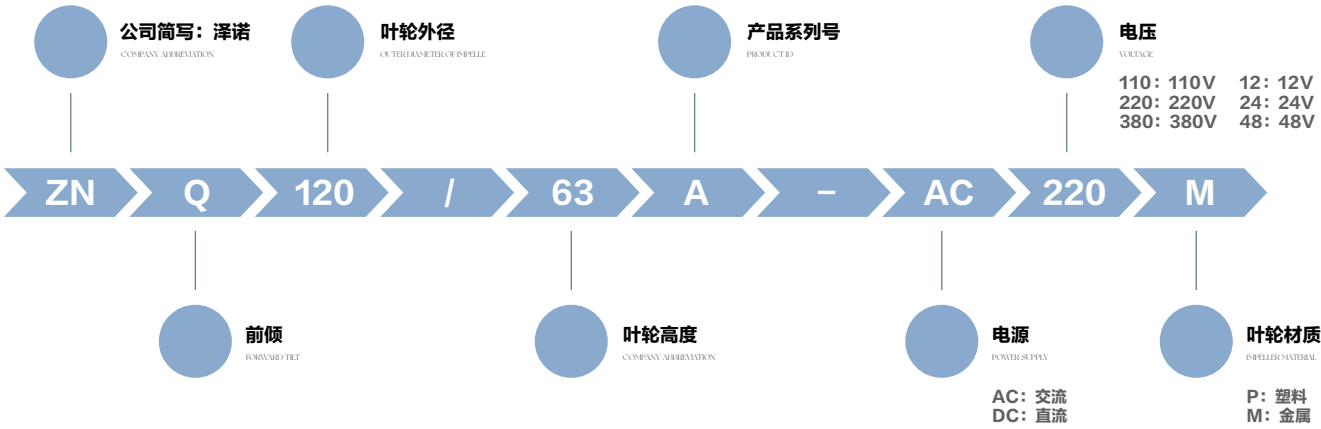

通用规范 / GENERAL SPECIFICATIONS

- 绝缘等级: Class B
(Insulation)
- 材质: Impeller: Steel; Frame: Aluminum Alloy
(Material)
- 线材: UL Type
(Lead Wire)
- 工作模式: S1
(Mode of operation)
- 工作环境: -40℃~+65℃, 0%~95% RH
(Operation Temperature)
- 储存环境: -40℃~+65℃, 0%~95% RH
(Storage Temperature)
- 功能选择: Impedance Protected / Thermal control
(Available Features)
- 振动: 风机振动速度有效值按照JB/T8689标准规定
(Vibration of the fan)
- 防护等级: 电机的防护等级为IP44
(Type of protection)



技术参数 / TECHNICAL DATA

型号 Model	Freq 频率	Bearing System 轴承		Rated Voltage 额定电压	Rated Current 额定电流	Input Power 功率	Rated Speed 额定速度	Air Flow 风量	Air Pressure 风压	Noise Level 噪音	Weight 重量
	Hz	Ball	Sleeve	VAC	A	W	RPM	m³/H	Pa	dBA	g
ZNQ120/63A-AC220M	50	•		220	0.30	65	2742	250	350	60	1420

(注: 以上数据仅供参考, 其他参数支持定制)

外观尺寸 / DIMENSIONS DRAWING

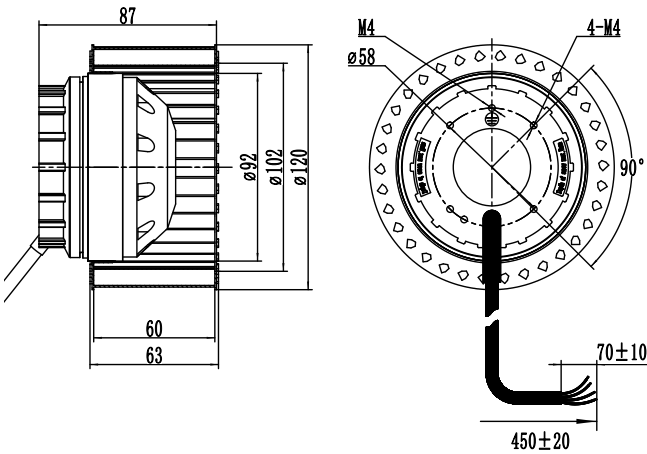

曲线 / P&Q CURVE (AT RATED VOLTAGE)

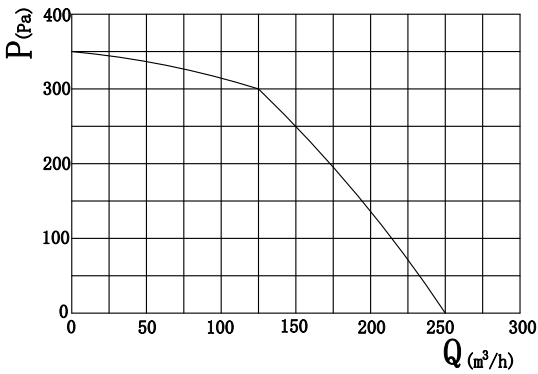

通用规范 / GENERAL SPECIFICATIONS

- 绝缘等级:

Class B

(Insuation)
- 材质:

Impeller: Steel; Frame:Aluminum Alloy

(Material)
- 线材:

UL Type

(Lead Wire)
- 工作模式:

S1

(Mode ofoperation)
- 工作环境:

-40℃~+65℃,0%~95% RH

(Operation Temperature)
- 储存环境:

-40℃~+65℃,0%~95% RH

(Storage Temperature)
- 功能选择:

Impedance Protected / Thermal control

(Available Features)
- 振动:

风机振动速度有效值按照JB/T8689标准规定

(Vibration of the fan)
- 防护等级:

电机的防护等级为IP44

(Type of protection)



技术参数 / TECHNICAL DATA

型号 Model	Freq 频率	Bearing System 轴承		Rated Voltage 额定电压	Rated Current 额定电流	Input Power 功率	Rated Speed 额定速度	Air Flow 风量	Air Pressure 风压	Noise Level 噪音	Weight 重量
	Hz	Ball	Sleeve	VAC	A	W	RPM	m³/H	Pa	dBA	g
ZNQ133/73A-AC220M	50	•		220	0.35	75	2402	310	500	65	1370

(注：以上数据仅供参考，其他参数支持定制)

外观尺寸 / DIMENSIONS DRAWING

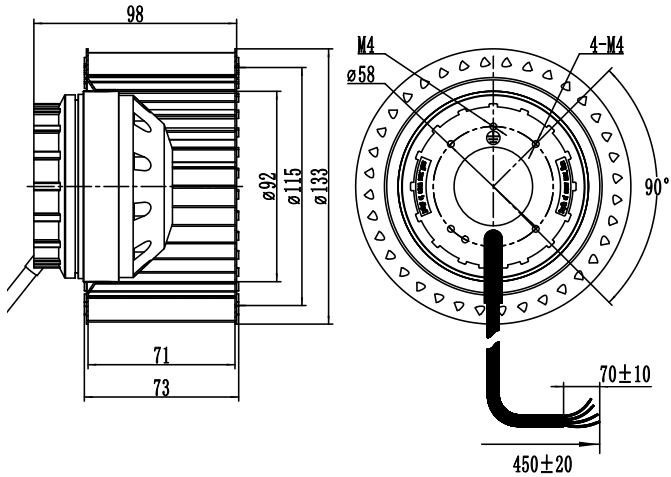

曲线 / P&Q CURVE(AT RATED VOLTAGE)

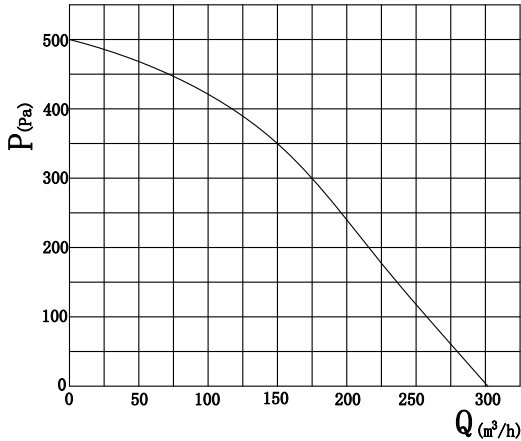

通用规范 / GENERAL SPECIFICATIONS

- 绝缘等级:

Class B

(Insuation)
- 材质:

Impeller: Steel; Frame:Aluminum Alloy

(Material)
- 线材:

UL Type

(Lead Wire)
- 工作模式:

S1

(Mode ofoperation)
- 工作环境:

-40℃~+65℃,0%~95% RH

(Operation Temperature)
- 储存环境:

-40℃~+65℃,0%~95% RH

(Storage Temperature)
- 功能选择:

Impedance Protected / Thermal control

(Available Features)
- 振动:

风机振动速度有效值按照JB/T8689标准规定

(Vibration of the fan)
- 防护等级:

电机的防护等级为IP44

(Type of protection)



技术参数 / TECHNICAL DATA

型号 Model	Freq 频率	Bearing System 轴承		Rated Voltage 额定电压	Rated Current 额定电流	Input Power 功率	Rated Speed 额定速度	Air Flow 风量	Air Pressure 风压	Noise Level 噪音	Weight 重量
	Hz	Ball	Sleeve	VAC	A	W	RPM	m³/H	Pa	dBA	g
ZNQ140/60A-AC220M	50	•		220	0.35	75	2487	350	390	64	1420

(注：以上数据仅供参考，其他参数支持定制)

外观尺寸 / DIMENSIONS DRAWING

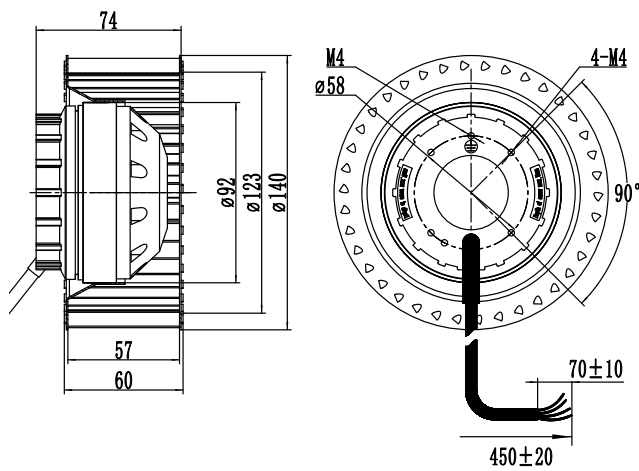

曲线 / P&Q CURVE(AT RATED VOLTAGE)

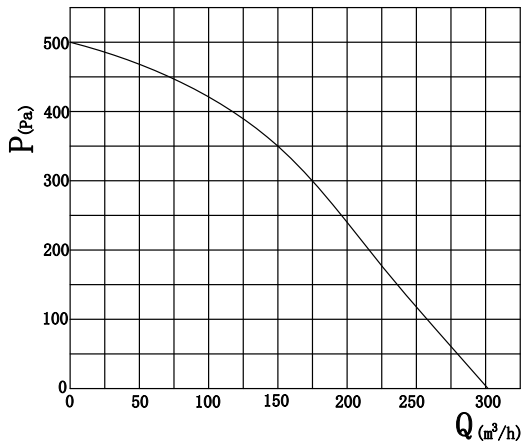

通用规范 / GENERAL SPECIFICATIONS

- 绝缘等级:

Class B

(Insuation)
- 材质:

Impeller: Steel; Frame:Aluminum Alloy

(Material)
- 线材:

UL Type

(Lead Wire)
- 工作模式:

S1

(Mode ofoperation)
- 工作环境:

-40℃~+65℃,0%~95% RH

(Operation Temperature)
- 储存环境:

-40℃~+65℃,0%~95% RH

(Storage Temperature)
- 功能选择:

Impedance Protected / Thermal control

(Available Features)
- 振动:

风机振动速度有效值按照JB/T8689标准规定

(Vibration of the fan)
- 防护等级:

电机的防护等级为IP44

(Type of protection)



技术参数 / TECHNICAL DATA

型号 Model	Freq 频率	Bearing System 轴承		Rated Voltage 额定电压	Rated Current 额定电流	Input Power 功率	Rated Speed 额定速度	Air Flow 风量	Air Pressure 风压	Noise Level 噪音	Weight 重量
	Hz	Ball	Sleeve	VAC	A	W	RPM	m³/H	Pa	dBA	g
ZNQ150/70A-AC220M	50	•		220	0.60	130	2635	490	650	65	2320

(注：以上数据仅供参考，其他参数支持定制)

外观尺寸 / DIMENSIONS DRAWING

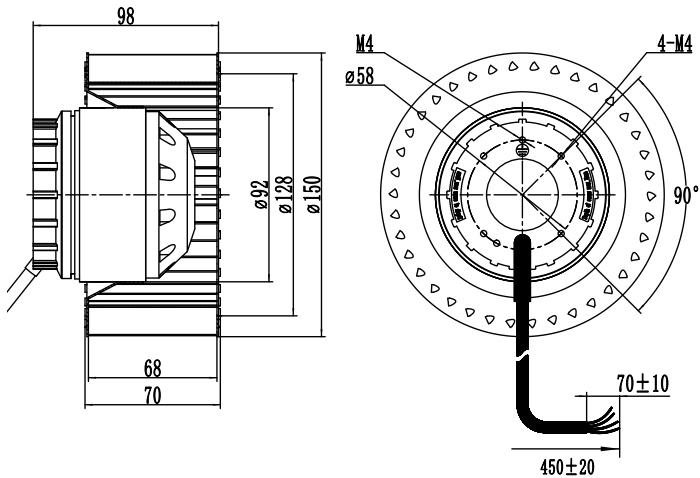

曲线 / P&Q CURVE(AT RATED VOLTAGE)

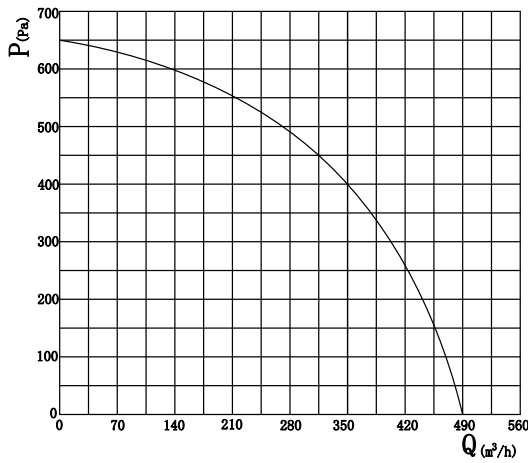

通用规范 / GENERAL SPECIFICATIONS

- 绝缘等级:

Class B

(Insuation)
- 材质:

Impeller: Steel; Frame:Aluminum Alloy

(Material)
- 线材:

UL Type

(Lead Wire)
- 工作模式:

S1

(Mode ofoperation)
- 工作环境:

-40℃~+65℃,0%~95% RH

(Operation Temperature)
- 储存环境:

-40℃~+65℃,0%~95% RH

(Storage Temperature)
- 功能选择:

Impedance Protected / Thermal control

(Available Features)
- 振动:

风机振动速度有效值按照JB/T8689标准规定

(Vibration of the fan)
- 防护等级:

电机的防护等级为IP44

(Type of protection)



技术参数 / TECHNICAL DATA

型号 Model	Freq 频率	Bearing System 轴承		Rated Voltage 额定电压	Rated Current 额定电流	Input Power 功率	Rated Speed 额定速度	Air Flow 风量	Air Pressure 风压	Noise Level 噪音	Weight 重量
	Hz	Ball	Sleeve	VAC	A	W	RPM	m³/H	Pa	dBA	g
ZNQ160/63A-AC220M	50	•		220	0.65	140	2562	540	550	64	2250

(注：以上数据仅供参考，其他参数支持定制)

外观尺寸 / DIMENSIONS DRAWING

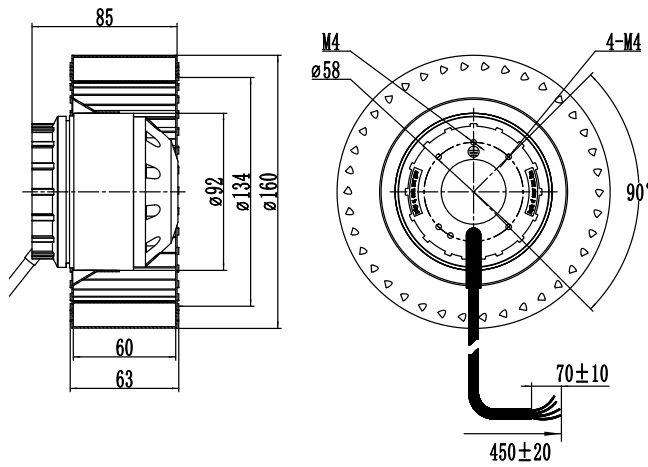

曲线 / P&Q CURVE(AT RATED VOLTAGE)

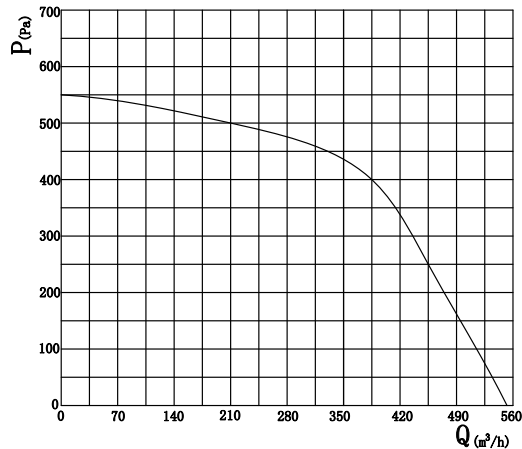

PRODUCT INTRODUCTION

轴流风机

轴流风机命名定义

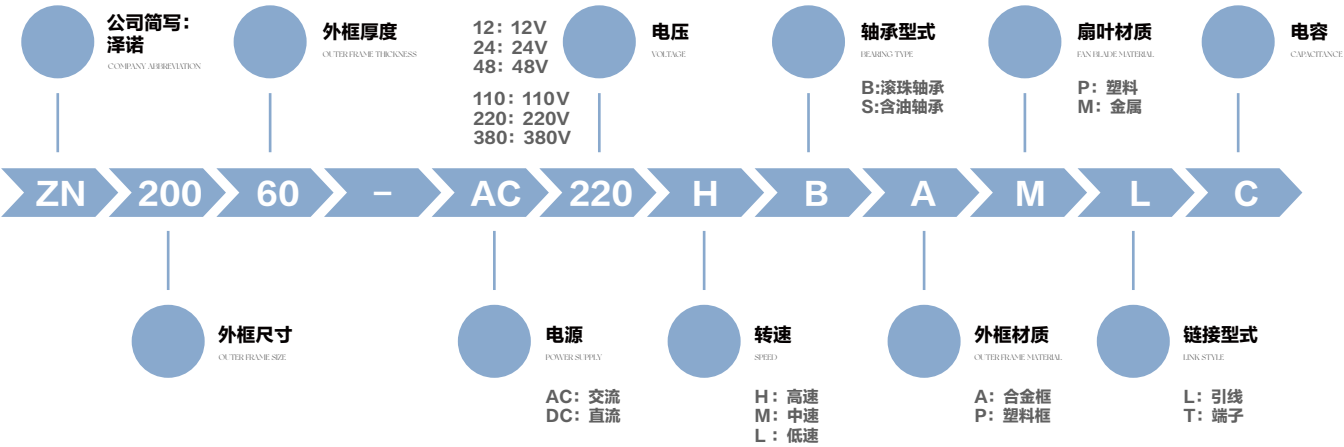

通用规范 / GENERAL SPECIFICATIONS

- 绝缘等级: Class B (Insulation)
- 材质: Impeller: Steel; Frame: Aluminum Alloy (Material)
- 线材: UL Type (Lead Wire)
- 工作模式: S1 (Mode of operation)
- 工作环境: -40℃~+70℃, 0%~95% RH (Operation Temperature)
- 储存环境: -40℃~+85℃, 0%~95% RH (Storage Temperature)
- 功能选择: Impedance Protected / Thermal control (Available Features)
- 振动: 风机振动速度有效值按照JB/T8689标准规定 (Vibration of the fan)
- 防护等级: 电机的防护等级为IP44 (Type of protection)



技术参数 / TECHNICAL DATA

型号 Model	Freq 频率	Bearing System 轴承		Rated Voltage 额定电压	Rated Voltage 额定电压	Input Power 功率	Rated Speed 额定速度	Air Flow 风量	Air Flow 风量	Air Pressure 风压	Air Pressure 风压	Noise Level 噪音	Weight 重量
	Hz	Ball	Sleeve	VAC	A	W	RPM	CFM	m³/min	mmH₂O	Pa	dBA	g
ZN20060-AC220HBAMLC	50	•		230	0.21	42	2700	420	11.9	17.3	170	60	1300

(注: 以上数据仅供参考, 其他参数支持定制)

外观尺寸 / DIMENSIONS DRAWING

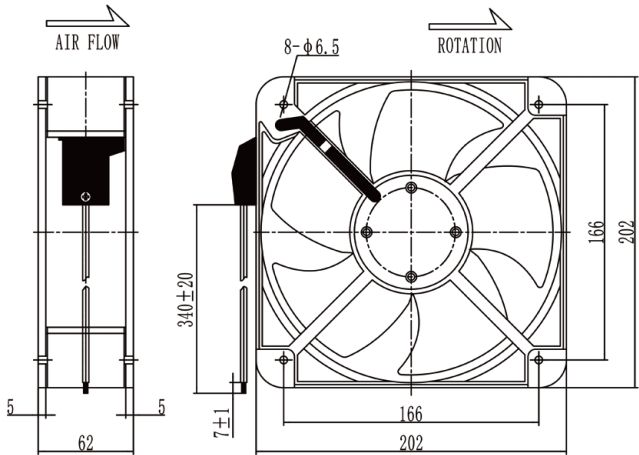

曲线 / P&Q CURVE (AT RATED VOLTAGE)

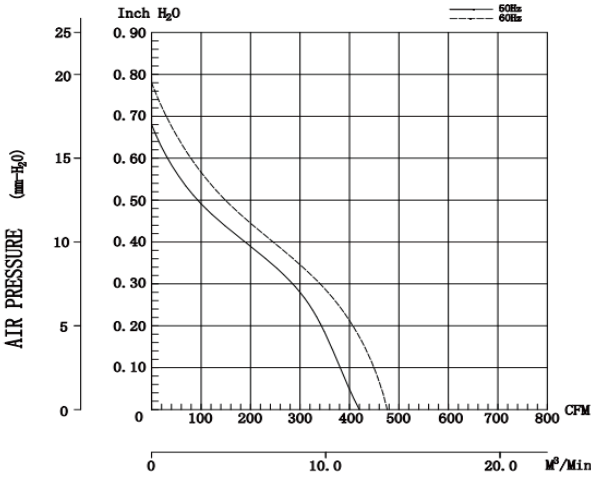

通用规范 / GENERAL SPECIFICATIONS

- 绝缘等级:

Class B

(Insuation)
- 材质:

Impeller:Steel; Frame:Aluminum Alloy

(Material)
- 线材:

UL Type

(Lead Wire)
- 工作模式:

S1

(Mode ofoperation)
- 工作环境:

-40℃~+70℃,0%~95% RH

(Operation Temperature)
- 储存环境:

-40℃~+85℃,0%~95% RH

(Storage Temperature)
- 功能选择:

Impedance Protected / Thermal control

(Available Features)
- 振动:

风机振动速度有效值按照JB/T8689标准规定

(Vibration of the fan)
- 防护等级:

电机的防护等级为IP44

(Type of protection)



技术参数 / TECHNICAL DATA

型号 Model	Freq 频率	Bearing System 轴承		Rated Voltage 额定电压	Rated Voltage 额定电流	Input Power 功率	Rated Speed 额定速度	Air Flow 风量	Air Flow 风量	Air Pressure 风压	Air Pressure 风压	Noise Level 噪音	Weight 重量
	Hz	Ball	Sleeve	VAC	A	W	RPM	CFM	m³/min	mmH₂O	Pa	dBA	g
ZN22060-AC220HBAMLC	50	•		230	0.21	42	2700	420	11.9	17.3	170	60	1300

(注：以上数据仅供参考，其他参数支持定制)

外观尺寸 / DIMENSIONS DRAWING

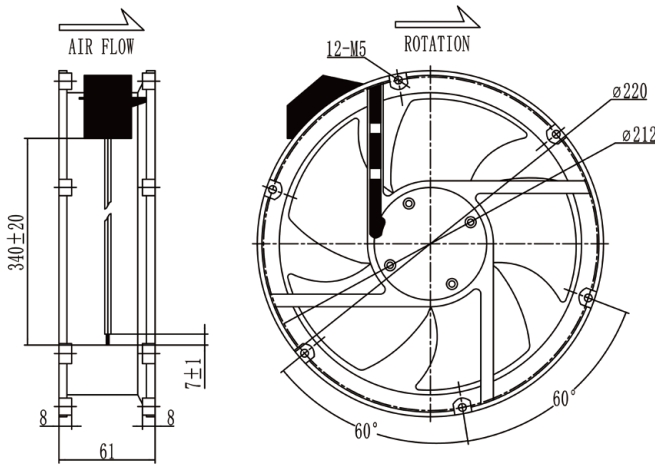

曲线 / P&Q CURVE(AT RATED VOLTAGE)

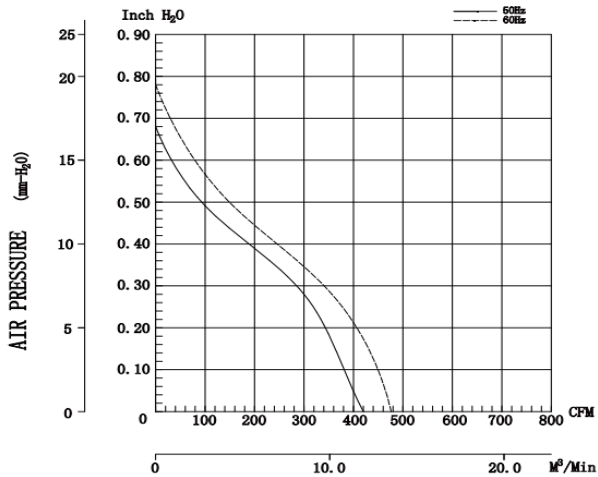

通用规范 / GENERAL SPECIFICATIONS

- 绝缘等级:

Class B

(Insuation)
- 材质:

Impeller:Steel; Frame:Aluminum Alloy

(Material)
- 线材:

UL Type

(Lead Wire)
- 工作模式:

S1

(Mode ofoperation)
- 工作环境:

-40℃~+70℃,0%~95% RH

(Operation Temperature)
- 储存环境:

-40℃~+85℃,0%~95% RH

(Storage Temperature)
- 功能选择:

Impedance Protected / Thermal control

(Available Features)
- 振动:

风机振动速度有效值按照JB/T8689标准规定

(Vibration of the fan)
- 防护等级:

电机的防护等级为IP44

(Type of protection)



技术参数 / TECHNICAL DATA

型号 Model	Freq 频率	Bearing System 轴承		Rated Voltage 额定电压	Rated Voltage 额定电流	Input Power 功率	Rated Speed 额定速度	Air Flow 风量	Air Flow 风量	Air Pressure 风压	Air Pressure 风压	Noise Level 噪音	Weight 重量
	Hz	Ball	Sleeve	VAC	A	W	RPM	CFM	m³/min	mmH₂O	Pa	dBA	g
ZN22580-AC220HBAMLC	50	•		230	0.35	75	2600	530	15	17	167	58	2160

(注：以上数据仅供参考，其他参数支持定制)

外观尺寸 / DIMENSIONS DRAWING

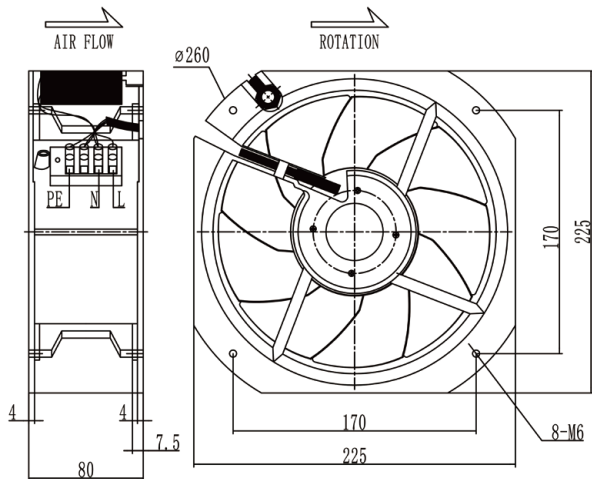

曲线 / P&Q CURVE(AT RATED VOLTAGE)

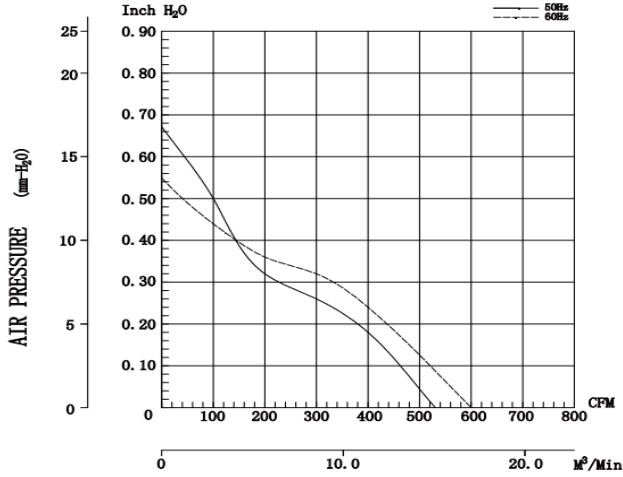

通用规范 / GENERAL SPECIFICATIONS

- 绝缘等级:

Class B

(Insuation)
- 材质:

Impeller:Steel; Frame:Aluminum Alloy

(Material)
- 线材:

UL Type

(Lead Wire)
- 工作模式:

S1

(Mode ofoperation)
- 工作环境:

-40℃~+70℃,0%~95% RH

(Operation Temperature)
- 储存环境:

-40℃~+85℃,0%~95% RH

(Storage Temperature)
- 功能选择:

Impedance Protected / Thermal control

(Available Features)
- 振动:

风机振动速度有效值按照JB/T8689标准规定

(Vibration of the fan)
- 防护等级:

电机的防护等级为IP44

(Type of protection)



技术参数 / TECHNICAL DATA

型号 Model	Freq 频率	Bearing System 轴承		Rated Voltage 额定电压	Rated Voltage 额定电压	Input Power 功率	Rated Speed 额定速度	Air Flow 风量	Air Flow 风量	Air Pressure 风压	Air Pressure 风压	Noise Level 噪音	Weight 重量
	Hz	Ball	Sleeve	VAC	A	W	RPM	CFM	m³/min	mmH₂O	Pa	dBA	g
ZN25489-AC220HBAMLC	50	•		230	0.36	80	2600	760	21.5	19.8	195	75	2200

(注：以上数据仅供参考，其他参数支持定制)

外观尺寸 / DIMENSIONS DRAWING

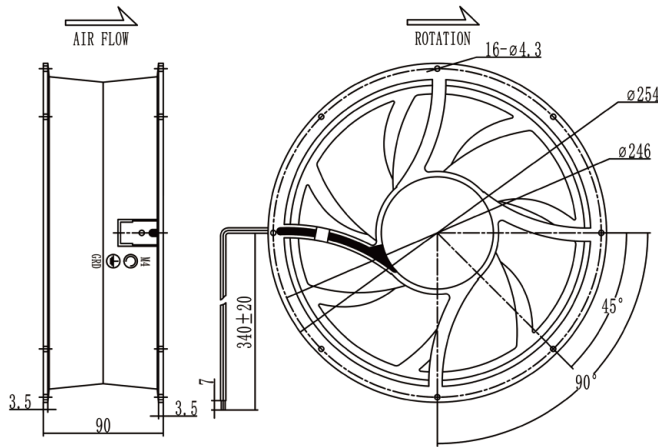

曲线 / P&Q CURVE(AT RATED VOLTAGE)

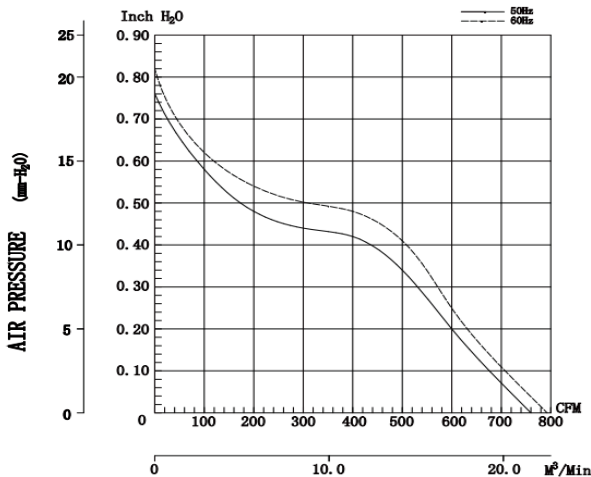

通用规范 / GENERAL SPECIFICATIONS

- 绝缘等级:

Class B

(Insuation)
- 材质:

Impeller:Steel; Frame:Aluminum Alloy

(Material)
- 线材:

UL Type

(Lead Wire)
- 工作模式:

S1

(Mode ofoperation)
- 工作环境:

-40℃~+70℃,0%~95% RH

(Operation Temperature)
- 储存环境:

-40℃~+85℃,0%~95% RH

(Storage Temperature)
- 功能选择:

Impedance Protected / Thermal control

(Available Features)
- 振动:

风机振动速度有效值按照JB/T8689标准规定

(Vibration of the fan)
- 防护等级:

电机的防护等级为IP44

(Type of protection)



技术参数 / TECHNICAL DATA

型号 Model	Freq 频率	Bearing System 轴承		Rated Voltage 额定电压	Rated Voltage 额定电压	Input Power 功率	Rated Speed 额定速度	Air Flow 风量	Air Flow 风量	Air Pressure 风压	Air Pressure 风压	Noise Level 噪音	Weight 重量
	Hz	Ball	Sleeve	VAC	A	W	RPM	CFM	m³/min	mmH₂O	Pa	dBA	g
ZN28080-AC220HBAMLC	50	•		230	0.55	120	2700	1090	30.9	19.8	195	68	2850

(注：以上数据仅供参考，其他参数支持定制)

外观尺寸 / DIMENSIONS DRAWING

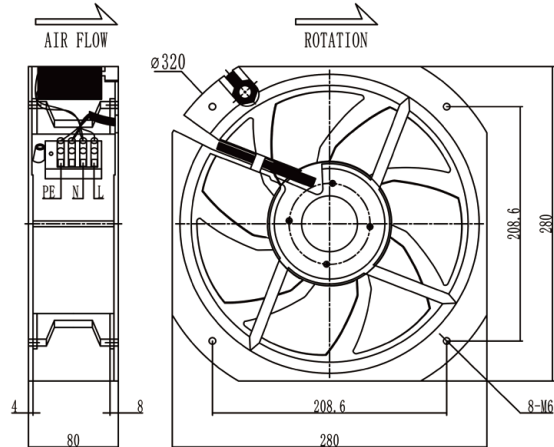

曲线 / P&Q CURVE(AT RATED VOLTAGE)

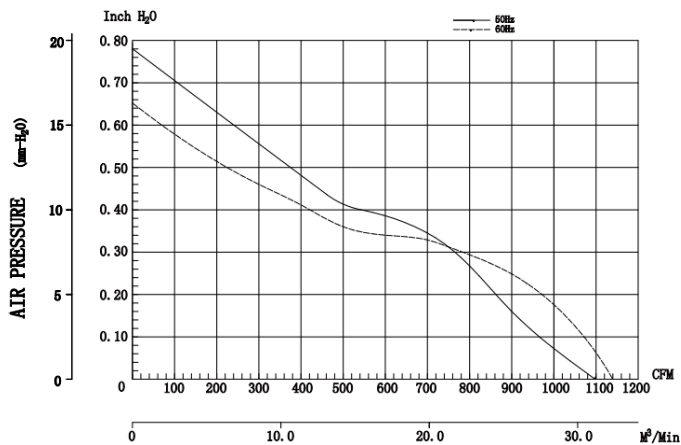

通用规范 / GENERAL SPECIFICATIONS

- 绝缘等级:

Class B

(Insuation)
- 材质:

Impeller: Plastic; Frame:Aluminum Alloy

(Material)
- 线材:

UL Type

(Lead Wire)
- 工作模式:

S1

(Mode ofoperation)
- 工作环境:

-10℃~70℃,35%~85% RH

(Operation Temperature)
- 储存环境:

-40℃~80℃,35%~85% RH

(Storage Temperature)
- 功能选择:

Thermal control

(Available Features)
- 振动:

风机振动速度有效值按照JB/T8689标准规定

(Vibration of the fan)
- 防护等级:

电机的防护等级为IP44

(Type of protection)



技术参数 / TECHNICAL DATA

型号 Model	Freq 频率	Bearing System 轴承		Rated Voltage 额定电压	Rated Current 额定电流	Input Power 功率	Rated Speed 额定速度	Air Flow 风量	Air Pressure 风压	Noise Level 噪音	Weight 重量
	Hz	Ball	Sleeve	VAC	A	W	RPM	CFM	mmH ₂ O	dBA	g
ZN8025-AC110HBAPL	50/60	•	•	110~125	0.15	17/15	2600/3000	21/24	4.0/5.5	33/55	240
ZN8025-AC110MBAPL	50/60	•	•	110~125	0.10	13/10	2300/2600	18/21	2.9/3.4	29/33	240
ZN8025-AC220HBAPL	50/60	•	•	200~240	0.08	17/15	2600/3000	21/24	4.0/5.5	33/35	240
ZN8025-AC220MBAPL	50/60	•	•	200~240	0.05	13/10	2300/2600	18/21	2.9/3.4	29/33	240

外观尺寸 / DIMENSIONS DRAWING

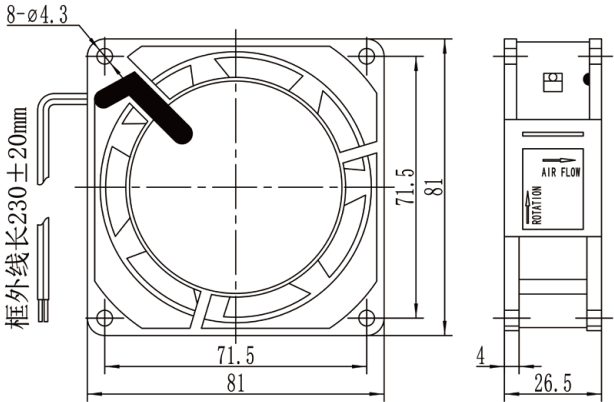

曲线 / P&Q CURVE(AT RATED VOLTAGE)

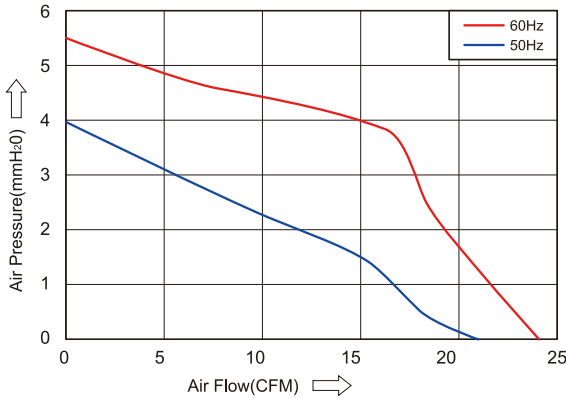

通用规范 / GENERAL SPECIFICATIONS

- 绝缘等级:

Class B

(Insuation)
- 材质:

Impeller: Plastic; Frame:Aluminum Alloy

(Material)
- 线材:

UL Type

(Lead Wire)
- 工作模式:

S1

(Mode ofoperation)
- 工作环境:

-10℃~70℃,35%~85% RH

(Operation Temperature)
- 储存环境:

-40℃~80℃,35%~85% RH

(Storage Temperature)
- 功能选择:

Thermal control

(Available Features)
- 振动:

风机振动速度有效值按照JB/T8689标准规定

(Vibration of the fan)
- 防护等级:

电机的防护等级为IP44

(Type of protection)



技术参数 / TECHNICAL DATA

型号 Model	Freq 频率	Bearing System 轴承		Rated Voltage 额定电压	Rated Current 额定电流	Input Power 功率	Rated Speed 额定速度	Air Flow 风量	Air Pressure 风压	Noise Level 噪音	Weight 重量
	Hz	Ball	Sleeve	VAC	A	W	RPM	CFM	mmH ₂ O	dBA	g
ZN8038-AC110HBAPL	50/60	•	•	110~125	0.15	17/15	2400/2800	23/28	2.8/4.4	34/36	290
ZN8038-AC110MBAPL	50/60	•	•	110~125	0.10	13/10	1900/2400	20/23	2.0/2.2	27/34	290
ZN8038-AC220HBAPL	50/60	•	•	200~240	0.08	17/15	2400/2800	23/28	2.8/4.4	34/36	290
ZN8038-AC220MBAPL	50/60	•	•	200~240	0.05	13/10	1900/2400	20/23	2.0/2.2	27/34	290

外观尺寸 / DIMENSIONS DRAWING

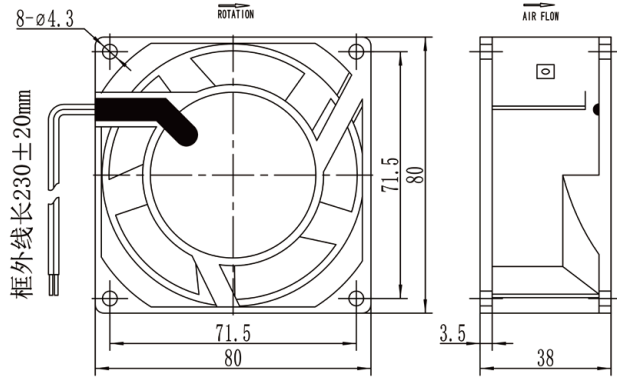

曲线 / P&Q CURVE(AT RATED VOLTAGE)

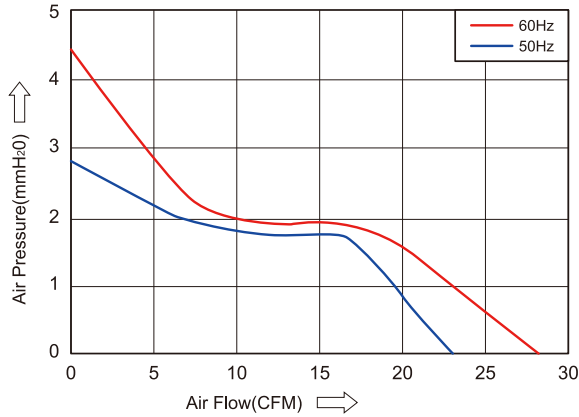

通用规范 / GENERAL SPECIFICATIONS

- 绝缘等级:

Class B

(Insuation)
- 材质:

Impeller: Plastic; Frame:Aluminum Alloy

(Material)
- 线材:

UL Type

(Lead Wire)
- 工作模式:

S1

(Mode ofoperation)
- 工作环境:

-10℃~70℃,35%~85% RH

(Operation Temperature)
- 储存环境:

-40℃~80℃,35%~85% RH

(Storage Temperature)
- 功能选择:

Thermal control

(Available Features)
- 振动:

风机振动速度有效值按照JB/T8689标准规定

(Vibration of the fan)
- 防护等级:

电机的防护等级为IP44

(Type of protection)



技术参数 / TECHNICAL DATA

型号 Model	Freq 频率	Bearing System 轴承		Rated Voltage 额定电压	Rated Current 额定电流	Input Power 功率	Rated Speed 额定速度	Air Flow 风量	Air Pressure 风压	Noise Level 噪音	Weight 重量
	Hz	Ball	Sleeve	VAC	A	W	RPM	CFM	mmH ₂ O	dBA	g
ZN9225-AC110HBAPL	50/60	•	•	110~125	0.15	17/15	2500/3000	24/29	4.5/6.5	33/35	280
ZN9225-AC110MBAPL	50/60	•	•	110~125	0.10	13/10	2200/2600	21/25	3.0/3.3	29/33	280
ZN9225-AC220HBAPL	50/60	•	•	200~240	0.08	17/15	2500/3000	24/29	4.5/6.5	33/35	280
ZN9225-AC220MBAPL	50/60	•	•	200~240	0.05	13/10	2200/2600	21/25	3.0/3.3	29/33	280

外观尺寸 / DIMENSIONS DRAWING

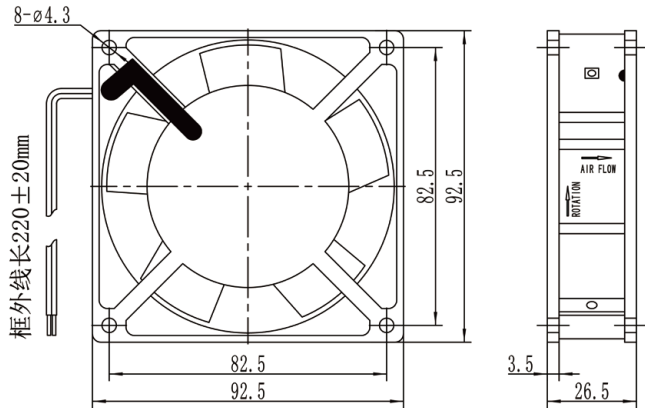

曲线 / P&Q CURVE(AT RATED VOLTAGE)

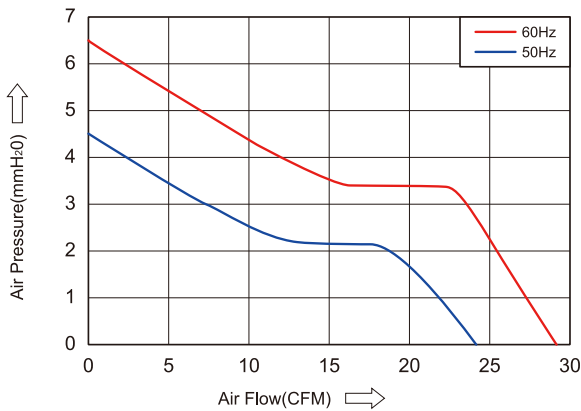

通用规范 / GENERAL SPECIFICATIONS

- 绝缘等级:

Class B

(Insuation)
- 材质:

Impeller: Plastic; Frame:Aluminum Alloy

(Material)
- 线材:

UL Type

(Lead Wire)
- 工作模式:

S1

(Mode ofoperation)
- 工作环境:

-10℃~70℃,35%~85% RH

(Operation Temperature)
- 储存环境:

-40℃~80℃,35%~85% RH

(Storage Temperature)
- 功能选择:

Thermal control

(Available Features)
- 振动:

风机振动速度有效值按照JB/T8689标准规定

(Vibration of the fan)
- 防护等级:

电机的防护等级为IP44

(Type of protection)



技术参数 / TECHNICAL DATA

型号 Model	Freq 频率	Bearing System 轴承		Rated Voltage 额定电压	Rated Current 额定电流	Input Power 功率	Rated Speed 额定速度	Air Flow 风量	Air Pressure 风压	Noise Level 噪音	Weight 重量
	Hz	Ball	Sleeve	VAC	A	W	RPM	CFM	mmH ₂ O	dBA	g
ZN9238-AC110HBAPL	50/60	•	•	110~125	0.15	17/15	2400/2800	39/46	3.6/5.2	34/36	340
ZN9238-AC110MBAPL	50/60	•	•	110~125	0.10	13/10	1900/2400	35/39	2.9/3.2	27/34	340
ZN9238-AC220HBAPL	50/60	•	•	200~240	0.08	17/15	2400/2800	39/46	3.6/5.2	34/36	340
ZN9238-AC220MBAPL	50/60	•	•	200~240	0.05	13/10	1900/2400	35/39	2.9/3.2	27/34	340

外观尺寸 / DIMENSIONS DRAWING

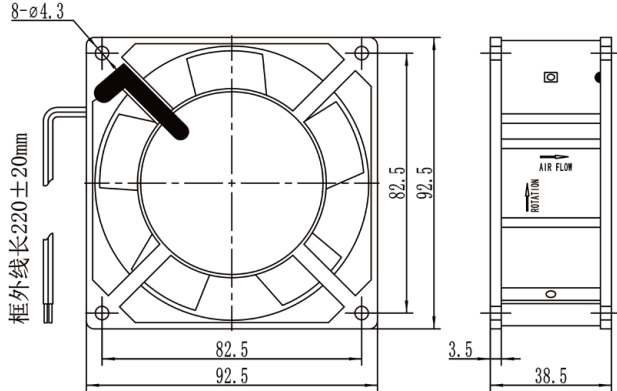

曲线 / P&Q CURVE(AT RATED VOLTAGE)

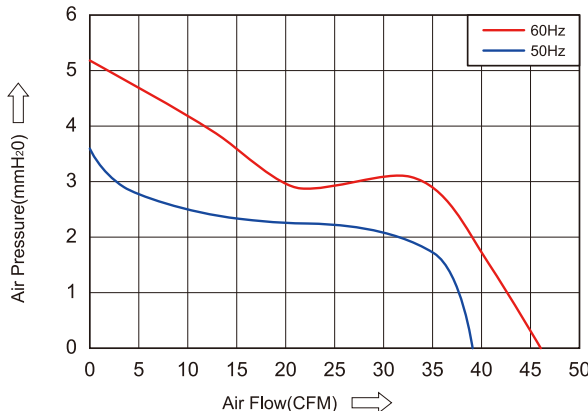

通用规范 / GENERAL SPECIFICATIONS

- 绝缘等级:

Class B

(Insuation)
- 材质:

Impeller: Plastic; Frame:Aluminum Alloy

(Material)
- 线材:

UL Type

(Lead Wire)
- 工作模式:

S1

(Mode ofoperation)
- 工作环境:

-10℃~70℃,35%~85% RH

(Operation Temperature)
- 储存环境:

-40℃~80℃,35%~85% RH

(Storage Temperature)
- 功能选择:

Thermal control

(Available Features)
- 振动:

风机振动速度有效值按照JB/T8689标准规定

(Vibration of the fan)
- 防护等级:

电机的防护等级为IP44

(Type of protection)



技术参数 / TECHNICAL DATA

型号 Model	Freq 频率	Bearing System 轴承		Rated Voltage 额定电压	Rated Current 额定电流	Input Power 功率	Rated Speed 额定速度	Air Flow 风量	Air Pressure 风压	Noise Level 噪音	Weight 重量
	Hz	Ball	Sleeve	VAC	A	W	RPM	CFM	mmH ₂ O	dBA	g
ZN11025-AC110HBAPL	50/60	•	•	110~125	0.15	17/15	2300/2700	39/45	3.9/4.1	35/37	300
ZN11025-AC110MBAPL	50/60	•	•	110~125	0.10	12/10	1800/2400	30/37	2.2/2.5	30/35	300
ZN11025-AC220HBAPL	50/60	•	•	200~240	0.10	17/15	2300/2700	39/45	3.9/4.1	35/37	300
ZN11025-AC220MBAPL	50/60	•	•	200~240	0.07	12/10	1800/2400	30/37	2.2/2.5	30/35	300

外观尺寸 / DIMENSIONS DRAWING

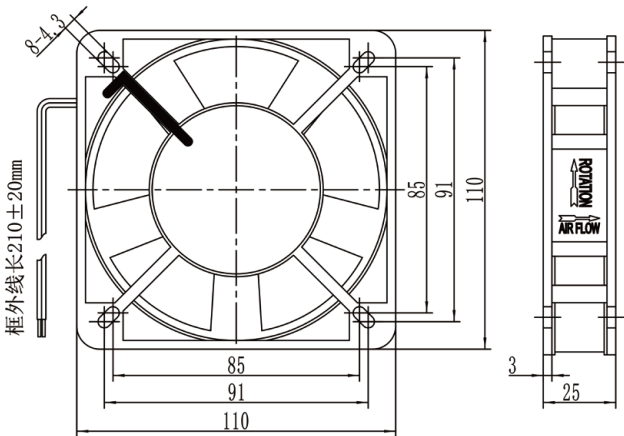

曲线 / P&Q CURVE(AT RATED VOLTAGE)

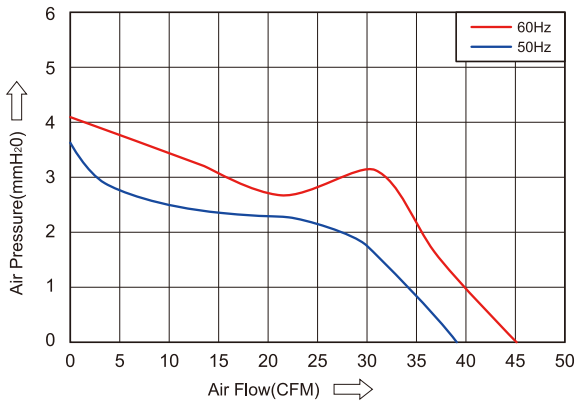

通用规范 / GENERAL SPECIFICATIONS

- 绝缘等级:

Class B

(Insuation)
- 材质:

Impeller: Plastic; Frame:Aluminum Alloy

(Material)
- 线材:

UL Type

(Lead Wire)
- 工作模式:

S1

(Mode ofoperation)
- 工作环境:

-10℃~70℃,35%~85% RH

(Operation Temperature)
- 储存环境:

-40℃~80℃,35%~85% RH

(Storage Temperature)
- 功能选择:

Thermal control

(Available Features)
- 振动:

风机振动速度有效值按照JB/T8689标准规定

(Vibration of the fan)
- 防护等级:

电机的防护等级为IP44

(Type of protection)



技术参数 / TECHNICAL DATA

型号 Model	Freq 频率	Bearing System 轴承		Rated Voltage 额定电压	Rated Current 额定电流	Input Power 功率	Rated Speed 额定速度	Air Flow 风量	Air Pressure 风压	Noise Level 噪音	Weight 重量
	Hz	Ball	Sleeve	VAC	A	W	RPM	CFM	mmH ₂ O	dBA	g
ZN12025-AC110HBAPL	50/60	•	•	110~125	0.15	17/15	2300/2700	58/66	3.8/5.0	35/37	320
ZN12025-AC110MBAPL	50/60	•	•	110~125	0.10	12/10	1800/2400	47/60	1.8/2.0	30/35	320
ZN12025-AC220HBAPL	50/60	•	•	200~240	0.08	17/15	2300/2700	58/66	3.8/5.0	35/37	320
ZN12025-AC220MBAPL	50/60	•	•	200~240	0.05	12/10	1800/2400	47/60	1.8/2.0	30/35	320

外观尺寸 / DIMENSIONS DRAWING

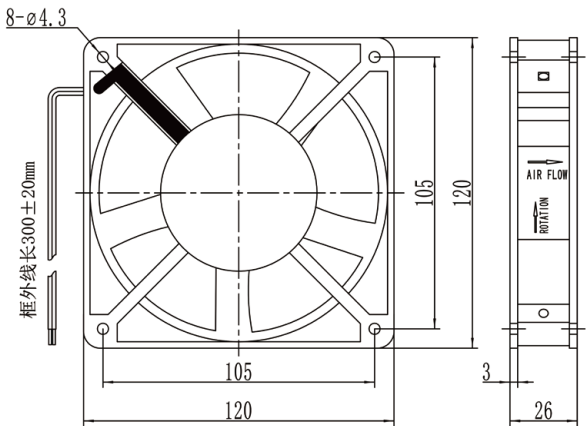

曲线 / P&Q CURVE(AT RATED VOLTAGE)

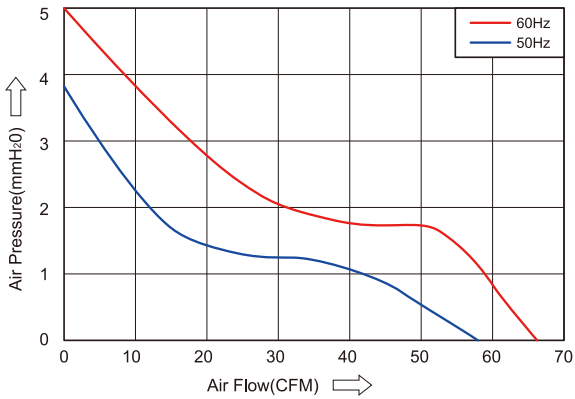

通用规范 / GENERAL SPECIFICATIONS

- 绝缘等级:

Class B

(Insuation)
- 材质:

Impeller: Plastic; Frame:Aluminum Alloy

(Material)
- 线材:

UL Type

(Lead Wire)
- 工作模式:

S1

(Mode ofoperation)
- 工作环境:

-10℃~70℃,35%~85% RH

(Operation Temperature)
- 储存环境:

-40℃~80℃,35%~85% RH

(Storage Temperature)
- 功能选择:

Thermal control

(Available Features)
- 振动:

风机振动速度有效值按照JB/T8689标准规定

(Vibration of the fan)
- 防护等级:

电机的防护等级为IP44

(Type of protection)



技术参数 / TECHNICAL DATA

型号 Model	Freq 频率	Bearing System 轴承		Rated Voltage 额定电压	Rated Current 额定电流	Input Power 功率	Rated Speed 额定速度	Air Flow 风量	Air Pressure 风压	Noise Level 噪音	Weight 重量
	Hz	Ball	Sleeve	VAC	A	W	RPM	CFM	mmH ₂ O	dBA	g
ZN12038-AC110HBAPL	50/60	•	•	110~125	0.22	23/21	2600/3000	80/91	6.8/8.5	42/46	530
ZN12038-AC110MBAPL	50/60	•	•	110~125	0.15	15/14	2400/2700	72/83	5.1/6.8	39/42	530
ZN12038-AC110LBAPL	50/60	•	•	110~125	0.10	10/9	2100/2400	66/72	3.2/5.1	35/39	530
ZN12038-AC220HBAPL	50/60	•	•	200~240	0.16	23/21	2600/3000	80/91	6.8/8.5	42/46	530
ZN12038-AC220MBAPL	50/60	•	•	200~240	0.14	15/14	2400/2700	72/83	5.1/6.8	39/42	530
ZN12038-AC220LBAPL	50/60	•	•	200~240	0.10	10/9	2100/2400	66/72	3.2/5.1	35/39	530
ZN12038-AC380HBAPL	50/60	•	•	380	0.06	23/21	2600/3000	80/91	6.8/8.5	42/46	530

外观尺寸 / DIMENSIONS DRAWING

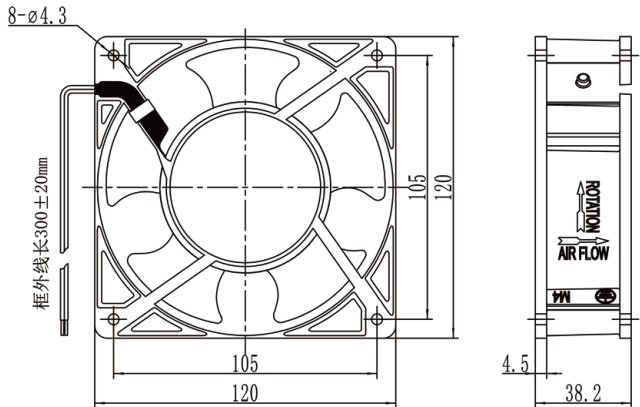

曲线 / P&Q CURVE(AT RATED VOLTAGE)

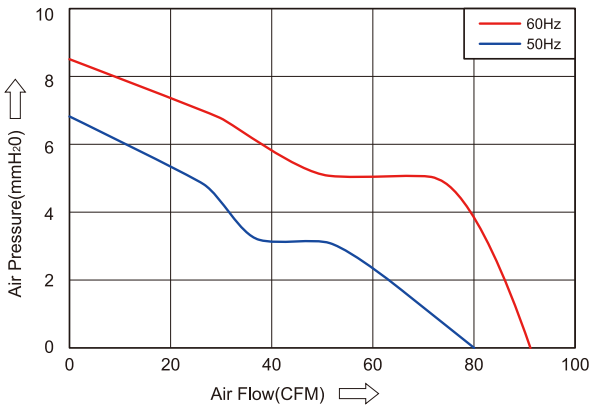

通用规范 / GENERAL SPECIFICATIONS

- 绝缘等级:

Class B

(Insuation)
- 材质:

Impeller: Plastic; Frame:Aluminum Alloy

(Material)
- 线材:

UL Type

(Lead Wire)
- 工作模式:

S1

(Mode ofoperation)
- 工作环境:

-10℃~70℃,35%~85% RH

(Operation Temperature)
- 储存环境:

-40℃~80℃,35%~85% RH

(Storage Temperature)
- 功能选择:

Thermal control

(Available Features)
- 振动:

风机振动速度有效值按照JB/T8689标准规定

(Vibration of the fan)
- 防护等级:

电机的防护等级为IP44

(Type of protection)



技术参数 / TECHNICAL DATA

型号 Model	Freq 频率	Bearing System 轴承		Rated Voltage 额定电压	Rated Current 额定电流	Input Power 功率	Rated Speed 额定速度	Air Flow 风量	Air Pressure 风压	Noise Level 噪音	Weight 重量
	Hz	Ball	Sleeve	VAC	A	W	RPM	CFM	mmH ₂ O	dBA	g
ZN13538-AC110HBAPL	50/60	•	•	110~125	0.22	23/21	2600/3000	115/141	6.5/6.8	43/45	570
ZN13538-AC110MBAPL	50/60	•	•	110~125	0.18	15/14	2400/2700	107/120	4.3/5.1	41/43	570
ZN13538-AC110LBAPL	50/60	•	•	110~125	0.12	10/9	2100/2400	93/107	1.8/3.0	39/41	570
ZN13538-AC220HBAPL	50/60	•	•	200~240	0.14	23/21	2600/3000	115/141	6.5/6.8	43/45	570
ZN13538-AC220MBAPL	50/60	•	•	200~240	0.10	15/14	2400/2700	107/120	4.3/5.1	41/43	570
ZN13538-AC220LBAPL	50/60	•	•	200~240	0.07	10/9	2100/2400	93/107	1.8/3.0	39/41	570
ZN13538-AC380HBAPL	50/60	•	•	380	0.06	23/21	2600/3000	115/141	6.5/6.8	43/45	570

外观尺寸 / DIMENSIONS DRAWING

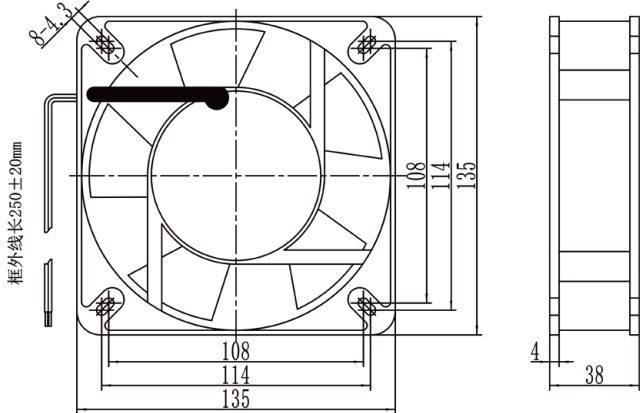

曲线 / P&Q CURVE(AT RATED VOLTAGE)

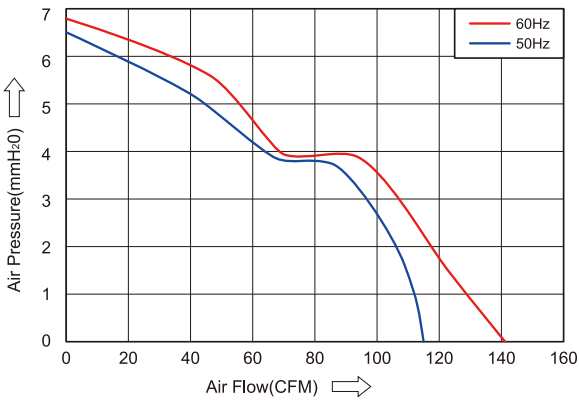

通用规范 / GENERAL SPECIFICATIONS

- 绝缘等级:** Class B
(Insuation)
- 材质:** Impeller: Plastic; Frame:Aluminum Alloy
(Material)
- 线材:** UL Type
(Lead Wire)
- 工作模式:** S1
(Mode ofoperation)
- 工作环境:** -10℃~70℃,35%~85% RH
(Operation Temperature)
- 储存环境:** -40℃~80℃,35%~85% RH
(Storage Temperature)
- 功能选择:** Thermal control
(Available Features)
- 振动:** 风机振动速度有效值按照JB/T8689标准规定
(Vibration of the fan)
- 防护等级:** 电机的防护等级为IP44
(Type of protection)



技术参数 / TECHNICAL DATA

型号 Model	Freq 频率	Bearing System 轴承		Rated Voltage 额定电压	Rated Current 额定电流	Input Power 功率	Rated Speed 额定速度	Air Flow 风量	Air Pressure 风压	Noise Level 噪音	Weight 重量
	Hz	Ball	Sleeve	VAC	A	W	RPM	CFM	mmH ₂ O	dBA	g
ZN17238-AC110MBAPL	50/60	•	•	110~125	0.26/0.25	33/30	2500/3000	166/198	16.7/19.5	57/61	760
ZN17238-AC220MBAPL	50/60	•	•	200~240	0.17/0.16	33/30	2500/3000	166/198	16.7/19.5	57/61	760

外观尺寸 / DIMENSIONS DRAWING

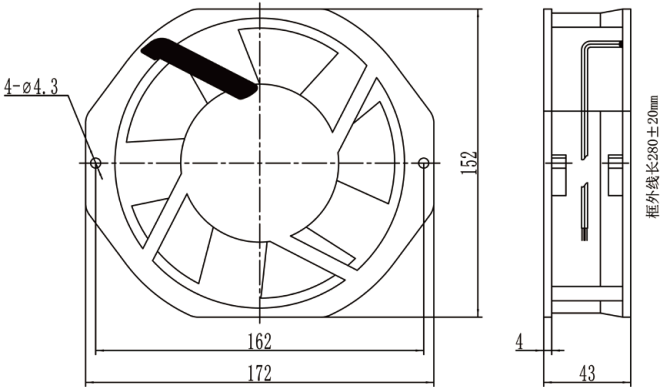

曲线 / P&Q CURVE(AT RATED VOLTAGE)

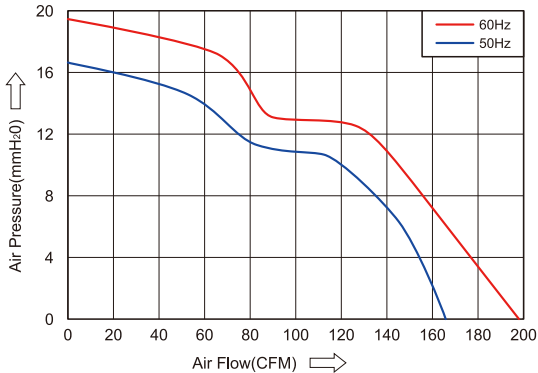

通用规范 / GENERAL SPECIFICATIONS

- 绝缘等级:** Class B
(Insuation)
- 材质:** Impeller: Plastic; Frame:Aluminum Alloy
(Material)
- 线材:** UL Type
(Lead Wire)
- 工作模式:** S1
(Mode ofoperation)
- 工作环境:** -10℃~70℃,35%~85% RH
(Operation Temperature)
- 储存环境:** -40℃~80℃,35%~85% RH
(Storage Temperature)
- 功能选择:** Thermal control
(Available Features)
- 振动:** 风机振动速度有效值按照JB/T8689标准规定
(Vibration of the fan)
- 防护等级:** 电机的防护等级为IP44
(Type of protection)



技术参数 / TECHNICAL DATA

型号 Model	Freq 频率	Bearing System 轴承		Rated Voltage 额定电压	Rated Current 额定电流	Input Power 功率	Rated Speed 额定速度	Air Flow 风量	Air Pressure 风压	Noise Level 噪音	Weight 重量
	Hz	Ball	Sleeve	VAC	A	W	RPM	CFM	mmH ₂ O	dBA	g
ZN15050-AC110HBAPL	50/60	•	•	110~125	0.45	38/36	2600/3000	170/196	11.5/14.0	49/56	800
ZN15050-AC110MBAPL	50/60	•	•	110~125	0.30	28/27	2400/2600	155/170	7.5/9.7	45/49	800
ZN15050-AC110LBAPL	50/60	•	•	110~125	0.15	21/20	2100/2400	137/155	3.0/3.9	39/45	800
ZN15050-AC220HBAPL	50/60	•	•	200~240	0.23	38/36	2600/3000	170/196	11.5/14.0	49/56	800
ZN15050-AC220MBAPL	50/60	•	•	200~240	0.18	28/27	2400/2600	155/170	7.5/9.7	45/49	800
ZN15050-AC220LBAPL	50/60	•	•	200~240	0.12	21/20	2100/2400	137/155	3.0/3.9	39/45	800
ZN15050-AC380HBAPL	50/60	•	•	380	0.13	38/36	2600/3000	170/196	11.5/14.0	49/56	800

外观尺寸 / DIMENSIONS DRAWING

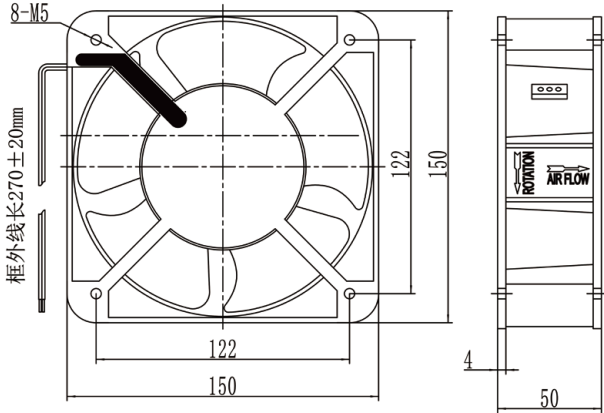

曲线 / P&Q CURVE(AT RATED VOLTAGE)

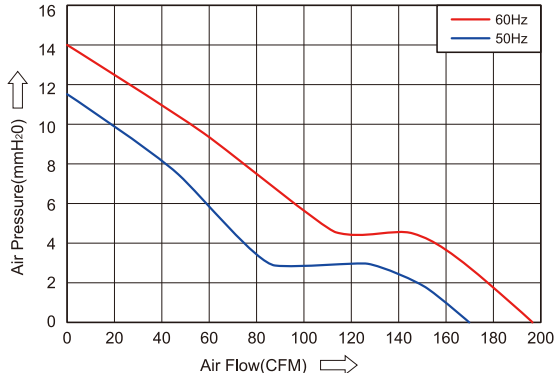

通用规范 / GENERAL SPECIFICATIONS

- 绝缘等级:

Class B

(Insuation)
- 材质:

Impeller: Plastic; Frame:Aluminum Alloy

(Material)
- 线材:

UL Type

(Lead Wire)
- 工作模式:

S1

(Mode ofoperation)
- 工作环境:

-10℃~70℃,35%~85% RH

(Operation Temperature)
- 储存环境:

-40℃~80℃,35%~85% RH

(Storage Temperature)
- 功能选择:

Thermal control

(Available Features)
- 振动:

风机振动速度有效值按照JB/T8689标准规定

(Vibration of the fan)
- 防护等级:

电机的防护等级为IP44

(Type of protection)



技术参数 / TECHNICAL DATA

型号 Model	Freq 频率	Bearing System 轴承		Rated Voltage 额定电压	Rated Current 额定电流	Input Power 功率	Rated Speed 额定速度	Air Flow 风量	Air Pressure 风压	Noise Level 噪音	Weight 重量
	Hz	Ball	Sleeve	VAC	A	W	RPM	CFM	mmH ₂ O	dBA	g
ZN17251-AC110HBAPL	50/60	•	•	110~125	0.45	38/36	2600/3000	170/196	11.5/14.0	49/56	800
ZN17251-AC110MBAPL	50/60	•	•	110~125	0.30	28/27	2400/2600	155/170	7.5/9.7	45/49	800
ZN17251-AC110LBAPL	50/60	•	•	110~125	0.15	21/20	2100/2400	137/155	3.0/3.9	39/45	800
ZN17251-AC220HBAPL	50/60	•	•	200~240	0.23	38/36	2600/3000	170/196	11.5/14.0	49/56	800
ZN17251-AC220MBAPL	50/60	•	•	200~240	0.18	28/27	2400/2600	155/170	7.5/9.7	45/49	800
ZN17251-AC220LBAPL	50/60	•	•	200~240	0.12	21/20	2100/2400	137/155	3.0/3.9	39/45	800
ZN17251-AC380HBAPL	50/60	•	•	380	0.13	38/36	2600/3000	170/196	11.5/14.0	49/56	800

外观尺寸 / DIMENSIONS DRAWING

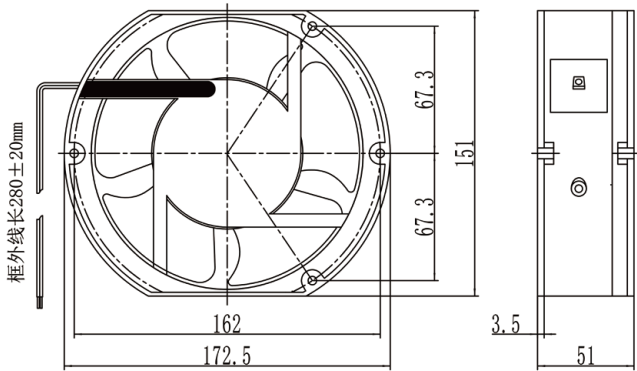

曲线 / P&Q CURVE(AT RATED VOLTAGE)

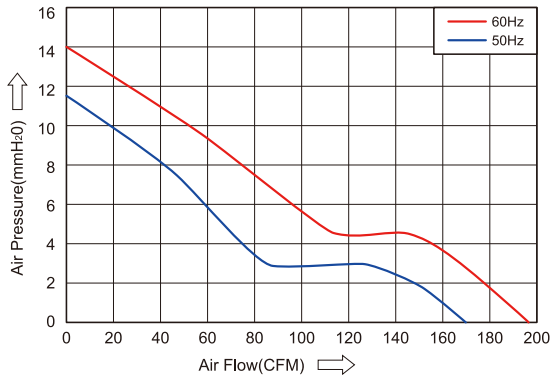

通用规范 / GENERAL SPECIFICATIONS

- 绝缘等级:

Class B

(Insuation)
- 材质:

Impeller: Plastic; Frame:Aluminum Alloy

(Material)
- 线材:

UL Type

(Lead Wire)
- 工作模式:

S1

(Mode ofoperation)
- 工作环境:

-10℃~70℃,35%~85% RH

(Operation Temperature)
- 储存环境:

-40℃~80℃,35%~85% RH

(Storage Temperature)
- 功能选择:

Thermal control

(Available Features)
- 振动:

风机振动速度有效值按照JB/T8689标准规定

(Vibration of the fan)
- 防护等级:

电机的防护等级为IP44

(Type of protection)



技术参数 / TECHNICAL DATA

型号 Model	Freq 频率	Bearing System 轴承		Rated Voltage 额定电压	Rated Current 额定电流	Input Power 功率	Rated Speed 额定速度	Air Flow 风量	Air Pressure 风压	Noise Level 噪音	Weight 重量
	Hz	Ball	Sleeve	VAC	A	W	RPM	CFM	mmH ₂ O	dBA	g
ZN17251-AC110HBAPL正圆	50/60	•	•	110~125	0.45	38/36	2600/3000	170/196	11.5/14.0	49/56	800
ZN17251-AC110MBAPL正圆	50/60	•	•	110~125	0.30	28/27	2400/2600	155/170	7.5/9.7	45/49	800
ZN17251-AC110LBAPL正圆	50/60	•	•	110~125	0.15	21/20	2100/2400	137/155	3.0/3.9	39/45	800
ZN17251-AC220HBAPL正圆	50/60	•	•	200~240	0.23	38/36	2600/3000	170/196	11.5/14.0	49/56	800
ZN17251-AC220MBAPL正圆	50/60	•	•	200~240	0.18	28/27	2400/2600	155/170	7.5/9.7	45/49	800
ZN17251-AC220LBAPL正圆	50/60	•	•	200~240	0.12	21/20	2100/2400	137/155	3.0/3.9	39/45	800
ZN17251-AC380HBAPL正圆	50/60	•	•	380	0.13	38/36	2600/3000	170/196	11.5/14.0	49/56	800

外观尺寸 / DIMENSIONS DRAWING

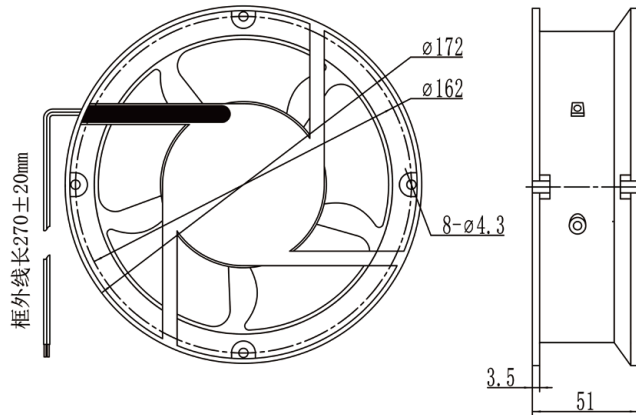

曲线 / P&Q CURVE(AT RATED VOLTAGE)

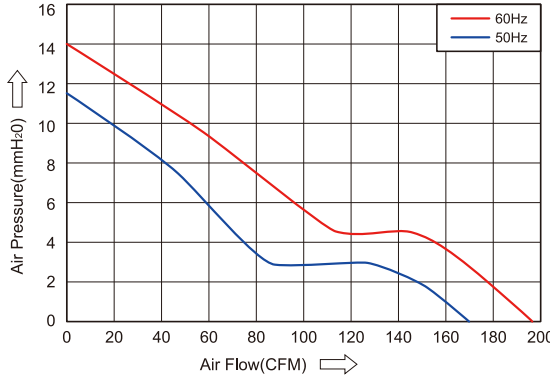

通用规范 / GENERAL SPECIFICATIONS

- 绝缘等级:

Class B

(Insuation)
- 材质:

Impeller: Plastic; Frame:Aluminum Alloy

(Material)
- 线材:

UL Type

(Lead Wire)
- 工作模式:

S1

(Mode ofoperation)
- 工作环境:

-10℃~70℃,35%~85% RH

(Operation Temperature)
- 储存环境:

-40℃~80℃,35%~85% RH

(Storage Temperature)
- 功能选择:

Thermal control

(Available Features)
- 振动:

风机振动速度有效值按照JB/T8689标准规定

(Vibration of the fan)
- 防护等级:

电机的防护等级为IP44

(Type of protection)



技术参数 / TECHNICAL DATA

型号 Model	Freq 频率	Bearing System 轴承		Rated Voltage 额定电压	Rated Current 额定电流	Input Power 功率	Rated Speed 额定速度	Air Flow 风量	Air Pressure 风压	Noise Level 噪音	Weight 重量
	Hz	Ball	Sleeve	VAC	A	W	RPM	CFM	mmH ₂ O	dBA	g
ZN18060-AC110MBAPL	50/60	•		110~125	0.70	50	2700	350	18.5	60	950
ZN18060-AC220MBAPL	50/60	•		200~240	0.35	50	2700	350	18.5	60	950

外观尺寸 / DIMENSIONS DRAWING

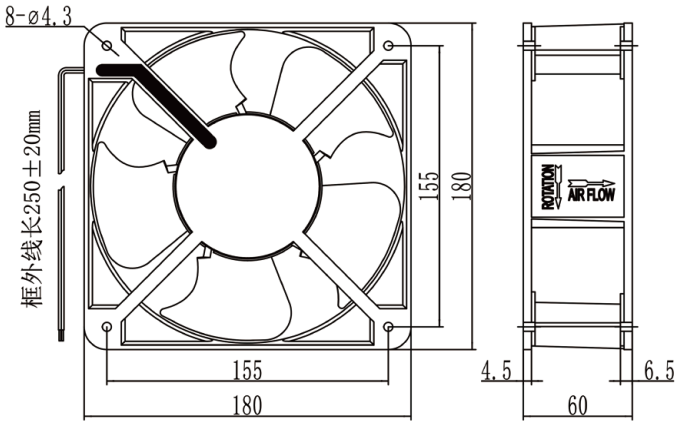

曲线 / P&Q CURVE(AT RATED VOLTAGE)

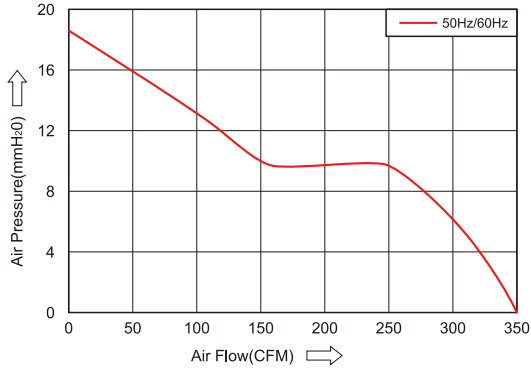

通用规范 / GENERAL SPECIFICATIONS

- 绝缘等级:

Class B

(Insuation)
- 材质:

Impeller: Plastic; Frame:Aluminum Alloy

(Material)
- 线材:

UL Type

(Lead Wire)
- 工作模式:

S1

(Mode ofoperation)
- 工作环境:

-10℃~70℃,35%~85% RH

(Operation Temperature)
- 储存环境:

-40℃~80℃,35%~85% RH

(Storage Temperature)
- 功能选择:

Thermal control

(Available Features)
- 振动:

风机振动速度有效值按照JB/T8689标准规定

(Vibration of the fan)
- 防护等级:

电机的防护等级为IP44

(Type of protection)



技术参数 / TECHNICAL DATA

型号 Model	Freq 频率	Bearing System 轴承		Rated Voltage 额定电压	Rated Current 额定电流	Input Power 功率	Rated Speed 额定速度	Air Flow 风量	Air Pressure 风压	Noise Level 噪音	Weight 重量
	Hz	Ball	Sleeve	VAC	A	W	RPM	CFM	mmH ₂ O	dBA	g
ZN20060-AC110MBAPL	50	•		110~125	0.80	65	2700	420	22.0	54	1540
ZN20060-AC220MBAPL	50	•		200~240	0.45	65	2700	420	22.0	54	1540
ZN20060-AC380MBAPL	50	•		380	0.30	65	2700	420	22.0	54	1540

外观尺寸 / DIMENSIONS DRAWING

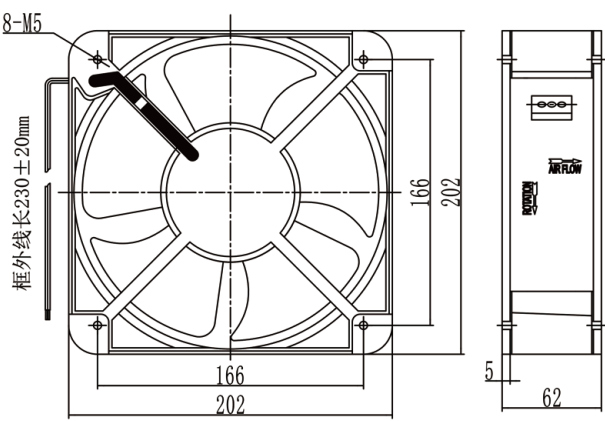

曲线 / P&Q CURVE(AT RATED VOLTAGE)

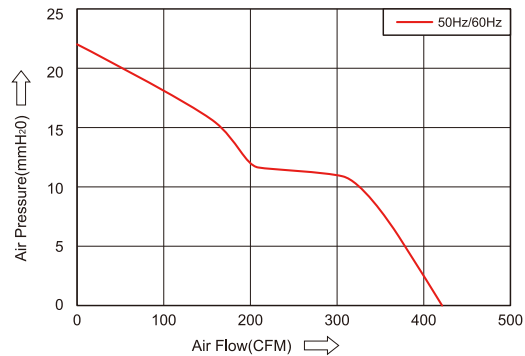

通用规范 / GENERAL SPECIFICATIONS

- 绝缘等级:

Class B

(Insuation)
- 材质:

Impeller: Plastic; Frame:Aluminum Alloy

(Material)
- 线材:

UL Type

(Lead Wire)
- 工作模式:

S1

(Mode ofoperation)
- 工作环境:

-10℃~70℃,35%~85% RH

(Operation Temperature)
- 储存环境:

-40℃~80℃,35%~85% RH

(Storage Temperature)
- 功能选择:

Thermal control

(Available Features)
- 振动:

风机振动速度有效值按照JB/T8689标准规定

(Vibration of the fan)
- 防护等级:

电机的防护等级为IP44

(Type of protection)



技术参数 / TECHNICAL DATA

型号 Model	Freq 频率	Bearing System 轴承		Rated Voltage 额定电压	Rated Current 额定电流	Input Power 功率	Rated Speed 额定速度	Air Flow 风量	Air Pressure 风压	Noise Level 噪音	Weight 重量
	Hz	Ball	Sleeve	VAC	A	W	RPM	CFM	mmH ₂ O	dBA	g
ZN22060-AC110MBAPL	50	•		110~125	0.80	65	2700	420	22.0	54	1540
ZN22060-AC220MBAPL	50	•		200~240	0.45	65	2700	420	22.0	54	1540
ZN22060-AC380MBAPL	50	•		380	0.30	65	2700	420	22.0	54	1540

外观尺寸 / DIMENSIONS DRAWING

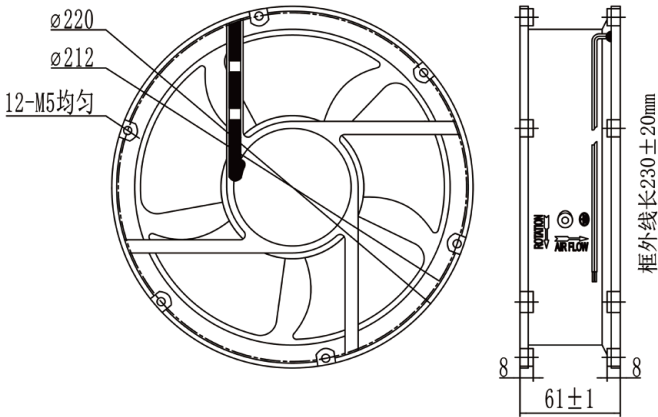

曲线 / P&Q CURVE(AT RATED VOLTAGE)

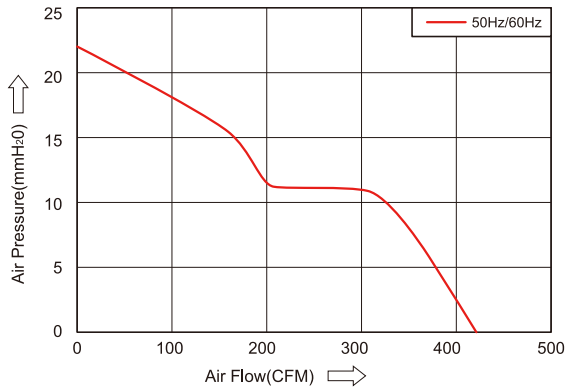

通用规范 / GENERAL SPECIFICATIONS

- 绝缘等级:

Class B

(Insuation)
- 材质:

Impeller & Frame: Plastic

(Material)
- 线材:

UL Type

(Lead Wire)
- 工作模式:

S1

(Mode ofoperation)
- 工作环境:

-10° C-70° C,35%-85%RH

(Operation Temperature)
- 储存环境:

-40° C-80° C,35%-85%RH

(Storage Temperature)
- 功能选择:

IPX6 / PWM / FG& RD / Thermal control /

Autoresart / Slow starup

(Available Features)

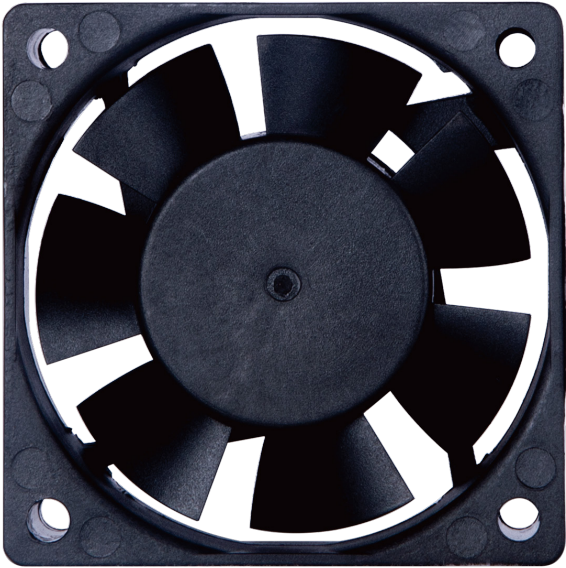

技术参数 / TECHNICAL DATA

型号 Model	Bearing System 轴承		Rated Voltage 额定电压	Operation Voltage 安规电压	Rated Current 额定电流	Rated Speed 额定速度	Air Flow 风量	Air Pressure 风压	Noise Level 噪音	Weight 重量
	Ball	Sleeve	VDC	VDC	A	RPM	CFM	mmH ₂ O	dBA	g
ZN6015-DC5HB(S)PPL(T)	•	•	5	4.5-5.5	0.30	4000	15.4	3.9	32	44
ZN6015-DC5MB(S)PPL(T)	•	•			0.20	3500	13.5	3.1	29	
ZN6015-DC5LB(S)PPL(T)	•	•			0.13	3000	11.6	2.2	24	
ZN6015-DC12HB(S)PPL(T)	•	•	12	6.0-13.8	0.28	5000	19.4	6.1	37	44
ZN6015-DC12MB(S)PPL(T)	•	•			0.18	4000	15.4	3.9	32	
ZN6015-DC12LB(S)PPL(T)	•	•			0.10	3000	11.6	2.2	24	
ZN6015-DC24HB(S)PPL(T)	•	•	24	12.0-27.6	0.15	5000	19.4	6.1	37	44
ZN6015-DC24MB(S)PPL(T)	•	•			0.10	4000	15.4	3.9	32	
ZN6015-DC24LB(S)PPL(T)	•	•			0.06	3000	11.6	2.2	24	

外观尺寸 / DIMENSIONS DRAWING

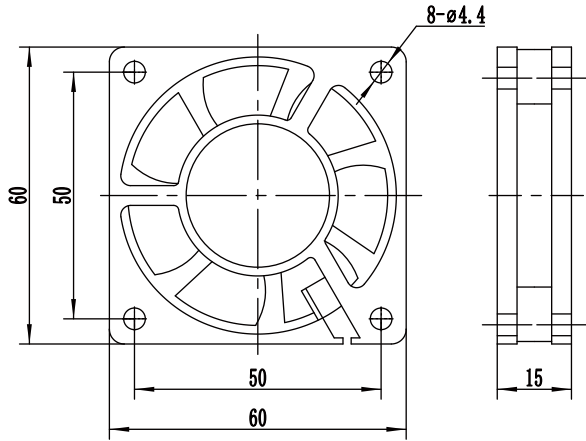

曲线 / P&Q CURVE(AT RATED VOLTAGE)

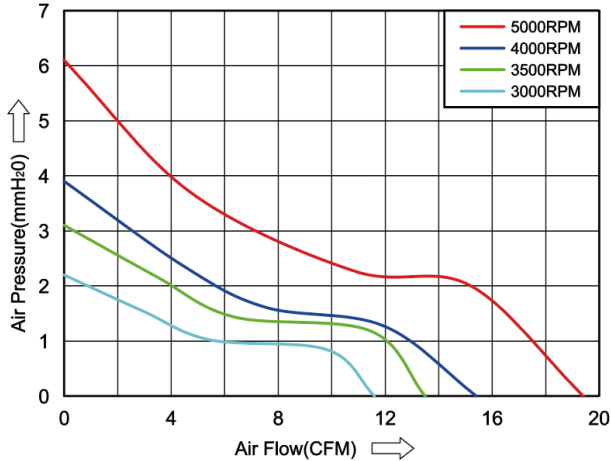

通用规范 / GENERAL SPECIFICATIONS

- 绝缘等级:

Class B

(Insuation)
- 材质:

Impeller: Plastic; Frame:Aluminum Alloy

(Material)
- 线材:

UL Type

(Lead Wire)
- 工作模式:

S1

(Mode ofoperation)
- 工作环境:

-10℃~70℃,35%~85% RH

(Operation Temperature)
- 储存环境:

-40℃~80℃,35%~85% RH

(Storage Temperature)
- 功能选择:

Thermal control

(Available Features)
- 振动:

风机振动速度有效值按照JB/T8689标准规定

(Vibration of the fan)
- 防护等级:

电机的防护等级为IP44

(Type of protection)



技术参数 / TECHNICAL DATA

型号 Model	Freq 频率	Bearing System 轴承		Rated Voltage 额定电压	Rated Current 额定电流	Input Power 功率	Rated Speed 额定速度	Air Flow 风量	Air Pressure 风压	Noise Level 噪音	Weight 重量
	Hz	Ball	Sleeve	VAC	A	W	RPM	CFM	mmH ₂ O	dBA	g
ZN22060-AC110MBAPL	50	•		110~125	0.80	65	2700	420	22.0	54	1540
ZN22060-AC220MBAPL	50	•		200~240	0.45	65	2700	420	22.0	54	1540
ZN22060-AC380MBAPL	50	•		380	0.30	65	2700	420	22.0	54	1540

外观尺寸 / DIMENSIONS DRAWING

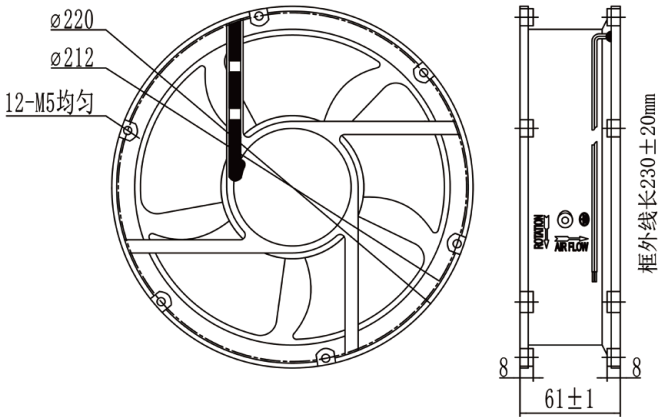

曲线 / P&Q CURVE(AT RATED VOLTAGE)

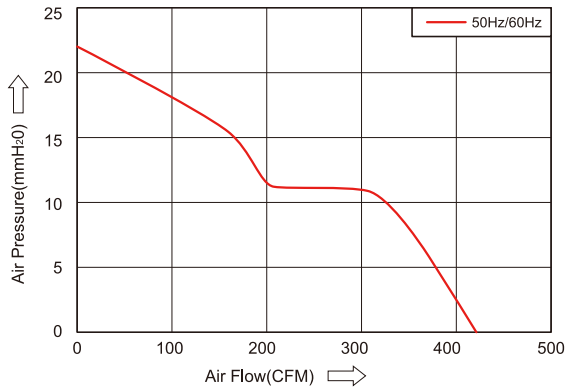

通用规范 / GENERAL SPECIFICATIONS

- 绝缘等级:

Class B

(Insuation)
- 材质:

Impeller & Frame: Plastic

(Material)
- 线材:

UL Type

(Lead Wire)
- 工作模式:

S1

(Mode ofoperation)
- 工作环境:

-10° C-70° C,35%-85%RH

(Operation Temperature)
- 储存环境:

-40° C-80° C,35%-85%RH

(Storage Temperature)
- 功能选择:

IPX6 / PWM / FG& RD / Thermal control /
Autoresart / Slow starup

(Available Features)

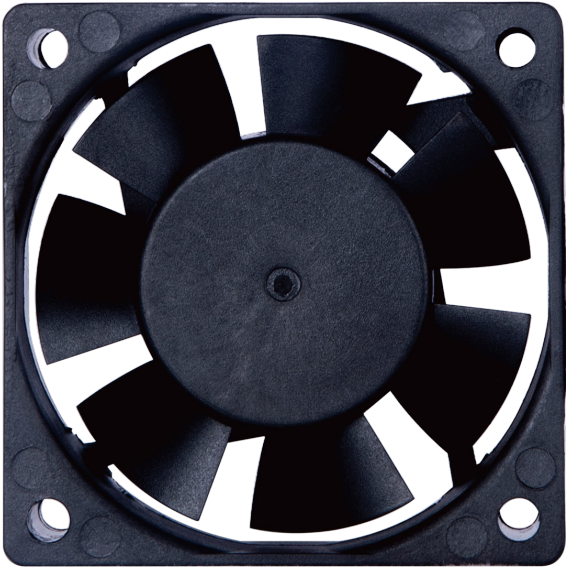

技术参数 / TECHNICAL DATA

型号 Model	Bearing System 轴承		Rated Voltage 额定电压	Operation Voltage 安规电压	Rated Current 额定电流	Rated Speed 额定速度	Air Flow 风量	Air Pressure 风压	Noise Level 噪音	Weight 重量
	Ball	Sleeve	VDC	VDC	A	RPM	CFM	mmH ₂ O	dBA	g
ZN6015-DC5HB(S)PPL(T)	•	•	5	4.5-5.5	0.30	4000	15.4	3.9	32	44
ZN6015-DC5MB(S)PPL(T)	•	•			0.20	3500	13.5	3.1	29	
ZN6015-DC5LB(S)PPL(T)	•	•			0.13	3000	11.6	2.2	24	
ZN6015-DC12HB(S)PPL(T)	•	•	12	6.0-13.8	0.28	5000	19.4	6.1	37	44
ZN6015-DC12MB(S)PPL(T)	•	•			0.18	4000	15.4	3.9	32	
ZN6015-DC12LB(S)PPL(T)	•	•			0.10	3000	11.6	2.2	24	
ZN6015-DC24HB(S)PPL(T)	•	•	24	12.0-27.6	0.15	5000	19.4	6.1	37	44
ZN6015-DC24MB(S)PPL(T)	•	•			0.10	4000	15.4	3.9	32	
ZN6015-DC24LB(S)PPL(T)	•	•			0.06	3000	11.6	2.2	24	

外观尺寸 / DIMENSIONS DRAWING

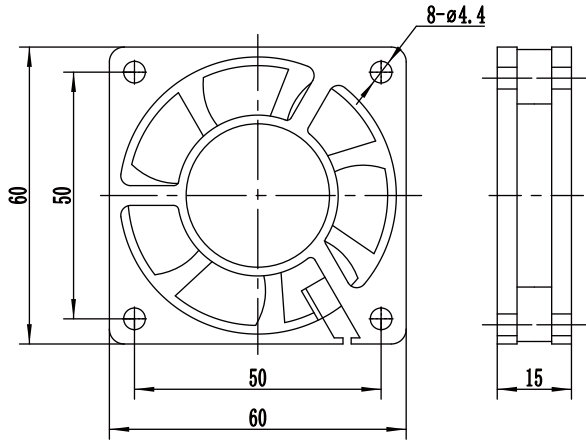

曲线 / P&Q CURVE(AT RATED VOLTAGE)

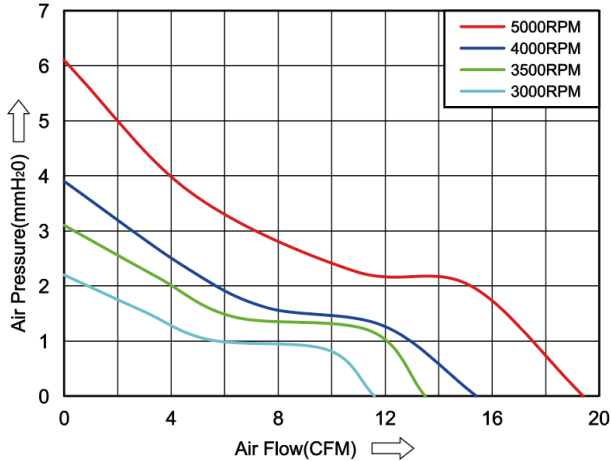

通用规范 / GENERAL SPECIFICATIONS

- 绝缘等级:

(Insuation)

Class B
- 材质:

(Material)

Impeller & Frame: Plastic
- 线材:

(Lead Wire)

UL Type
- 工作模式:

(Mode of operation)

S1
- 工作环境:

(Operation Temperature)

-10° C-70° C,35%-85%RH
- 储存环境:

(Storage Temperature)

-40° C-80° C,35%-85%RH
- 功能选择:

(Available Features)

IPX6 / PWM / FG& RD / Thermal control /
Autoresart / Slow starup

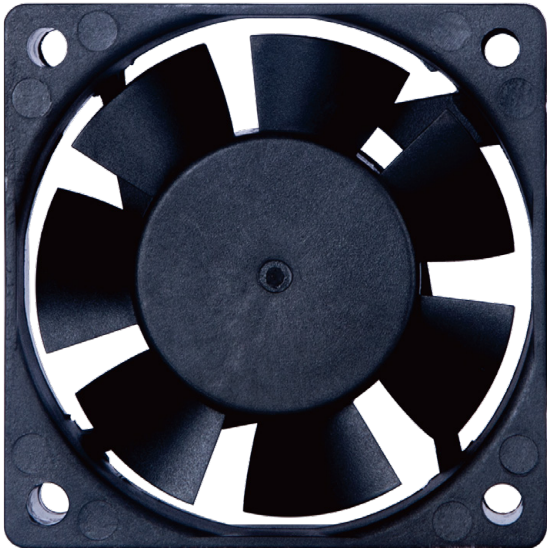

技术参数 / TECHNICAL DATA

型号 Model	Bearing System 轴承		Rated Voltage 额定电压	Operation Voltage 安规电压	Rated Current 额定电流	Rated Speed 额定速度	Air Flow 风量	Air Pressure 风压	Noise Level 噪音	Weight 重量
	Ball	Sleeve	VDC	VDC	A	RPM	CFM	mmH ₂ O	dBA	g
ZN6020-DC5HB(S)PPL(T)	•	•	5	4.5-5.5	0.35	5000	24.4	6.5	38	49
ZN6020-DC5MB(S)PPL(T)	•	•			0.25	4000	20.1	4.3	32	
ZN6020-DC5LB(S)PPL(T)	•	•			0.15	3000	15.1	2.4	24	
ZN6020-DC12HB(S)PPL(T)	•	•	12	6.0-13.8	0.25	5000	24.4	6.5	38	49
ZN6020-DC12MB(S)PPL(T)	•	•			0.18	4000	20.1	4.3	32	
ZN6020-DC12LB(S)PPL(T)	•	•			0.12	3000	15.1	2.4	24	
ZN6020-DC24HB(S)PPL(T)	•	•	24	12.0-27.6	0.15	5000	24.4	6.5	38	49
ZN6020-DC24MB(S)PPL(T)	•	•			0.12	4000	20.1	4.3	32	
ZN6020-DC24LB(S)PPL(T)	•	•			0.10	3000	15.1	2.4	24	

外观尺寸 / DIMENSIONS DRAWING

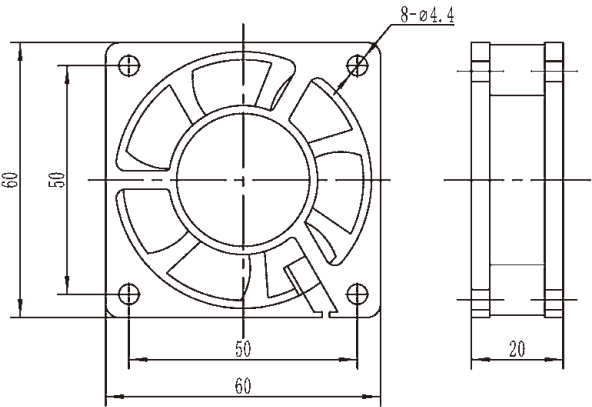

曲线 / P&Q CURVE(AT RATED VOLTAGE)

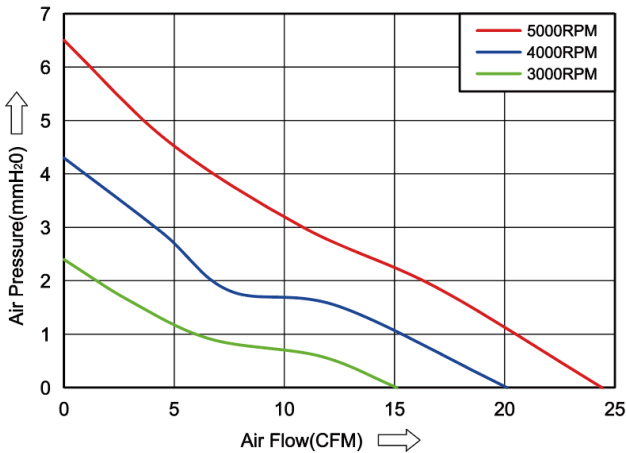

通用规范 / GENERAL SPECIFICATIONS

- 绝缘等级:

(Insuation)

Class B
- 材质:

(Material)

Impeller & Frame: Plastic
- 线材:

(Lead Wire)

UL Type
- 工作模式:

(Mode of operation)

S1
- 工作环境:

(Operation Temperature)

-10° C-70° C,35%-85%RH
- 储存环境:

(Storage Temperature)

-40° C-80° C,35%-85%RH
- 功能选择:

(Available Features)

IPX6 / PWM / FG& RD / Thermal control /
Autoresart / Slow starup

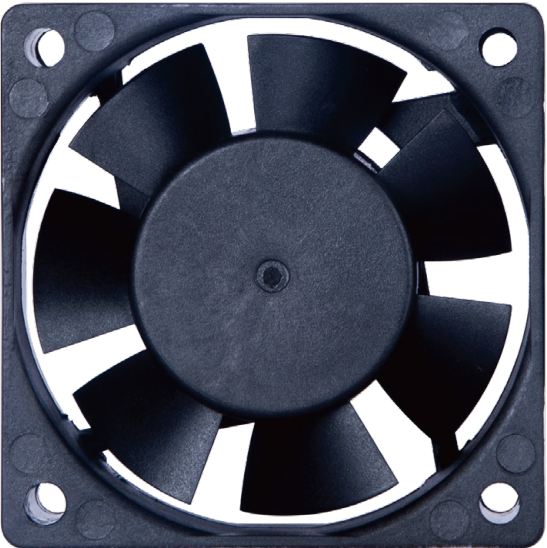

技术参数 / TECHNICAL DATA

型号 Model	Bearing System 轴承		Rated Voltage 额定电压	Operation Voltage 安规电压	Rated Current 额定电流	Rated Speed 额定速度	Air Flow 风量	Air Pressure 风压	Noise Level 噪音	Weight 重量
	Ball	Sleeve	VDC	VDC	A	RPM	CFM	mmH ₂ O	dBA	g
ZN6025-DC5HB(S)PPL(T)	•	•	5	4.5-5.5	0.30	4000	20.3	4.5	30	62
ZN6025-DC5MB(S)PPL(T)	•	•			0.25	3000	15.1	2.6	24	
ZN6025-DC5LB(S)PPL(T)	•	•			0.20	2000	12.5	1.8	22	
ZN6025-DC12DB(S)PPL(T)	•	•	12	6.0-13.8	0.45	6800	32.1	13.0	48	62
ZN6025-DC12HB(S)PPL(T)	•	•			0.25	5000	25.4	7.0	36	
ZN6025-DC12MB(S)PPL(T)	•	•			0.18	4000	20.3	4.5	30	
ZN6025-DC12LB(S)PPL(T)	•	•	24	12.0-27.6	0.10	3000	15.1	2.6	24	62
ZN6025-DC24DB(S)PPL(T)	•	•			0.25	6800	32.1	13.0	48	
ZN6025-DC24HB(S)PPL(T)	•	•			0.12	5000	25.4	7.0	36	
ZN6025-DC24MB(S)PPL(T)	•	•	48	24.0-55.2	0.10	4000	20.3	4.5	30	62
ZN6025-DC24LB(S)PPL(T)	•	•			0.08	3000	15.1	2.6	24	
ZN6025-DC48DB(S)PPL(T)	•	•			0.18	6800	32.1	13.0	48	
ZN6025-DC48HB(S)PPL(T)	•	•	48	24.0-55.2	0.10	5000	25.4	7.0	36	62
ZN6025-DC48MB(S)PPL(T)	•	•			0.08	4000	20.3	4.5	30	
ZN6025-DC48LB(S)PPL(T)	•	•			0.06	3000	15.1	2.6	24	

外观尺寸 / DIMENSIONS DRAWING

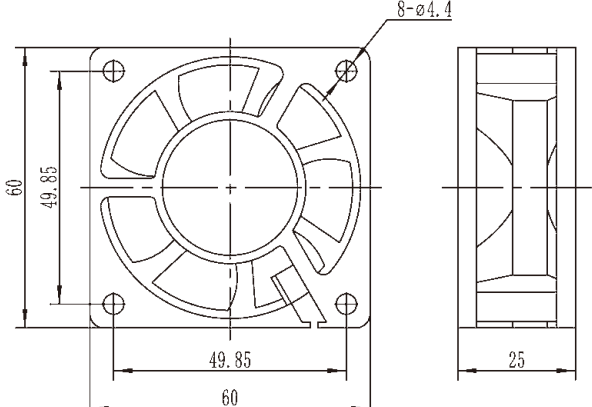

曲线 / P&Q CURVE(AT RATED VOLTAGE)

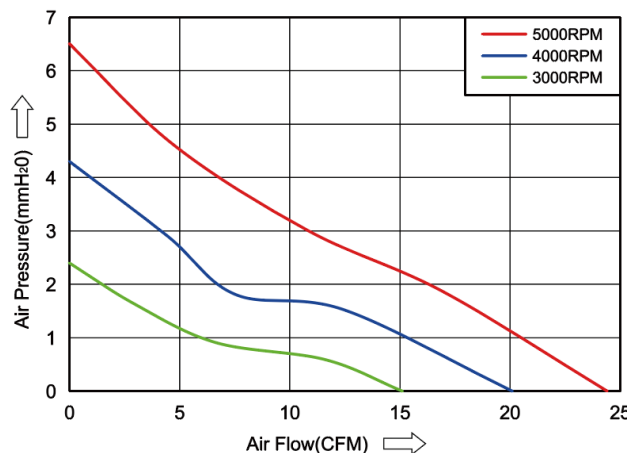

通用规范 / GENERAL SPECIFICATIONS

- 绝缘等级:

Class B

(Insuation)
- 材质:

Impeller & Frame: Plastic

(Material)
- 线材:

UL Type

(Lead Wire)
- 工作模式:

S1

(Mode ofoperation)
- 工作环境:

-10° C-70° C,35%-85%RH

(Operation Temperature)
- 储存环境:

-40° C-80° C,35%-85%RH

(Storage Temperature)
- 功能选择:

IPX6 / PWM / FG& RD / Thermal control /

(Available Features)

Autoresart / Slow starup



技术参数 / TECHNICAL DATA

型号 Model	Bearing System 轴承		Rated Voltage 额定电压	Operation Voltage 安规电压	Rated Current 额定电流	Rated Speed 额定速度	Air Flow 风量	Air Pressure 风压	Noise Level 噪音	Weight 重量
	Ball	Sleeve	VDC	VDC	A	RPM	CFM	mmH ₂ O	dBA	g
ZN6038-DC12HB(S)PPL(T)	•	•	12	7.0-13.8	1.0	9000	49.9	22.8	60	85
ZN6038-DC12MB(S)PPL(T)	•	•			0.70	8000	44.5	18.7	55	
ZN6038-DC12LB(S)PPL(T)	•	•			0.50	7000	39.0	14.5	51	
ZN6038-DC24DB(S)PPL(T)	•	•	24	15.0-27.6	0.65	10000	56.6	29.2	65	85
ZN6038-DC24HB(S)PPL(T)	•	•			0.50	9000	49.9	22.8	60	
ZN6038-DC24MB(S)PPL(T)	•	•			0.35	8000	44.5	18.7	55	
ZN6038-DC24LB(S)PPL(T)	•	•			0.30	7000	39.0	14.5	51	
ZN6038-DC48DB(S)PPL(T)	•	•	48	28.0-55.2	0.35	10000	56.6	29.2	65	85
ZN6038-DC48HB(S)PPL(T)	•	•			0.30	9000	49.9	22.8	60	
ZN6038-DC48MB(S)PPL(T)	•	•			0.25	8000	44.5	18.7	55	
ZN6038-DC48LB(S)PPL(T)	•	•			0.20	7000	39.0	14.5	51	

外观尺寸 / DIMENSIONS DRAWING

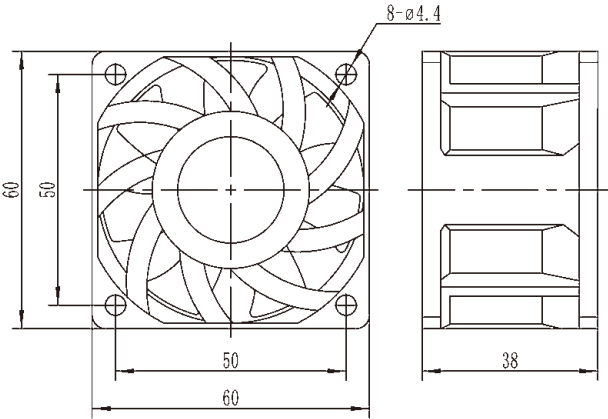

曲线 / P&Q CURVE(AT RATED VOLTAGE)

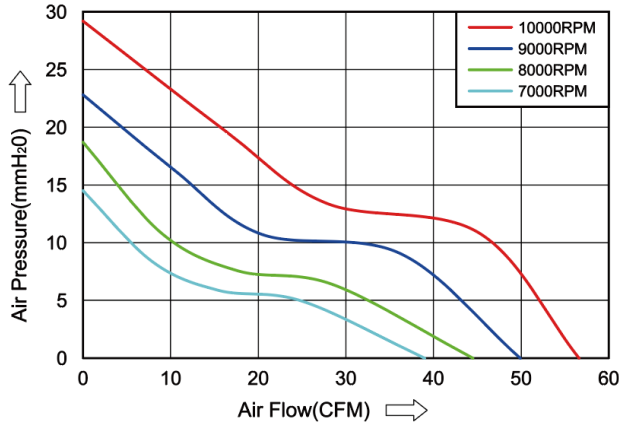

通用规范 / GENERAL SPECIFICATIONS

- 绝缘等级:

Class B

(Insuation)
- 材质:

Impeller & Frame: Plastic

(Material)
- 线材:

UL Type

(Lead Wire)
- 工作模式:

S1

(Mode ofoperation)
- 工作环境:

-10° C-70° C,35%-85%RH

(Operation Temperature)
- 储存环境:

-40° C-80° C,35%-85%RH

(Storage Temperature)
- 功能选择:

IPX6 / PWM / FG& RD / Thermal control /

(Available Features)

Autoresart / Slow starup



技术参数 / TECHNICAL DATA

型号 Model	Bearing System 轴承		Rated Voltage 额定电压	Operation Voltage 安规电压	Rated Current 额定电流	Rated Speed 额定速度	Air Flow 风量	Air Pressure 风压	Noise Level 噪音	Weight 重量
	Ball	Sleeve	VDC	VDC	A	RPM	CFM	mmH ₂ O	dBA	g
ZN8025-DC5HB(S)PPL(T)	•	•	5	4.5-5.5	0.40	3000	41.5	3.5	33	78
ZN8025-DC5MB(S)PPL(T)	•	•			0.28	2500	33.4	2.2	28	
ZN8025-DC5LB(S)PPL(T)	•	•			0.22	2000	27.7	1.9	23	
ZN8025-DC12HB(S)PPL(T)	•	•	12	6.0-13.8	0.40	4000	56.0	6.2	42	78
ZN8025-DC12MB(S)PPL(T)	•	•			0.25	3000	41.5	3.5	33	
ZN8025-DC12LB(S)PPL(T)	•	•			0.13	2000	27.7	1.9	23	
ZN8025-DC24HB(S)PPL(T)	•	•	24	12.0-27.6	0.25	4000	56.0	6.2	42	78
ZN8025-DC24MB(S)PPL(T)	•	•			0.15	3000	41.5	3.5	33	
ZN8025-DC24LB(S)PPL(T)	•	•			0.10	2000	27.7	1.9	23	
ZN8025-DC48HB(S)PPL(T)	•	•	48	24.0-55.2	0.18	4000	56.0	6.2	42	78
ZN8025-DC48MB(S)PPL(T)	•	•			0.10	3000	41.5	3.5	33	
ZN8025-DC48LB(S)PPL(T)	•	•			0.08	2000	27.7	1.9	23	

外观尺寸 / DIMENSIONS DRAWING

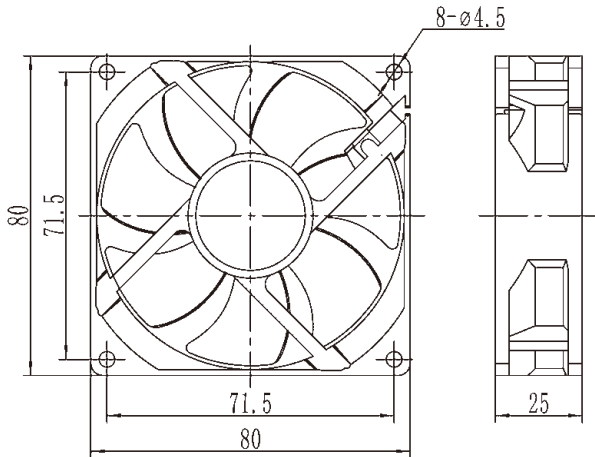

曲线 / P&Q CURVE(AT RATED VOLTAGE)

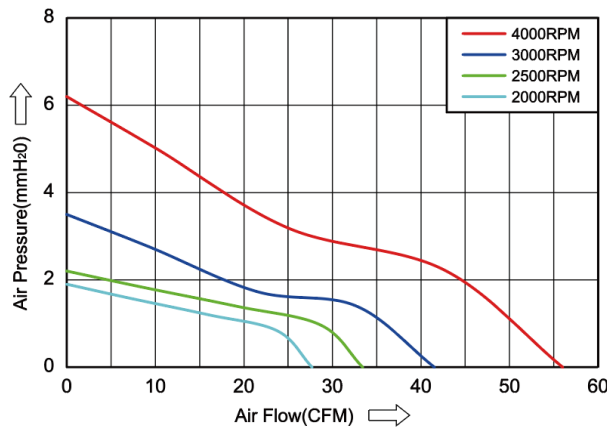

通用规范 / GENERAL SPECIFICATIONS

- 绝缘等级:

Class B

(Insuation)
- 材质:

Impeller & Frame: Plastic

(Material)
- 线材:

UL Type

(Lead Wire)
- 工作模式:

S1

(Mode of operation)
- 工作环境:

-10° C-70° C,35%-85%RH

(Operation Temperature)
- 储存环境:

-40° C-80° C,35%-85%RH

(Storage Temperature)
- 功能选择:

IPX6 / PWM / FG& RD / Thermal control /

(Available Features)

Autoresart / Slow starup



技术参数 / TECHNICAL DATA

型号 Model	Bearing System 轴承		Rated Voltage 额定电压	Operation Voltage 安规电压	Rated Current 额定电流	Rated Speed 额定速度	Air Flow 风量	Air Pressure 风压	Noise Level 噪音	Weight 重量
	Ball	Sleeve	VDC	VDC	A	RPM	CFM	mmH ₂ O	dBA	g
ZN8038-DC12DB(S)PPL(T)	•		12	7.0-13.8	2.80	9000	124.0	50.0	67	170
ZN8038-DC12HB(S)PPL(T)	•				1.60	7500	105.0	35.0	63	
ZN8038-DC12MB(S)PPL(T)	•	•			0.85	6000	83.5	21.8	57	
ZN8038-DC12LB(S)PPL(T)	•	•			0.45	4500	61.5	12.4	49	
ZN8038-DC24DB(S)PPL(T)	•		24	12.0-27.6	1.50	9000	124.0	50.0	67	170
ZN8038-DC24HB(S)PPL(T)	•				0.80	7500	105.0	35.0	63	
ZN8038-DC24MB(S)PPL(T)	•	•			0.45	6000	83.5	21.8	57	
ZN8038-DC24LB(S)PPL(T)	•	•			0.25	4500	61.5	12.4	49	
ZN8038-DC48DB(S)PPL(T)	•		48	24.0-55.2	0.80	9000	124.0	50.0	67	170
ZN8038-DC48HB(S)PPL(T)	•				0.45	7500	105.0	35.0	63	
ZN8038-DC48MB(S)PPL(T)	•	•			0.28	6000	83.5	21.8	57	
ZN8038-DC48LB(S)PPL(T)	•	•			0.18	4500	61.5	12.4	49	

外观尺寸 / DIMENSIONS DRAWING

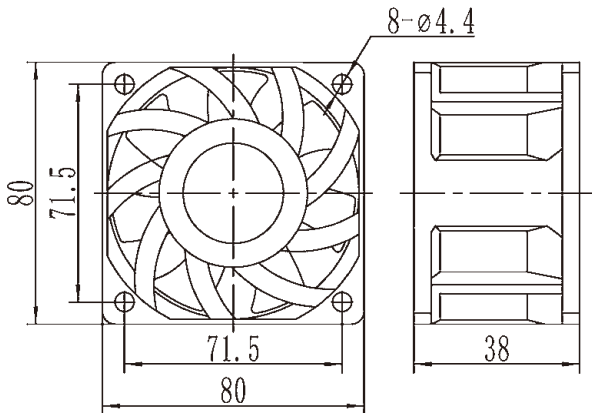

曲线 / P&Q CURVE(AT RATED VOLTAGE)

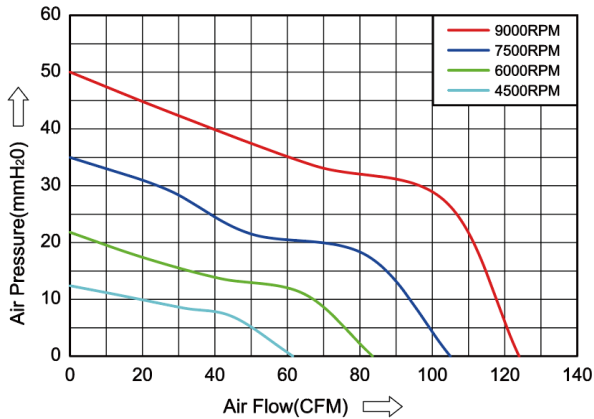

通用规范 / GENERAL SPECIFICATIONS

- 绝缘等级:

Class B

(Insuation)
- 材质:

Impeller & Frame: Plastic

(Material)
- 线材:

UL Type

(Lead Wire)
- 工作模式:

S1

(Mode of operation)
- 工作环境:

-10° C-70° C,35%-85%RH

(Operation Temperature)
- 储存环境:

-40° C-80° C,35%-85%RH

(Storage Temperature)
- 功能选择:

IPX6 / PWM / FG& RD / Thermal control /

(Available Features)

Autoresart / Slow starup



技术参数 / TECHNICAL DATA

型号 Model	Bearing System 轴承		Rated Voltage 额定电压	Operation Voltage 安规电压	Rated Current 额定电流	Rated Speed 额定速度	Air Flow 风量	Air Pressure 风压	Noise Level 噪音	Weight 重量
	Ball	Sleeve	VDC	VDC	A	RPM	CFM	mmH ₂ O	dBA	g
ZN9225-DC5HB(S)PPL(T)	•	•	5	3.5-5.5	0.40	2800	55.5	2.7	35	84
ZN9225-DC5MB(S)PPL(T)	•	•			0.28	2500	49.6	2.4	32	
ZN9225-DC5LB(S)PPL(T)	•	•			0.22	2000	39.2	1.9	27	
ZN9225-DC12HB(S)PPL(T)	•	•	12	6.0-13.8	0.50	3800	74.0	6.2	42	84
ZN9225-DC12MB(S)PPL(T)	•	•			0.28	3000	59.6	3.5	36	
ZN9225-DC12LB(S)PPL(T)	•	•			0.15	2000	39.2	1.9	27	
ZN9225-DC24HB(S)PPL(T)	•	•	24	12.0-27.6	0.30	3800	74.0	6.2	42	84
ZN9225-DC24MB(S)PPL(T)	•	•			0.20	3000	59.6	3.5	36	
ZN9225-DC24LB(S)PPL(T)	•	•			0.10	2000	39.2	1.9	27	
ZN9225-DC48HB(S)PPL(T)	•	•	48	24.0-55.2	0.18	3800	74.0	6.2	42	84
ZN9225-DC48MB(S)PPL(T)	•	•			0.12	3000	59.6	3.5	36	
ZN9225-DC48LB(S)PPL(T)	•	•			0.10	2000	39.2	1.9	27	

外观尺寸 / DIMENSIONS DRAWING

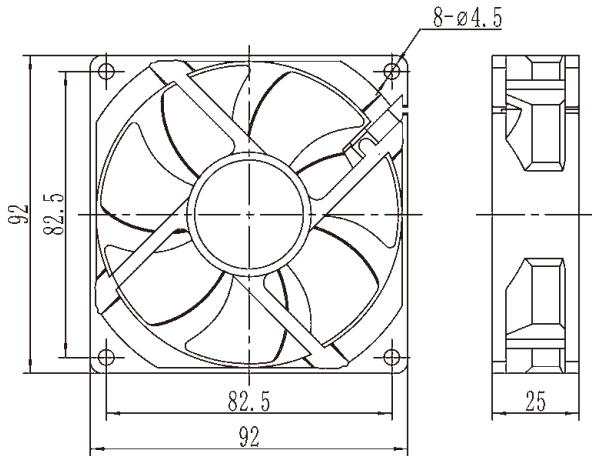

曲线 / P&Q CURVE(AT RATED VOLTAGE)

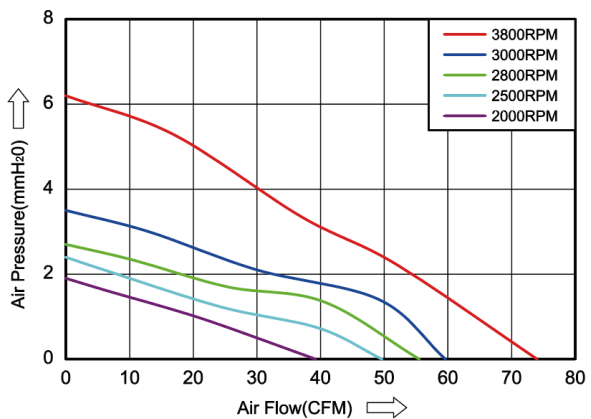

通用规范 / GENERAL SPECIFICATIONS

- 绝缘等级:

Class B

(Insulation)
- 材质:

Impeller & Frame: Plastic

(Material)
- 线材:

UL Type

(Lead Wire)
- 工作模式:

S1

(Mode of operation)
- 工作环境:

-10° C-70° C,35%-85%RH

(Operation Temperature)
- 储存环境:

-40° C-80° C,35%-85%RH

(Storage Temperature)
- 功能选择:

IPX6 / PWM / FG& RD / Thermal control /

(Available Features)

Autoresart / Slow startup



技术参数 / TECHNICAL DATA

型号 Model	Bearing System 轴承		Rated Voltage 额定电压	Operation Voltage 安规电压	Rated Current 额定电流	Rated Speed 额定速度	Air Flow 风量	Air Pressure 风压	Noise Level 噪音	Weight 重量
	Ball	Sleeve	VDC	VDC	A	RPM	CFM	mmH ₂ O	dBA	g
ZN9238-DC12HB(S)PPL(T)	•		12	6.0-13.8	2.50	6000	138.5	26.4	63	170
ZN9238-DC12MB(S)PPL(T)	•	•			1.00	5000	115.4	18.4	56	
ZN9238-DC12LB(S)PPL(T)	•	•			0.50	4000	115.4	11.7	48	
ZN9238-DC24HB(S)PPL(T)	•		24	12.0-27.6	1.50	6000	92.3	26.4	63	170
ZN9238-DC24MB(S)PPL(T)	•	•			0.75	5000	138.5	18.4	56	
ZN9238-DC24LB(S)PPL(T)	•	•			0.25	4000	115.4	11.7	48	
ZN9238-DC48HB(S)PPL(T)	•		48	24.0-55.2	0.80	6000	138.5	26.4	63	170
ZN9238-DC48MB(S)PPL(T)	•	•			0.30	5000	115.4	18.4	56	
ZN9238-DC48LB(S)PPL(T)	•	•			0.20	4000	92.3	11.7	48	

外观尺寸 / DIMENSIONS DRAWING

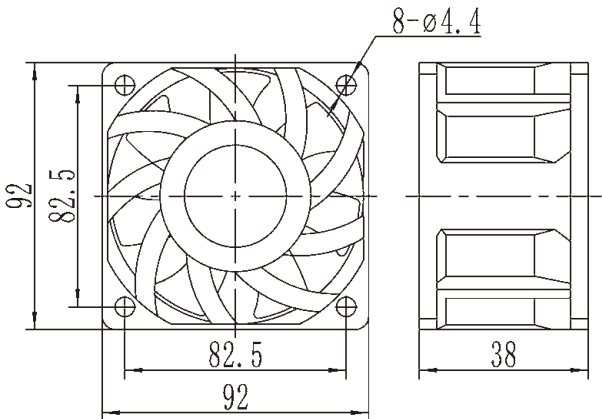

曲线 / P&Q CURVE(AT RATED VOLTAGE)

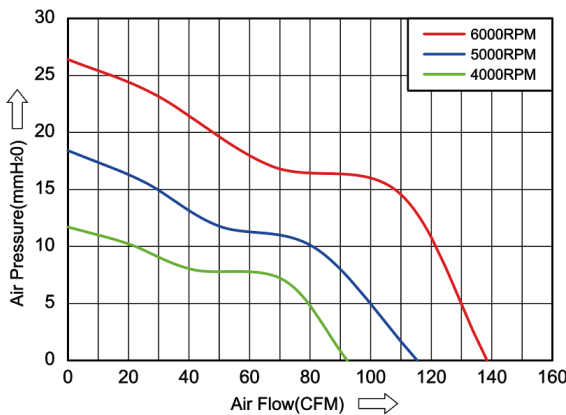

通用规范 / GENERAL SPECIFICATIONS

- 绝缘等级:

Class B

(Insulation)
- 材质:

Impeller & Frame: Plastic

(Material)
- 线材:

UL Type

(Lead Wire)
- 工作模式:

S1

(Mode of operation)
- 工作环境:

-10° C-70° C,35%-85%RH

(Operation Temperature)
- 储存环境:

-40° C-80° C,35%-85%RH

(Storage Temperature)
- 功能选择:

IPX6 / PWM / FG& RD / Thermal control /

(Available Features)

Autoresart / Slow startup



技术参数 / TECHNICAL DATA

型号 Model	Bearing System 轴承		Rated Voltage 额定电压	Operation Voltage 安规电压	Rated Current 额定电流	Rated Speed 额定速度	Air Flow 风量	Air Pressure 风压	Noise Level 噪音	Weight 重量
	Ball	Sleeve	VDC	VDC	A	RPM	CFM	mmH ₂ O	dBA	g
ZN12025-DC12HB(S)PPL(T)	•	•	12	6.0-13.8	0.80	3800	135.5	10.2	49	140
ZN12025-DC12MB(S)PPL(T)	•	•			0.50	3000	108.8	6.4	44	
ZN12025-DC12LB(S)PPL(T)	•	•			0.30	2200	79.0	3.5	36	
ZN12025-DC24HB(S)PPL(T)	•	•	24	12.0-27.6	0.45	3800	135.5	10.2	49	140
ZN12025-DC24MB(S)PPL(T)	•	•			0.35	3000	108.8	6.4	44	
ZN12025-DC24LB(S)PPL(T)	•	•			0.22	2200	79.0	3.5	36	
ZN12025-DC48HB(S)PPL(T)	•	•	48	24.0-55.2	0.30	3800	135.5	10.2	49	140
ZN12025-DC48MB(S)PPL(T)	•	•			0.25	3000	108.8	6.4	44	
ZN12025-DC48LB(S)PPL(T)	•	•			0.15	2200	79.0	3.5	36	

外观尺寸 / DIMENSIONS DRAWING

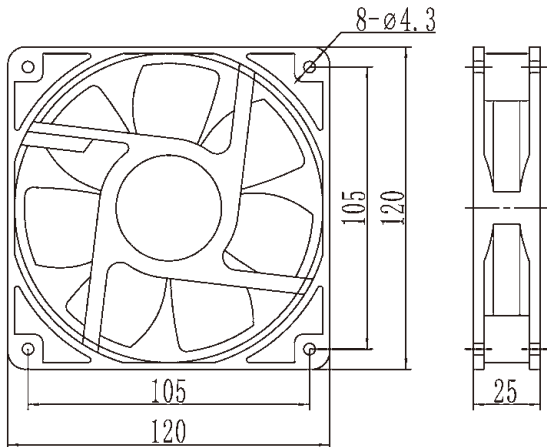

曲线 / P&Q CURVE(AT RATED VOLTAGE)

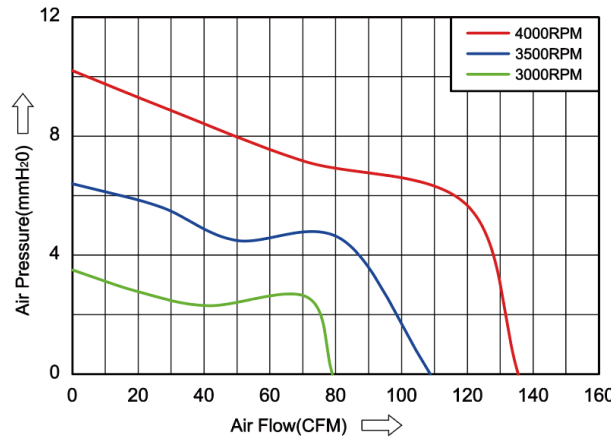

通用规范 / GENERAL SPECIFICATIONS

- 绝缘等级:

Class B

(Insuation)
- 材质:

Impeller: Plastic; Frame:Aluminum Alloy

(Material)
- 线材:

UL Type

(Lead Wire)
- 工作模式:

S1

(Mode ofoperation)
- 工作环境:

-10° C-70° C,35%-85%RH

(Operation Temperature)
- 储存环境:

-40° C-80° C,35%-85%RH

(Storage Temperature)
- 功能选择:

IPX6 / PWM / FG& RD / Thermal control /

(Available Features)

Autoresart / Slow starup



技术参数 / TECHNICAL DATA

型号 Model	Bearing System 轴承		Rated Voltage 额定电压	Operation Voltage 安规电压	Rated Current 额定电流	Rated Speed 额定速度	Air Flow 风量	Air Pressure 风压	Noise Level 噪音	Weight 重量
	Ball	Sleeve	VDC	VDC	A	RPM	CFM	mmH ₂ O	dBA	g
ZN12038-DC12HB(S)APL(T)	•		12	6.0-13.8	1.30	3800	160.0	14.3	51	270
ZN12038-DC12MB(S)APL(T)	•	•			0.60	3000	120.6	7.5	43	
ZN12038-DC12LB(S)APL(T)	•	•			0.30	2000	80.5	4.3	34	
ZN12038-DC24HB(S)APL(T)	•		24	12.0-27.6	0.60	3800	160.0	14.3	51	270
ZN12038-DC24MB(S)APL(T)	•	•			0.35	3000	120.6	7.5	43	
ZN12038-DC24LB(S)APL(T)	•	•			0.20	2000	80.5	4.3	34	
ZN12038-DC48HB(S)APL(T)	•		48	24.0-55.2	0.35	3800	160.0	14.3	51	270
ZN12038-DC48MB(S)APL(T)	•	•			0.22	3000	120.6	7.5	43	
ZN12038-DC48LB(S)APL(T)	•	•			0.12	2000	80.5	4.3	34	

外观尺寸 / DIMENSIONS DRAWING

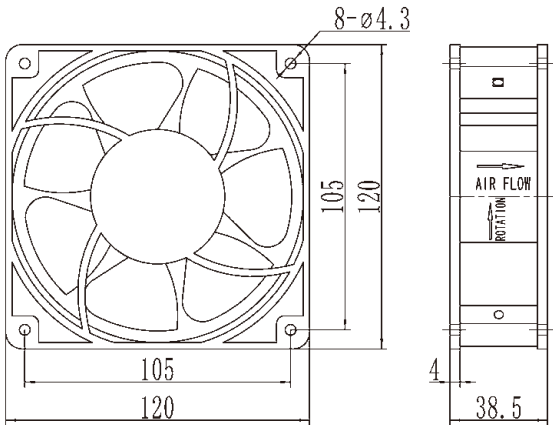

曲线 / P&Q CURVE(AT RATED VOLTAGE)

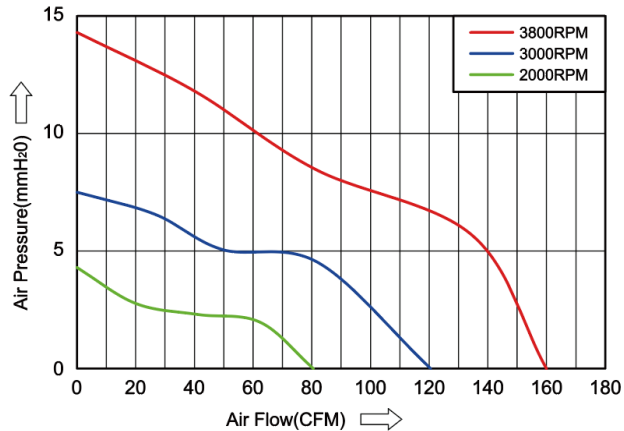

通用规范 / GENERAL SPECIFICATIONS

- 绝缘等级:

Class B

(Insuation)
- 材质:

Impeller & Frame: Plastic

(Material)
- 线材:

UL Type

(Lead Wire)
- 工作模式:

S1

(Mode ofoperation)
- 工作环境:

-10° C-70° C,35%-85%RH

(Operation Temperature)
- 储存环境:

-40° C-80° C,35%-85%RH

(Storage Temperature)
- 功能选择:

IPX6 / PWM / FG& RD / Thermal control /

(Available Features)

Autoresart / Slow starup



技术参数 / TECHNICAL DATA

型号 Model	Bearing System 轴承		Rated Voltage 额定电压	Operation Voltage 安规电压	Rated Current 额定电流	Rated Speed 额定速度	Air Flow 风量	Air Pressure 风压	Noise Level 噪音	Weight 重量
	Ball	Sleeve	VDC	VDC	A	RPM	CFM	mmH ₂ O	dBA	g
ZN12038-DC12HB(S)PPL(T)	•		12	7.0-13.8	3.3	4500	215.2	28.0	62	350
ZN12038-DC12MB(S)PPL(T)	•	•			2.0	4000	188.5	21.5	58	
ZN12038-DC12LB(S)PPL(T)	•	•			1.5	3000	140.1	12.0	52	
ZN12038-DC24DB(S)PPL(T)	•		24	15.0-27.6	1.5	5500	260.5	42.0	68	350
ZN12038-DC24HB(S)PPL(T)	•				1.3	4500	215.2	28.0	62	
ZN12038-DC24MB(S)PPL(T)	•	•			1.1	4000	188.5	21.5	58	
ZN12038-DC24LB(S)PPL(T)	•	•	48	28.0-55.2	0.6	3000	140.1	12.0	52	350
ZN12038-DC48DB(S)PPL(T)	•				1.2	5500	260.5	42.0	68	
ZN12038-DC48HB(S)PPL(T)	•				0.9	4500	215.2	28.0	62	
ZN12038-DC48MB(S)PPL(T)	•	•			0.6	4000	188.5	21.5	58	
ZN12038-DC48LB(S)PPL(T)	•	•			0.4	3000	140.1	12.0	52	

外观尺寸 / DIMENSIONS DRAWING

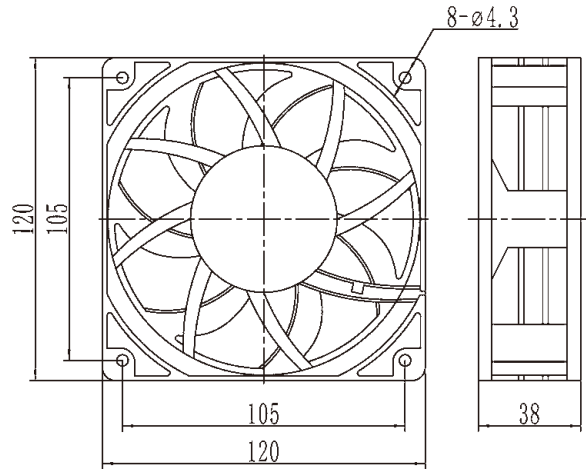

曲线 / P&Q CURVE(AT RATED VOLTAGE)

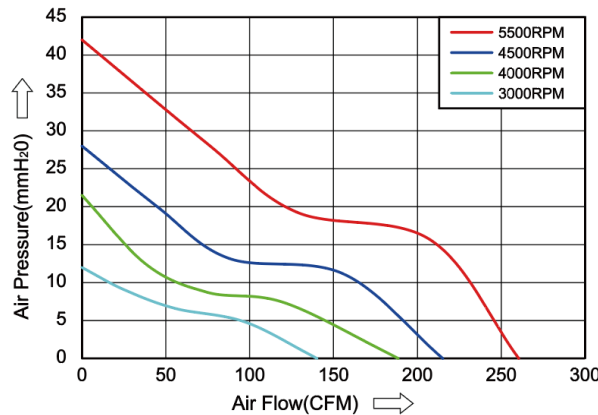

通用规范 / GENERAL SPECIFICATIONS

- 绝缘等级:

(Insuation)
- Class B
- 材质:

(Material)
- Impeller: Plastic; Frame:Aluminum Alloy
- 线材:

(Lead Wire)
- UL Type
- 工作模式:

(Mode ofoperation)
- S1
- 工作环境:

(Operation Temperature)
- 10° C-70° C,35%-85%RH
- 储存环境:

(Storage Temperature)
- 40° C-80° C,35%-85%RH
- 功能选择:

(Available Features)
- IPX6 / PWM / FG& RD / Thermal control /
- Autoresart / Slow startup



技术参数 / TECHNICAL DATA

型号 Model	Bearing System 轴承		Rated Voltage 额定电压	Operation Voltage 安规电压	Rated Current 额定电流	Rated Speed 额定速度	Air Flow 风量	Air Pressure 风压	Noise Level 噪音	Weight 重量
	Ball	Sleeve	VDC	VDC	A	RPM	CFM	mmH ₂ O	dBA	g
ZN15050-DC12DB(S)APL(T)	•		12	7.0-13.8	3.0	4500	303.8	35.2	64	750
ZN15050-DC12HB(S)APL(T)	•				2.5	4000	265.6	28.0	61	
ZN15050-DC12MB(S)APL(T)	•				1.5	3000	208.2	19.4	51	
ZN15050-DC12LB(S)APL(T)	•				1.0	2500	173.2	13.9	44	
ZN15050-DC24DB(S)APL(T)	•		24	15.0-27.6	2.4	5000	338.8	41.0	67	750
ZN15050-DC24HB(S)APL(T)	•				2.0	4500	303.8	35.2	64	
ZN15050-DC24MB(S)APL(T)	•				1.5	4000	265.6	28.0	61	
ZN15050-DC24LB(S)APL(T)	•				0.6	3000	208.2	19.4	51	
ZN15050-DC48DB(S)APL(T)	•		48	24.0-55.2	1.5	5000	338.8	41.0	67	750
ZN15050-DC48HB(S)APL(T)	•				1.0	4500	303.8	35.2	64	
ZN15050-DC48MB(S)APL(T)	•				0.75	4000	265.6	28.0	61	
ZN15050-DC48LB(S)APL(T)	•				0.4	3000	208.2	19.4	51	

外观尺寸 / DIMENSIONS DRAWING

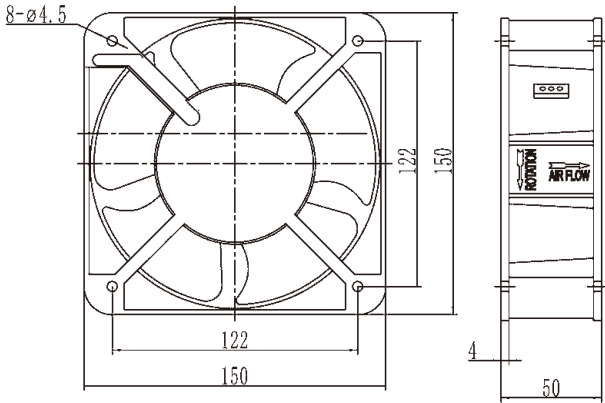

曲线 / P&Q CURVE(AT RATED VOLTAGE)

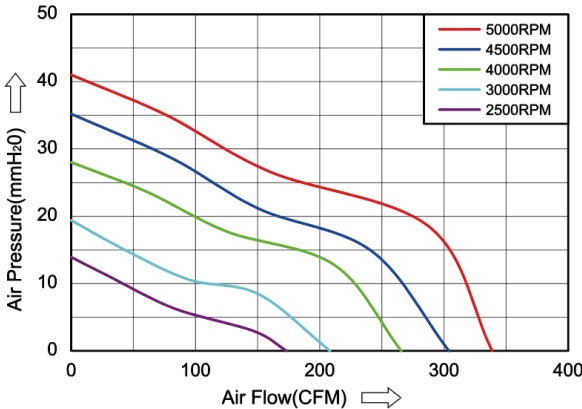

通用规范 / GENERAL SPECIFICATIONS

- 绝缘等级:

(Insuation)
- Class B
- 材质:

(Material)
- Impeller: Plastic; Frame:Aluminum Alloy
- 线材:

(Lead Wire)
- UL Type
- 工作模式:

(Mode ofoperation)
- S1
- 工作环境:

(Operation Temperature)
- 10° C-70° C,35%-85%RH
- 储存环境:

(Storage Temperature)
- 40° C-80° C,35%-85%RH
- 功能选择:

(Available Features)
- IPX6 / PWM / FG& RD / Thermal control /
- Autoresart / Slow startup



技术参数 / TECHNICAL DATA

型号 Model	Bearing System 轴承		Rated Voltage 额定电压	Operation Voltage 安规电压	Rated Current 额定电流	Rated Speed 额定速度	Air Flow 风量	Air Pressure 风压	Noise Level 噪音	Weight 重量
	Ball	Sleeve	VDC	VDC	A	RPM	CFM	mmH ₂ O	dBA	g
ZN17251-DC12DB(S)APL(T)	•		12	7.0-13.8	3.0	4500	306.8	38.1	64	750
ZN17251-DC12HB(S)APL(T)	•				2.5	4000	272.6	30.8	61	
ZN17251-DC12MB(S)APL(T)	•				1.5	3000	211.5	20.0	51	
ZN17251-DC12LB(S)APL(T)	•				1.0	2500	176.2	13.9	44	
ZN17251-DC24DB(S)APL(T)	•		24	15.0-27.6	2.4	5000	340.8	45.0	68	750
ZN17251-DC24HB(S)APL(T)	•				2.0	4500	306.8	38.1	64	
ZN17251-DC24MB(S)APL(T)	•				1.5	4000	272.6	30.8	61	
ZN17251-DC24LB(S)APL(T)	•				0.6	3000	211.5	20.0	51	
ZN17251-DC48DB(S)APL(T)	•		48	24.0-55.2	1.5	5000	340.8	45.0	68	750
ZN17251-DC48HB(S)APL(T)	•				1.0	4500	306.8	38.1	64	
ZN17251-DC48MB(S)APL(T)	•				0.75	4000	272.6	30.8	61	
ZN17251-DC48LB(S)APL(T)	•				0.4	3000	211.5	20.0	51	

外观尺寸 / DIMENSIONS DRAWING

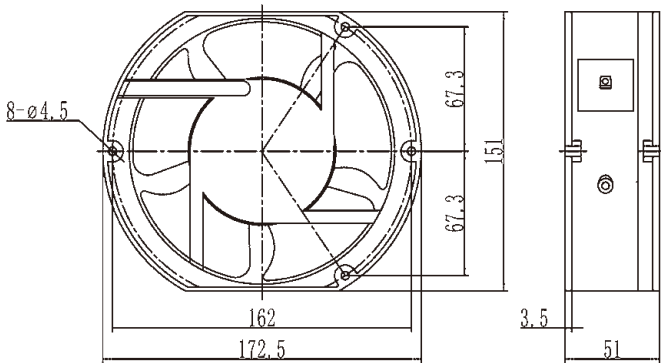

曲线 / P&Q CURVE(AT RATED VOLTAGE)

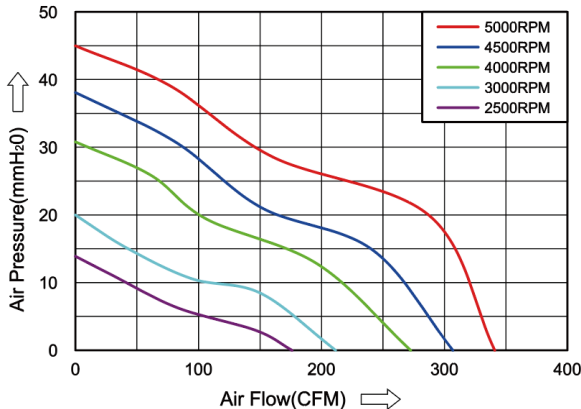

通用规范 / GENERAL SPECIFICATIONS

- 绝缘等级:

Class B

(Insuation)
- 材质:

Impeller: Plastic; Frame:Aluminum Alloy

(Material)
- 线材:

UL Type

(Lead Wire)
- 工作模式:

S1

(Mode ofoperation)
- 工作环境:

-10° C-70° C,35%-85%RH

(Operation Temperature)
- 储存环境:

-40° C-80° C,35%-85%RH

(Storage Temperature)
- 功能选择:

IPX6 / PWM / FG& RD / Thermal control /

(Available Features)

Autoresart / Slow startup



技术参数 / TECHNICAL DATA

型号 Model	Bearing System 轴承		Rated Voltage 额定电压	Operation Voltage 安规电压	Rated Current 额定电流	Rated Speed 额定速度	Air Flow 风量	Air Pressure 风压	Noise Level 噪音	Weight 重量
	Ball	Sleeve	VDC	VDC	A	RPM	CFM	mmH ₂ O	dBA	g
ZN20060-DC12HB(S)APL(T)	•		12	7.0-13.8	3.5	3000	640	24.6	68	1032
ZN20060-DC12MB(S)APL(T)	•				2.8	2500	532	18.8	58	
ZN20060-DC12LB(S)APL(T)	•				2.0	2000	490	15.5	50	
ZN20060-DC24HB(S)APL(T)	•		24	15.0-27.6	2.0	3000	640	24.6	68	1032
ZN20060-DC24MB(S)APL(T)	•				1.5	2500	532	18.8	58	
ZN20060-DC24LB(S)APL(T)	•				1.0	2000	490	15.5	50	
ZN20060-DC48HB(S)APL(T)	•		48	24.0-55.2	1.2	3000	640	24.6	68	1032
ZN20060-DC48MB(S)APL(T)	•				0.8	2500	532	18.8	58	
ZN20060-DC48LB(S)APL(T)	•				0.5	2000	490	15.5	50	

外观尺寸 / DIMENSIONS DRAWING

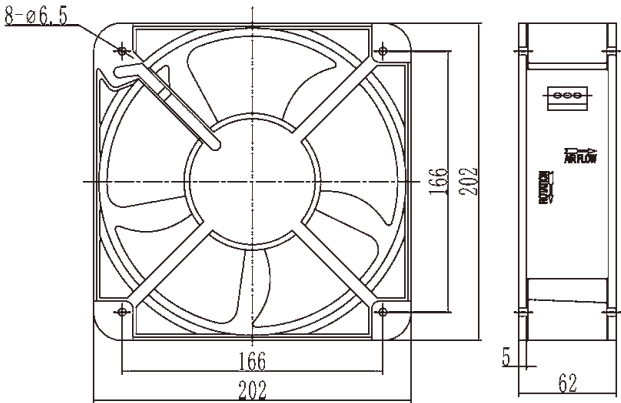

曲线 / P&Q CURVE(AT RATED VOLTAGE)

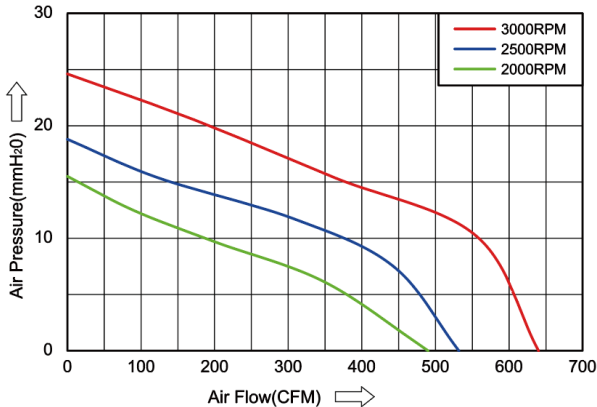

通用规范 / GENERAL SPECIFICATIONS

- 绝缘等级:

Class B

(Insuation)
- 材质:

Impeller: Plastic; Frame:Aluminum Alloy

(Material)
- 线材:

UL Type

(Lead Wire)
- 工作模式:

S1

(Mode ofoperation)
- 工作环境:

-10° C-70° C,35%-85%RH

(Operation Temperature)
- 储存环境:

-40° C-80° C,35%-85%RH

(Storage Temperature)
- 功能选择:

IPX6 / PWM / FG& RD / Thermal control /

(Available Features)

Autoresart / Slow startup



技术参数 / TECHNICAL DATA

型号 Model	Bearing System 轴承		Rated Voltage 额定电压	Operation Voltage 安规电压	Rated Current 额定电流	Rated Speed 额定速度	Air Flow 风量	Air Pressure 风压	Noise Level 噪音	Weight 重量
	Ball	Sleeve	VDC	VDC	A	RPM	CFM	mmH ₂ O	dBA	g
ZN22060-DC12HB(S)APL(T)	•		12	7.0-13.8	3.5	3000	640	24.6	68	1350
ZN22060-DC12MB(S)APL(T)	•				2.8	2500	532	18.8	58	
ZN22060-DC12LB(S)APL(T)	•				2.0	2000	490	15.5	50	
ZN22060-DC24HB(S)APL(T)	•		24	15.0-27.6	2.0	3000	640	24.6	68	1350
ZN22060-DC24MB(S)APL(T)	•				1.5	2500	532	18.8	58	
ZN22060-DC24LB(S)APL(T)	•				1.0	2000	490	15.5	50	
ZN22060-DC48HB(S)APL(T)	•		48	24.0-55.2	1.2	3000	640	24.6	68	1350
ZN22060-DC48MB(S)APL(T)	•				0.8	2500	532	18.8	58	
ZN22060-DC48LB(S)APL(T)	•				0.5	2000	490	15.5	50	

外观尺寸 / DIMENSIONS DRAWING

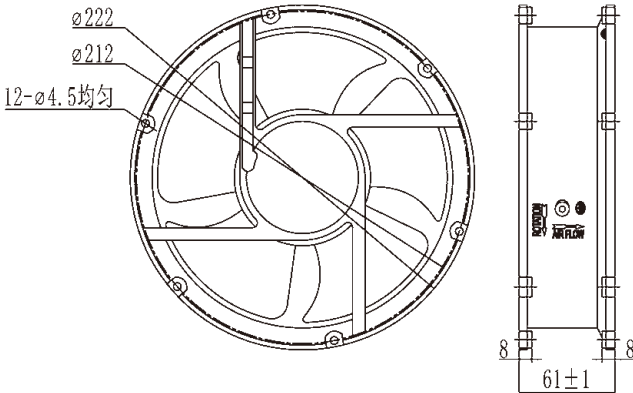

曲线 / P&Q CURVE(AT RATED VOLTAGE)

